

| REV | DESCRIPTION | DATE | APPR |
|-----|-------------|------|------|
| | | | |
| | | | |
| | | | |

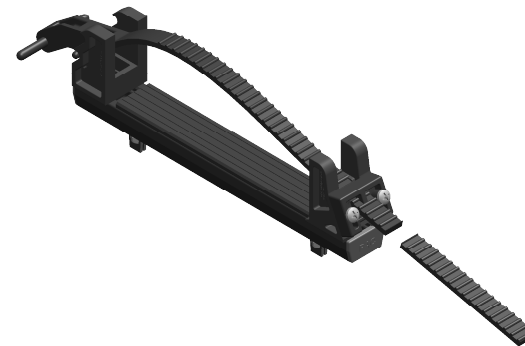
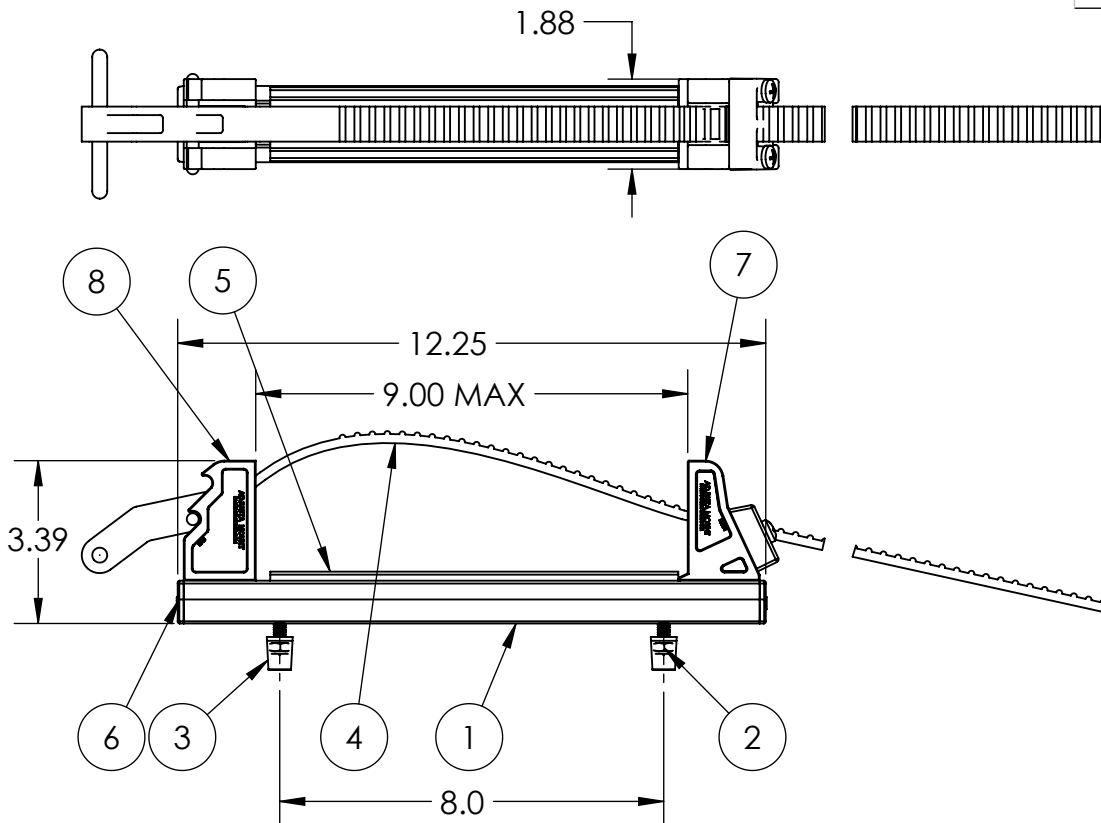

| 8 | 1006-908 | ADJ LOCK END ASSEMBLY | 1 | A |
|----------|----------|------------------------------|------|-----|
| 7 | 1006-907 | ADJ CLAMP END ASSEMBLY | 1 | A |
| 6 | 2019EC | END CAP PAC STRUT | 2 | |
| 5 | 1006-3 | CHANNEL CUSHION | 1 | |
| 4 | 2008-1 | LOCK STRAP | 1 | |
| 3 | 7029 | FASTENER KIT-ADJUSTAMOUNT PT | 1 | |
| 2 | 2035 | FASTENER PACK | 1 | |
| 1 | 2019-B | PAC STRUT BLACK X 12" | 1 | |
| ITEM NO. | PAC P/N | PART NAME | QTY. | REV |

NOTES:

**PERFORMANCE
ADVANTAGE
COMPANY**



TOLERANCES UNLESS OTHERWISE SPECIFIED

.X= ±.03
.XX= ±.010
.XXX= ±.005
.XXXX= ±0.0005
ANGLES ±0.5 °
FRACTIONAL ±1/64

THIRD ANGLE PROJECTION



COLOR

| | NAME | DATE |
|---------------|------|------|
| DRAWN BY | | |
| APPR. BY | | |
| MFG BY | | |
| MFG. P/N | | |
| ENG APPR. | | |
| MATERIAL | | |
| ALT. MATERIAL | | |
| FINISH | | |

THE INFORMATION CONTAINED IN THIS DRAWING IS THE SOLE PROPERTY OF **PERFORMANCE ADVANTAGE CO.** ANY REPRODUCTION IN PART OR AS A WHOLE WITHOUT THE WRITTEN PERMISSION OF PERFORMANCE ADVANTAGE CO. IS PROHIBITED.

TITLE:

**TACTICAL
ADJUSTAMOUNT KIT**

PART NUMBER

LE 5006

REV

SCALE: 1:4

SHEET 1 OF 1