

CERTIFICATE OF COMPLIANCE

This is to certify that the **CLYINDERMATES** as pictured is manufactured to the same specifications as duplicate units proven to be in full compliance with the requirements of all editions of the NFPA 1901 (14.1.11.2). A copy of the test summary is on the reverse side of this certificate.

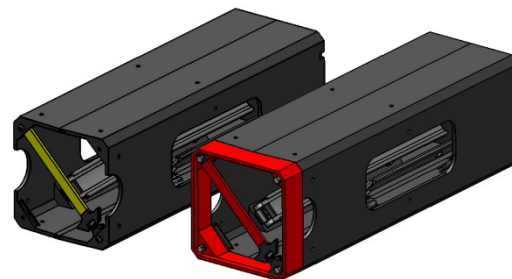

P/N CM6000 P/N CM6060
CYLINDERMATES



PERFORMANCE ADVANTAGE COMPANY
10 CENTRAL AVE., LANCASTER, NEW YORK 14086
www.pactoolmounts.com

On the date of 8/23/2017, MGA Research Corporation conducted extensive testing using the latest scientific equipment and procedures and documented complete compliance with all listed 1901 requirements.

James P. Gonzalez
Certified



mga research corporation

1.0 TEST SUMMARY

Test Conducted and Completion Date: August 23rd, 2017

Test Conducted For: Performance Advantage Company (PAC)

MGA File Number: C17T1-095 (see full report)

Test Specifications: Mechanical Shock
Per customer specifications

2.0 PROGRAM

2.1 Shock Testing

2.1.1 Test Requirements

As per customer request and NFPA 1901 (section 14.1.11.2)

2.1.2 Test Procedure

Three (3) 30-minute and three (3) 60-minute SCBA cylinders were fastened to an electrodynamic shaker with a fixture provided by Performance Advantage Company. The units were subjected half-sine shock pulses of a peak acceleration of 10g, with a duration of 11 milliseconds. The units then received three (3) full-strength shocks each in the negative Z-axis and positive Y-axis for a total of 6 full strength shocks per unit.

2.1.3 Test Results

There was no damage as a result of testing and the bracket remained tight for the full duration of testing.

3.0 TEST EQUIPMENT LIST

Item	Description	Manufacturer	Model No.	Serial No.	Cal Date	Date Due	MGA Ref
1	Electrodynamic Shaker	Unholtz-Dickie	T1002	264	UWCE	N/A	24.04-04
2	Vibration Controller	Crystal Instruments	Spider-81	1011072	3/20/17	3/20/18	24.03-01
3	Accelerometer	PCB	J352C34	34644	1/30/17	1/30/18	02.07-70

UWCE - Used With Calibrated Equipment