



CHANNEL CUSHION

P/N 1006-3 (8-1/2") ☐
P/N 8006 (VAR) ☐

INSTALLATION INSTRUCTIONS

For additional assistance call 888-514-0083 between 8AM-5PM EST or email: info@pactoolmounts.com

CAUTION

To avoid the risk of personal injury, property damage or product damage, please follow installation instructions.

- * Channel Cushion is compatible with PAC TRAC aluminum products **P/N 7020, P/N 7040, P/N 7050** and **P/N 2019** (Pac Strut).
- * Channel Cushion is also compatible with Uni-Strut **P1000 & P4000** (1-5/8") wide profiles.
- * PAC recommends regular and frequent inspections to be certain of proper operation and installation.

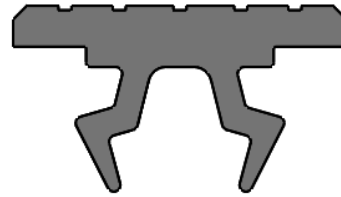

To insert channel cushion, center over strut or extrusion and press in. Lubricate with a soap & water solution underside of channel cushion to assist in assembly.

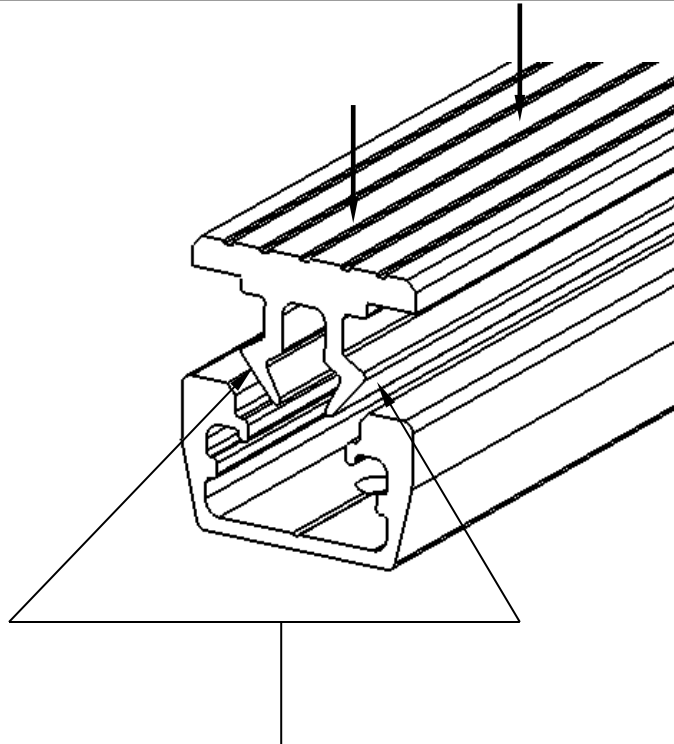

APPLY SOAP AND WATER SOLUTION TO THESE AREAS TO FACILITATE INSTALLATION!