

PERFORMANCE ADVANTAGE COMPANY



SERVING FIRE SERVICE
PROFESSIONALS
FOR OVER 20 YEARS

TOOL MOUNTING
SPECIALISTS SERVING
INDUSTRIES WORLDWIDE



2015 Catalog Update:
Scan QR codes for PAC
product instructions!



www.pactoolmounts.com

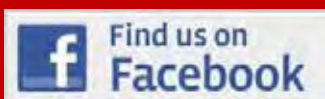

2015 FIRE & EMS INDUSTRY CATALOG

Fire & Rescue - Law Enforcement - Military - EMS - Utility - Towing



PERFORMANCE ADVANTAGE CO.

NEW PRODUCT ANNOUNCEMENT

The Heavy Rescue Tool Mounting Kit supports, locates and secures most all rescue tools including Cutters, Spreaders and Combi tools. Kits pair our new 1035 Pocket with either of our K5020 Fast Lok or 1070 Jumbo Lok brackets so your tools can be mounted vertically, horizontally or angled.



Features:

- § Heavy duty construction
- § Multiple mounting positions
- § Mounts most Spreaders, Cutters and Combi tools
- § AVAILABLE IN THE FOLLOWING VERSIONS:

§ P/N 1035

- Pocket Only

§ Kit P/N K5035FL

- (1035 w/ K5020 Fastlok)

§ Kit P/N K5035JL

- (1035 w/ 1070 Jumbolok)



Contact Tom Trzepacz at PAC:

tom@pactoolmounts.com

888-514-0083

Fire & Rescue - Law Enforcement - Military - EMS - Utility - Towing



PERFORMANCE ADVANTAGE CO.

TOOL MOUNTING SOLUTIONS WORLDWIDE

Company Overview

Performance Advantage Company (PAC), established in 1992, is a privately owned company which manufactures and markets high quality tool mounting brackets. PAC's primary market is the Fire Industry providing specialty tool mounting solutions for fire apparatus. Other markets include the Military, Law Enforcement, EMS, Utilities and Homeland Security.

Performance Advantage Company is located in Lancaster, NY, a suburb of Buffalo and sells its products direct or through a worldwide network of dealers.

Products

The products PAC offers are designed to mount life-saving tools safely and securely. Versatile and flexible mounting options provide the most efficient and accessible solutions for tools and equipment. Whether new or in-service vehicles, PAC products can be customized for individual needs and requirements.

PAC utilizes the best possible materials and manufacturing methods which result in long lasting service. PAC products are tested to the highest standards and are compliant with **National Fire Protection Association (NFPA) 1901** standards and **MIL-S901D** military shock specifications.

If any PAC product fails under normal use it is replaced, free of charge.

Service

Performance Advantage Company is proud to provide the best possible customer service. PAC maintains a large inventory to ensure that most orders are fulfilled quickly. Knowledgeable sales, engineering and technical support, installation and training representatives are available to assist customers with their needs.

Contact

Performance Advantage Company
10 Central Avenue
Lancaster, NY 14086
Tel: (716) 683-7413
Fax: (716) 683-6578
Toll Free: 1-888-514-0083
Fax Toll Free: 1-877-741-9206

Email: info@pactoolmounts.com

Web: www.pactoolmounts.com



Fire & Rescue - Law Enforcement - Military - EMS - Utility - Towing



PERFORMANCE ADVANTAGE CO.

OUR COMMITMENT TO THE TEAM APPROACH INCLUDES YOU,
OUR NUMBER ONE PRIORITY.



Dick Young
dick@pactoolmounts.com
PAC Founder



Jim Everett
jim@pactoolmounts.com
PAC President & VP Marketing

We take pride in being your first choice for proper, safe and efficient tool mounting.



Greg Young
greg@pactoolmounts.com
VP Sales & Operations



Mike McGuire
mike@pactoolmounts.com
Sales & Technical Support
L.E. & Military Specialist



Tom Trzepacz
tom@pactoolmounts.com
Fire Industry Sales & Training
Industrial & Towing Specialist



Dean Mayhew
dean@pactoolmounts.com
SW Sales & Technical Support



Jared Enser
jared@pactoolmounts.com
Sales & Technical Support
International Sales Specialist



Barb Kozurkiewicz
barb@pactoolmounts.com
Accounting Manager



Jerry Enser
jerry@pactoolmounts.com
Shop Supervisor



Jim Gonzalez
jgonzalez@pactoolmounts.com
Engineering Manager



Dawn Aldinger
dawn@pactoolmounts.com
Admin. Asst. / Accts. Receivable



Tammy Piasecki
tammy@pactoolmounts.com
Order Processing



Dick Aldinger
Production / Product Assembly



Tom Janiszkeski
Metal Fabrication



Diane Lehnis
Production / Product Assembly



Dan Snyder
Shop Technician

PAC WARRANTY

**IF ANY PART FAILS UNDER NORMAL SERVICE...
IT WILL BE REPLACED – NO CHARGE – PERIOD.**

**EXCEPT FOR THE PAC WARRANTY, WE DISCLAIM LIABILITY FOR
INCIDENTAL AND CONSEQUENTIAL DAMAGES FOR BREACH OF ANY EXPRESS
OR IMPLIED WARRANTY. WE DISCLAIM ANY WARRANTIES OF
MERCHANTABILITY OR FITNESS FOR A PARTICULAR PURPOSE.**



Joe Janiszkeski
Shop Technician



PERFORMANCE ADVANTAGE CO.

CATALOG INDEX

Positive and Friction Locking Brackets

(section A)

Handlelok	P/N 1004	p. A-1
Toolok	P/N 1003	p. A-2
Hooklok	P/N 1001	p. A-2
Jumbo Lok	P/N 1070	p. A-3
Adjustamount	P/N 1006	p. A-4
Extended Adjustamount	P/N 1008	p. A-4
Super Adjustamount	P/N 1050	p. A-5
Extended Super Adjustamount	P/N 1060	p. A-5
Stow-N-Lok (Tall version)	P/N 1005	p. A-7
Stow-N-Lok (Short version)	P/N 1005S	p. A-7
Flexmount (Tall version)	P/N 1002	p. A-8
Flexmount (Short version)	P/N 1002-2	p. A-8

Hangers, Hooks and Stabilizing Brackets

(section B)

Tool Hanger	P/N 1009	p. B-1
Flathead Axe Hanger	P/N 1011	p. B-2
Pickhead Axe Hanger	P/N 1012	p. B-2
Sledge Pocket (8 – 10#)	P/N 1010	p. B-3
Sledge Pocket (10 – 12#)	P/N 1010-12	p. B-3
Universal Hanger	P/N 1019	p. B-4
GM Hook	P/N 1028	p. B-4
Hookmount	P/N 1029	p. B-5
Loop Hook	P/N 1027	p. B-5
Universal Mount	P/N 1007	p. B-6
Cup Mount	P/N 1033	p. B-6

Tool Specific Brackets

(section C)

Ironslok	P/N K5003	p. C-1
Halligan Tool Mount	P/N K5032	p. C-2
Storz 4" Mount	P/N 1040-4	p. C-3
Storz 5" Mount	P/N 1040-5	p. C-3
Storz 6" Mount	P/N 1040-6	p. C-3
Adapter Lok 1-1/2"	P/N 1042-1	p. C-4
Adapter Lok 2-1/2"	P/N 1042-2	p. C-4
Dual Adapter Lok 2-1/2"	P/N 1042-D	p. C-5
Spanner Wrench Mount	P/N 1016	p. C-6
Hydrant Wrench Mount	P/N 1017	p. C-6

Bracket Kits

(section D)

Stow-N-Lok Kits	P/N K5005	p. D-1
Adjustamount Kit	P/N K5006	p. D-2
Extended Adjustamount Kit	P/N K5008	p. D-2
Super Adjustamount Kit	P/N K5050	p. D-3
Extended Super Adjustamount Kit	P/N K5060	p. D-3
Tool Hanger Kits	P/N K5009	p. D-4
Universal Hanger Kit	P/N K5019	p. D-4
Fastlok Adjustamount Kit *NEW	P/N K5020	p. D-5
Sledge (8-10#) Hanger Kit	P/N K5010	p. D-6
Sledge (10-12#) Hanger Kit	P/N K5010-12	p. D-6
Flathead Axe Hanger Kit	P/N K5011	p. D-7
Pickhead Axe Hanger Kit	P/N K5012	p. D-7

Cutters Edge Saw Kit (after '99)	P/N K5025-N	p. D-8
Cutters Edge Saw Kit (pre '99)	P/N K5025-O	p. D-8

Heavy Rescue Tool Mounting Products

(section E)

Hookmount Kit	P/N K5029	p. E-2
Strut Base Mount	P/N 2076	p. E-2
Phoenix Tool Mounting Kit	P/N K5050-1PH	p. E-3
Phoenix Ram Mounting Kit	P/N K5050-2PH	p. E-3
Heavy Rescue Mount	P/N 1035	p. E-4
Heavy Rescue Mt. Kit Fastlok	P/N K5035FL	p. E-5
Heavy Rescue Mt. Kit Jumbo Lok	P/N K5035JL	p. E-5
Spreader Base	P/N 1026	p. E-6
Soft Mount	P/N 1080	p. E-6
Spreader Base Kit	P/N K5026	p. E-9
Soft Mount Kit	P/N K5080	p. E-9
Amkus Universal Base Kit	P/N K5021	p. E-10
Amkus Cutter Kit	P/N K5022	p. E-10
Amkus Ram Kit	P/N K5023	p. E-11
Amkus Spreader Kit	P/N K5024	p. E-11
Frame Saddles	P/N 1013	p. E-12
Extended Frame Saddles	P/N 1013-x	p. E-12

Cylinder Mates and Cylinder Carts

(section F)

Cylinder Mate (30-45 Minute)	P/N CM6000	p. F-2
Cylinder Mate (60 Minute)	P/N CM6060	p. F-2
Cylinder Mate Cart (12 Pack)	ASSORTED	p. F-3
Cylinder Mate Cart (16 Pack)	ASSORTED	p. F-3

Additional Mounting Products & Accessories

(section G)

Adjustamount PT Adapter	P/N 6008	p. G-2
Super Adjustamount Spacer Block	P/N 1006-4	p. G-2
Cylinder Mate Strap	P/N CM-20	p. G-2
UNISTRUT – P4000 Series	P/N 2019	p. G-3
UNISTRUT – P1000 Series	P/N 2020	p. G-3
UNISTRUT Channel Cushion	P/N 1006-3	p. G-3
Pac Trac Right Angle Connector	P/N 3018	p. G-4
Dual Trac Shelf Mount	P/N 3021	p. G-4
Universal Spacer	P/N 3005	p. G-4
Traclok packs	P/N 7002	p. G-5
Channel Nuts (Dual Trac)	ASSORTED	p. G-5
Channel Nuts (Unistrut)	ASSORTED	p. G-5

Aluminum Pac Trac Product

(section P)

See the [PAC TRAC PRODUCTS mini-catalog](#) -
SECTION P - for our full line of Toolboards,
 Swing Outs and more!

PAC offers mounting options for nearly all makes and models of
 Heavy Rescue Equipment. Our line extends beyond our catalog. For
 your specific needs with Hurst, Holmatro etc. please contact us!



PERFORMANCE ADVANTAGE CO.

2015 SHOW SCHEDULE

E.S.T.R.A. TOW SHOW www.estratowshow.com	May 29-31	Great Escape Lodge, Queensbury NY
SOUTH CAROLINA FIRE RESCUE www.firerescuesc.org	June 9-13	Myrtle Beach Convention Center, Myrtle Beach, SC
SFFMA CONFERENCE www.sffma.org	June 12-17	Moody Gardens Convention Center, Galveston, TX
NYSAFC FIRE 2015 www.nysfirechiefs.com	June 18-20	Turning Stone Resort, Verona, NY
POLICE & SECURITY EXPO www.police-security.com	June 23-24	Atlantic City Convention Center, Atlantic City, NJ
NE ASSOC. FIRE CHIEFS CONFERENCE www.nefireexpo.com	June 26-27	Eastern States Exposition, West Springfield, MA
TEEX SPANISH FIRE SCHOOL www.teex.com	July 5	Texas A & M, College Station, TX
TEEX INDUSTRIAL FIRE SCHOOL www.teex.com	July 12	Texas A & M, College Station, TX
TEEX INDUSTRIAL FIRE SCHOOL www.teex.com	July 19	Texas A & M, College Station, TX
EC FIREFIGHTERS CONVENTION	August 7	Erie County Fair, Hamburg, NY
MONROE COUNTY CHIEFS SHOW	August 12	Barnard Exempts Building, Rochester, NY
SOUTH ATLANTIC FIRE RESCUE EXPO www.southatlanticfirerescueexpo.com	August 14 - 15	Raleigh Convention Center, Raleigh NC
FIRE RESCUE INTERNATIONAL (FRI) www.iafc.com	August 28 - 29	Georgia World Congress Center, Atlanta, GA
NJ FIRE CHIEFS CONVENTION www.njchiefs.com	September 18 - 20	Wildwood Convention Center, Wildwood NJ

As of 5/22/15

SHOW SCHEDULE SUBJECT TO CHANGE.

ADDITIONAL SHOWS ARE BEING CONSIDERED. SEE OUR WEBSITE OR CALL 888-514-0083!

**PAC REGULARLY DISPLAYS OUR PRODUCT LINES AT THE TOP INDUSTRY SHOWS!
SOMETIMES WE JUST GO TO SHOWS TO MEET PEOPLE LIKE YOU. PAC PRODUCTS CAN
ALSO BE SEEN AT THE BOOTHS OF OUR DEALERS AND CUSTOMERS.
IF YOU WANT MORE INFORMATION ABOUT SEEING PAC IN PERSON OR BECOMING A
PAC DEALER, PLEASE CALL 888-514-0083!**

Fire & Rescue - Law Enforcement - Military - EMS - Utility - Towing

SECTION A



POSITIVE LOCKING & FRICTION LOCKING BRACKETS

888-514-0083 TOLL FREE

WWW.PACTOOLMOUNTS.COM

PAC

HANDLELOK

P/N 1004

STRAP COLORS (please specify)	BLACK YELLOW ORANGE
MOUNTING HARDWARE (INCLUDED)	FLAT SURFACES PAC TRAC
MOUNTING HARDWARE (OPTIONAL)	DUAL TRAC UNISTRUT 2019 UNISTRUT 2020
PRODUCT WT. DIMENSIONS	0.4 lbs. 3.9" L x 1.8" W x 4.0" H

The Handlelok provides an adjustable positive locking method to secure axes, hammers, bars and many other tools and equipment. The STRETCHLOK strap allows instant release.



- Molded from high quality materials
- Soft textured pad for extra grip.
- Weather, UV resistant
- Non-conductive
- Can be mounted horizontally or vertically



GRIP RANGE:
1/8" to 1-3/4" (3.2mm-44.5mm)

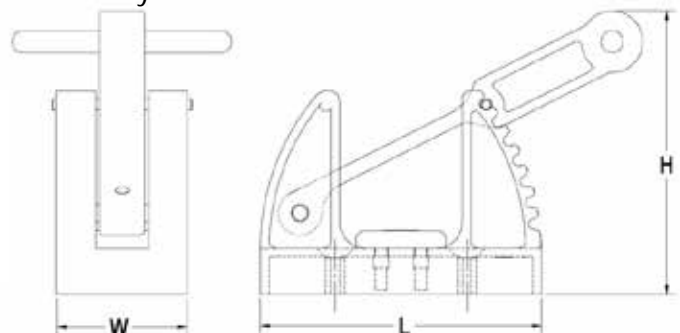

P/N 1003

STRAP COLORS (please specify)	BLACK YELLOW ORANGE
MOUNTING HARDWARE (INCLUDED)	FLAT SURFACES PAC TRAC
MOUNTING HARDWARE (OPTIONAL)	N/A
PRODUCT WT. DIMENSIONS	0.2 lbs. 4.3" L x 1.0" W x 3.0" H

The cost effective Toolok bracket is a versatile and easy to use product providing secure mounting for a wide variety of tools and equipment.



- Rugged injection molded components made from high quality materials
- High performance elastomer GRIPOK is rated to 5400psi
- Weather, UV resistant
- Non-conductive
- Can be mounted horizontally or vertically

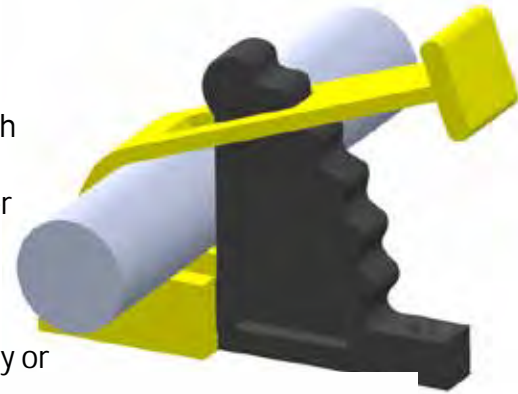

GRIP RANGE:
1/8" to 1-1/2" (3.2mm-38.1mm)

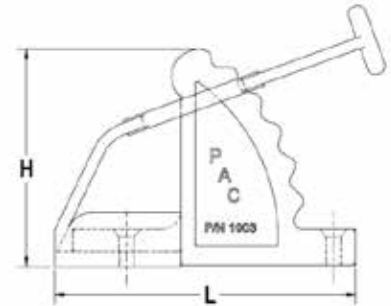

HOOKLOK

P/N 1001

BASE COLOR	BLACK
MOUNTING HARDWARE (INCLUDED)	FLAT SURFACES PAC TRAC
MOUNTING HARDWARE (OPTIONAL)	DUAL TRAC
PRODUCT WT. DIMENSIONS	0.4 lbs. / PAIR 2.3" L x 2.0" W x 2.6" H

SOLD IN PAIRS - The Hooklok bracket is a versatile and easy to use friction lock product providing secure mounting for a wide variety of tools and equipment.

- Hook feature provides additional support when mounted vertically
- Rugged injection molded components made from high quality materials
- Weather, UV resistant
- Non-conductive
- Can be mounted horizontally or vertically

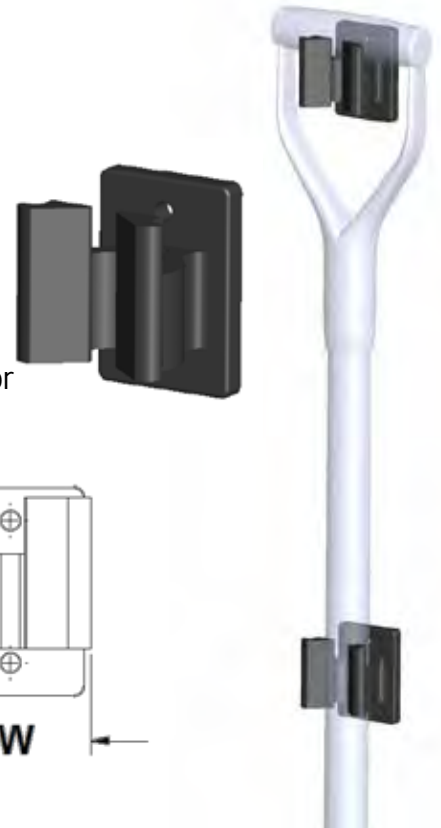

GRIP RANGE:
1" to 1-1/4" (25.4mm-31.8mm)

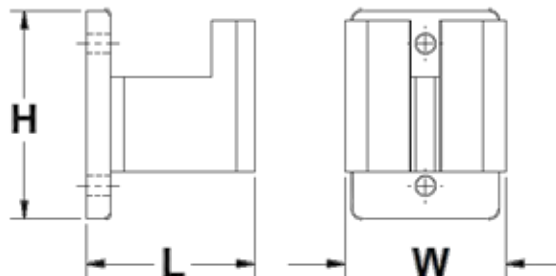

The Jumbo Lok is a large positive locking bracket with **THREE strap pivot positions providing an extensive grip range for a wide variety of tools and equipment.**

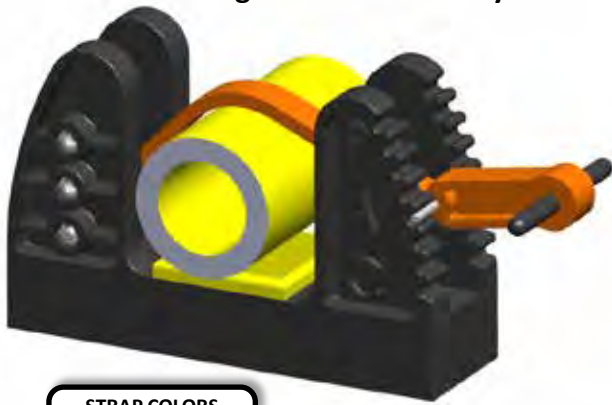

- Molded from high quality materials
- Soft textured pad for extra grip
- Weather, UV resistant
- Non-conductive
- Can be mounted horizontally or vertically



P/N 1070	
STRAP COLORS (please specify)	BLACK YELLOW ORANGE
MOUNTING HARDWARE (INCLUDED)	FLAT SURFACES PAC TRAC
MOUNTING HARDWARE (OPTIONAL)	DUAL TRAC UNISTRUT 2019 UNISTRUT 2020
PRODUCT WT.	1.0 lbs.
DIMENSIONS	7.3" L x 2.3" W x 4.6" H

GRIP RANGE:
3/8" to 3-1/4" (9.5mm-82.6mm)

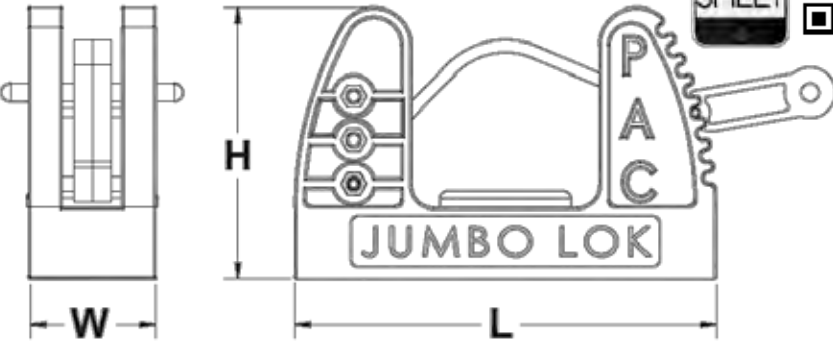

PAC RETURN POLICY

Performance Advantage Company accepts returns of merchandise according to the following criteria:

Contact Performance Advantage Company to receive a Return Goods Authorization (RGA) number and form. This number must be clearly marked on the outside of the package being returned. The completed RGA form must be included in the package being returned. All returns received without a RGA number will be refused and no credit will be issued.

All returns are subject to a 15% restocking fee.

All return shipping charges are the responsibility of the party returning the merchandise.

Performance Advantage Company will not grant a Return Goods Authorization for items that were purchased longer than 60 days from date of original invoice.

Returned merchandise must be in **NEW** and **RESALABLE** condition for credit to be applied.

ADJUSTAMOUNT

PAC

P/N 1006

STRAP COLORS (please specify)	BLACK YELLOW ORANGE
MOUNTING HARDWARE (INCLUDED)	UNISTRUT 2019
MOUNTING HARDWARE (OPTIONAL)	UNISTRUT 2020 PACTRAC DUAL TRAC
PRODUCT WT. DIMENSIONS	1.1 lbs. 1.9" W x 2.5" H



The PAC Adjustamount satisfies a wide range of tool mounting requirements. Intended to mount to Unistrut 2019 (13/16" x 1-5/8"). Adjustamount is one the most versatile products for nearly all equipment mounting situations.

- Rugged injection molded components made from high quality materials
- High performance elastomer strap is rated to 5400psi
- 12.5" usable strap length
- 9" press-in channel cushion included
- Can be mounted horizontally or vertically

GRIP RANGE:
1" to 9" (25mm-228mm)

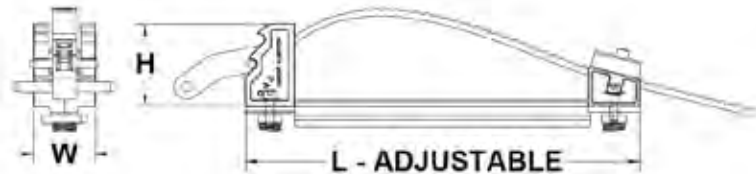

EXTENDED ADJUSTAMOUNT

PAC

P/N 1008

STRAP COLORS (please specify)	BLACK YELLOW ORANGE
MOUNTING HARDWARE (INCLUDED)	UNISTRUT 2019
MOUNTING HARDWARE (OPTIONAL)	UNISTRUT 2020 PACTRAC DUAL TRAC
PRODUCT WT. DIMENSIONS	1.2 lbs. 1.9" W x 2.5" H



The PAC Extended Adjustamount offers the same benefits of the Adjustamount with a longer strap to hold larger items.

- Rugged injection molded components made from high quality materials
- High performance elastomer strap is rated to 5400psi
- 28" usable strap length
- 9" press-in channel cushion included
- Can be mounted horizontally or vertically

GRIP RANGE:
1" to 24" (25mm-610mm)

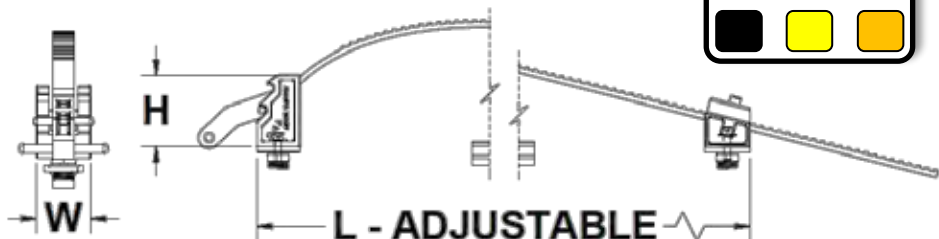



The Super Adjustamount is taller, providing more containment than Adjustamounts. Intended to mount to Unistrut 2019 (13/16" x 1-5/8"). Super Adjustamounts provide the same benefits as Adjustamounts while providing more clearance for latching and releasing.

- Rugged injection molded components made from high quality materials
- High performance elastomer strap is rated to 5400psi
- 9.5" usable strap length
- 9" press-in channel cushion included
- Can be mounted horizontally or vertically

P/N 1050	
STRAP COLORS (please specify)	BLACK YELLOW ORANGE
MOUNTING HARDWARE (INCLUDED)	UNISTRUT 2019
MOUNTING HARDWARE (OPTIONAL)	UNISTRUT 2020 DUAL TRAC
PRODUCT WT. DIMENSIONS	1.3 lbs. 1.9" W x 4.0" H

GRIP RANGE:
1" to 9" (25mm-228mm)

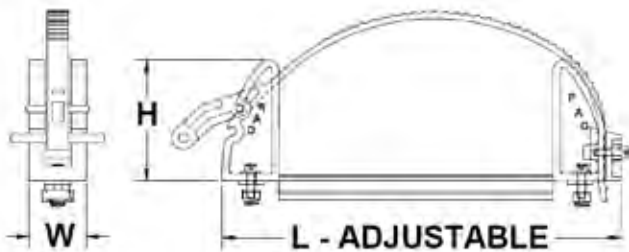

The PAC Super Extended Adjustamount offers the same benefits of the Super Adjustamount with a longer strap to hold larger items.

- Rugged injection molded components made from high quality materials
- High performance elastomer strap is rated to 5400psi
- 25" usable strap length
- 9" press-in channel cushion included
- Can be mounted horizontally or vertically

P/N 1060	
STRAP COLORS (please specify)	BLACK YELLOW ORANGE
MOUNTING HARDWARE (INCLUDED)	UNISTRUT 2019
MOUNTING HARDWARE (OPTIONAL)	UNISTRUT 2020 DUAL TRAC
PRODUCT WT. DIMENSIONS	1.4 lbs. 1.9" W x 4.0" H

GRIP RANGE:
1" to 24" (25mm-610mm)

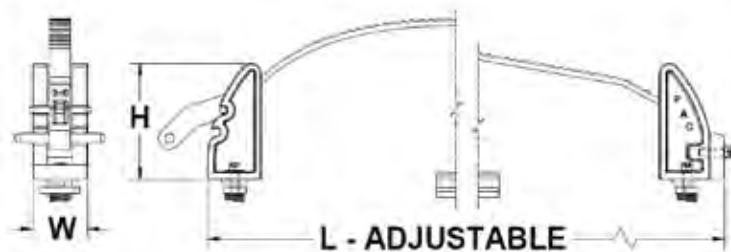



The **NEW** K5020 PAC Fastlok shown holding multiple tools. See page D-4

FOR DIRECT SALES & SERVICE BY A MEMBER OF OUR PROFESSIONAL STAFF CONTACT US THROUGH ONE OF THE CONTACT POINTS LISTED:

MIKE McGUIRE – SALES AND TECHINCAL SUPPORT
MIKE@PACTOOLMOUNTS.COM

TOM TRZEPACZ – TECHINCAL SUPPORT AND PRODUCT TRAINING
TOM@PACTOOLMOUNTS.COM

DEAN MAYHEW – SOUTH & WESTERN U.S. CUSTOMER SUPPORT
DEAN@PACTOOLMOUNTS.COM



JARED ENSER – DIRECT SALES
JARED@PACTOOLMOUNTS.COM

1-888-514-0083 TOLL FREE

WWW.PACTOOLMOUNTS.COM



Stow-N-Loks combine a friction lock action with the security of a positive locking strap. The flexible Y-shaped brackets are designed to provide a secure grip-like mount for poles, nozzles and a wide variety of other tools and equipment. These brackets can be used with or without the strap.

- The strap is easily adjusted for various workholding conditions and sizes
- Taller body to accommodate rakes and other large-head tools
- Rugged injection molded components made from high quality materials
- Weather, UV resistant
- Non-conductive
- Can be mounted horizontally or vertically

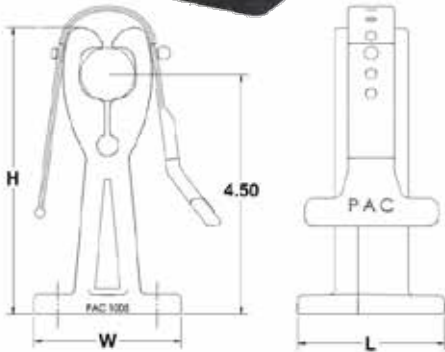

P/N 1005	
STRAP COLORS (please specify)	BLACK YELLOW ORANGE
MOUNTING HARDWARE (INCLUDED)	FLAT SURFACES PAC TRAC
MOUNTING HARDWARE (OPTIONAL)	DUAL TRAC UNISTRUT 2019 UNISTRUT 2020
PRODUCT WT. DIMENSIONS	0.4 lbs. 2.8" L x 2.8" W x 5.3" H

GRIP RANGE:
1" to 1-1/2" (25.4mm-38.1mm)



The low profile version of the Stow-N-Loks combines a friction lock action with the security of a positive locking strap. The flexible Y-shaped brackets are designed to provide a secure grip-like mount for poles, nozzles and a wide variety of other tools and equipment. These brackets can be used with or without the strap.

- The strap is easily adjusted for various workholding conditions and sizes
- Rugged injection molded components made from high quality materials
- Weather, UV resistant
- Non-conductive
- Can be mounted horizontally or vertically

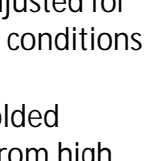
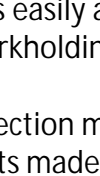
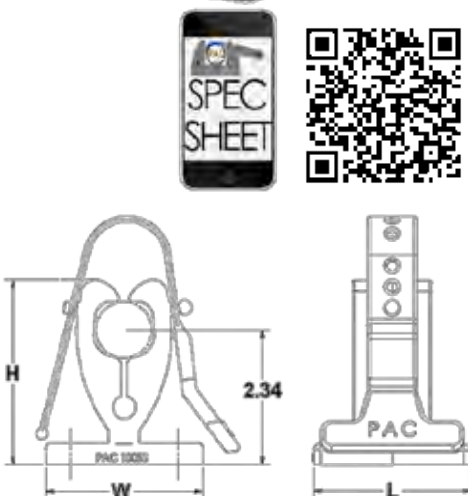

P/N 1005S	
STRAP COLORS (please specify)	BLACK YELLOW ORANGE
MOUNTING HARDWARE (INCLUDED)	FLAT SURFACES PAC TRAC
MOUNTING HARDWARE (OPTIONAL)	DUAL TRAC UNISTRUT 2019 UNISTRUT 2020
PRODUCT WT. DIMENSIONS	0.3 lbs. 2.8" L x 2.8" W x 3.1" H

GRIP RANGE:
1" to 1-1/2" (25.4mm-38.1mm)



FLEXMOUNT (TALL)

PAC

P/N 1002

BASE COLOR	BLACK
MOUNTING HARDWARE (INCLUDED)	FLAT SURFACES PACTRAC
MOUNTING HARDWARE (OPTIONAL)	DUAL TRAC UNISTRUT 2019 UNISTRUT 2020
PRODUCT WT. DIMENSIONS	0.4 lbs. 2.6" L x 1.9" W x 5.4" H

Flexmounts are flexible Y-shaped brackets designed to provide a secure grip-like mount for poles, nozzles and a wide variety of other tools and equipment. Tall size to accommodate tools with larger heads or handles.

- Molded from high quality materials
- Weather, UV resistant
- Non-conductive
- Can be mounted horizontally or vertically

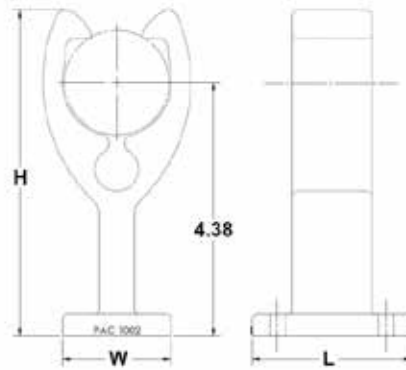

GRIP RANGE:

1-3/4" to 2-1/2" (44.5mm-63.5mm)



FLEXMOUNT (SHORT)

PAC

P/N 1002-2

BASE COLOR	BLACK
MOUNTING HARDWARE (INCLUDED)	FLAT SURFACES PACTRAC
MOUNTING HARDWARE (OPTIONAL)	DUAL TRAC UNISTRUT 2019 UNISTRUT 2020
PRODUCT WT. DIMENSIONS	0.3 lbs. 2.6" L x 1.9" W x 3.8" H

Flexmounts are flexible Y-shaped brackets designed to provide a secure grip-like mount for poles, nozzles and a wide variety of other tools and equipment. Short version saves compartment depth.

- Molded from high quality materials
- Short size for poles
- Weather, UV resistant
- Non-conductive
- Can be mounted horizontally or vertically

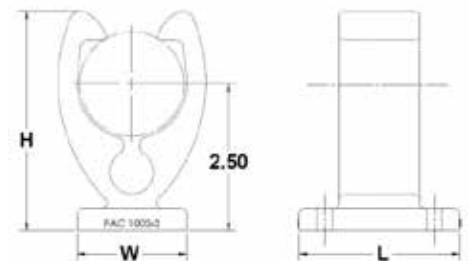

GRIP RANGE:

1-3/4" to 2-1/2" (44.5mm-63.5mm)



SECTION B

HANGERS, HOOKS & STABILIZING BRACKETS



888-514-0083 TOLL FREE

WWW.PACTOOLMOUNTS.COM

PAC

TOOL HANGER

P/N 1009

BASE COLOR	BLACK
MOUNTING HARDWARE (INCLUDED)	FLAT SURFACES PAC TRAC
MOUNTING HARDWARE (OPTIONAL)	DUAL TRAC UNISTRUT 2019 UNISTRUT 2020
PRODUCT WT. DIMENSIONS	0.8 lbs. 6.0" L x 3.6" W x 4.4" H

The Tool Hanger is designed to be a simple hanger bracket for shovels, brooms, and many other T-shaped equipment. Tool Hangers work best when combined with Handlelok brackets - included in the Tool Hanger Kit P/N K5009.

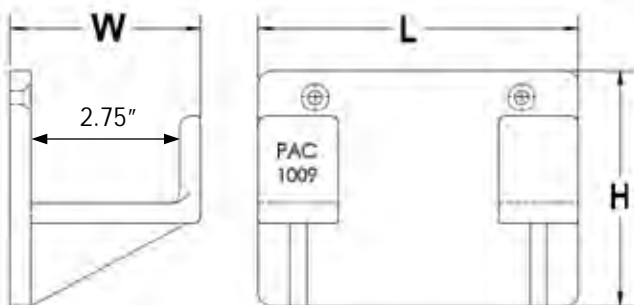
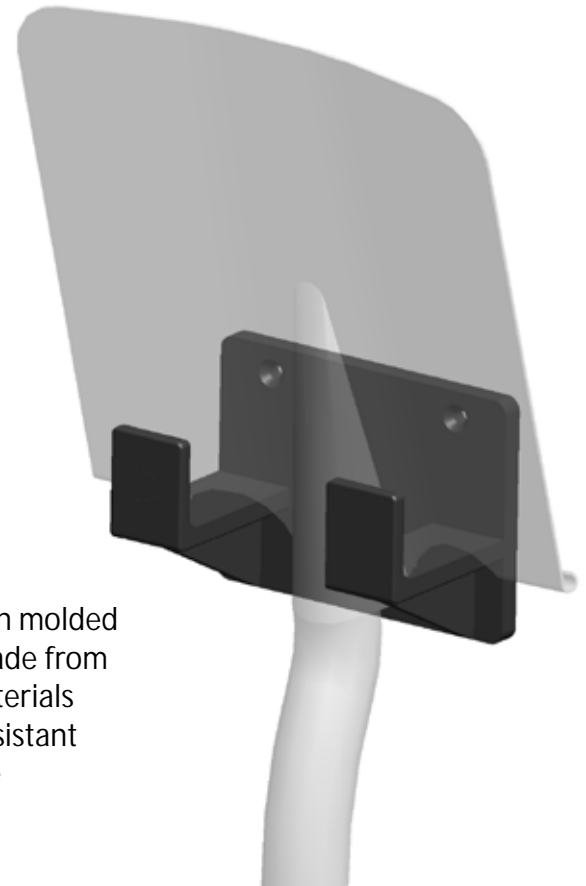

- Rugged injection molded components made from high quality materials
- Weather, UV resistant
- Non-conductive

FLATHEAD AXE HANGER/POCKET

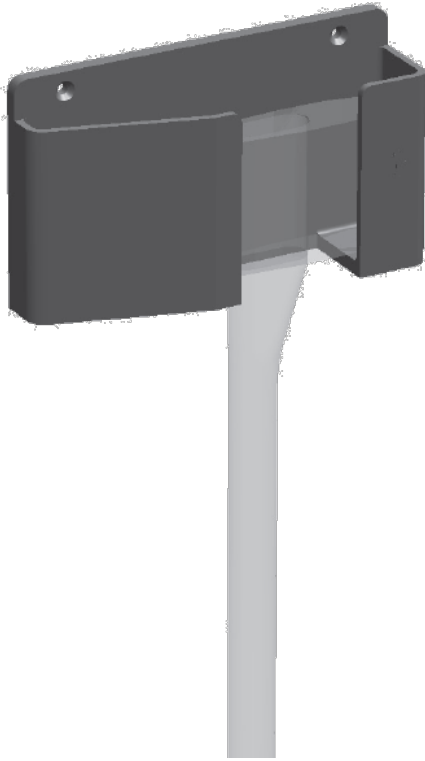

The Flathead Axe Hanger/Pocket is designed to hold a Flathead Axe hanging or supported as a pocket. The Flathead Axe Hanger/Pocket works best with the Handlelok bracket P/N 1004 - included in the Flathead Axe Hanger/Pocket Kit P/N K5011.

- Molded from high quality materials
- Easy to use
- Weather, UV resistant
- Non-conductive
- Can be mounted below or on top

P/N 1011	
BASE COLOR	BLACK
MOUNTING HARDWARE (INCLUDED)	FLAT SURFACES PAC TRAC
MOUNTING HARDWARE (OPTIONAL)	DUAL TRAC UNISTRUT 2019 UNISTRUT 2020
PRODUCT WT. DIMENSIONS	1.5 lbs. 10.3"L x 2.5"W x 6.0"H

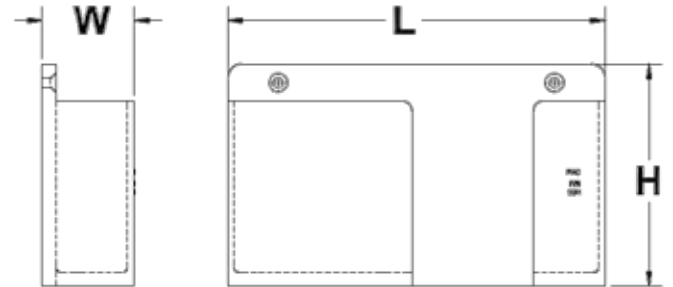

PICKHEAD AXE HANGER/POCKET



Pickhead Axe Hanger/Pocket is designed for a Pickhead Axe hanging or supported as a pocket. The Pickhead Axe Hanger/Pocket works best with the Handlelok bracket P/N 1004 included in the Pickhead Axe Hanger/Pocket Kit P/N K5012.

- Molded from high quality materials
- Easy to use
- Weather, UV resistant
- Non-conductive
- Can be mounted below or on top

P/N 1012	
BASE COLOR	BLACK
MOUNTING HARDWARE (INCLUDED)	FLAT SURFACES PAC TRAC
MOUNTING HARDWARE (OPTIONAL)	DUAL TRAC UNISTRUT 2019 UNISTRUT 2020
PRODUCT WT. DIMENSIONS	1.9 lbs. 12.8"L x 2.5"W x 6.0"H



P/N 1010

BASE COLOR	BLACK
MOUNTING HARDWARE (INCLUDED)	FLAT SURFACES PAC TRAC
MOUNTING HARDWARE (OPTIONAL)	DUAL TRAC UNISTRUT 2019 UNISTRUT 2020
PRODUCT WT. DIMENSIONS	0.9 lbs. 7.5" L x 3.3" W x 4.3" H

The Sledge Hanger/Pocket is designed hold a sledge hammer head hanging or supported as a pocket. Sledge Hanger works best with Handlelok brackets included in the Sledge Hanger Kits P/N K5010.

- Molded from high quality materials
- Easy to use
- Weather, UV resistant
- Non-conductive
- Can be mounted as a hanger or as a supporting base.

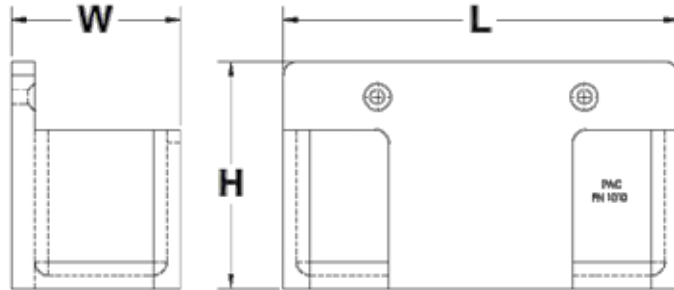
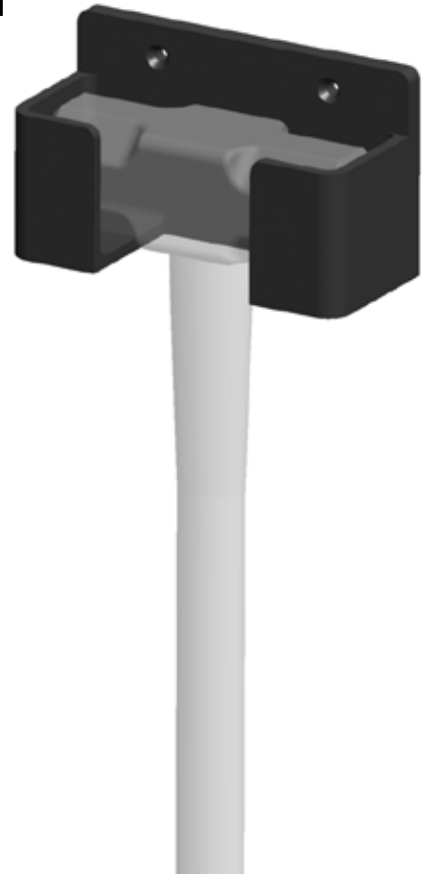

P/N 1010-12

BASE COLOR	BLACK
MOUNTING HARDWARE (INCLUDED)	FLAT SURFACES PAC TRAC
MOUNTING HARDWARE (OPTIONAL)	DUAL TRAC UNISTRUT 2019 UNISTRUT 2020
PRODUCT WT. DIMENSIONS	1.1 lbs. 8.0" L x 3.4" W x 4.5" H

The Sledge Hanger/Pocket is designed hold a sledge hammer head hanging or supported as a pocket. Sledge Hanger works best with Handlelok brackets included in the Sledge Hanger Kits P/N K5010-12.

- Molded from high quality materials
- Easy to use
- Weather, UV resistant
- Non-conductive
- Can be mounted as a hanger or as a supporting base.

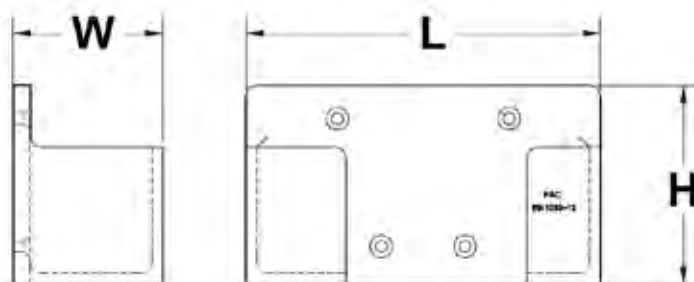
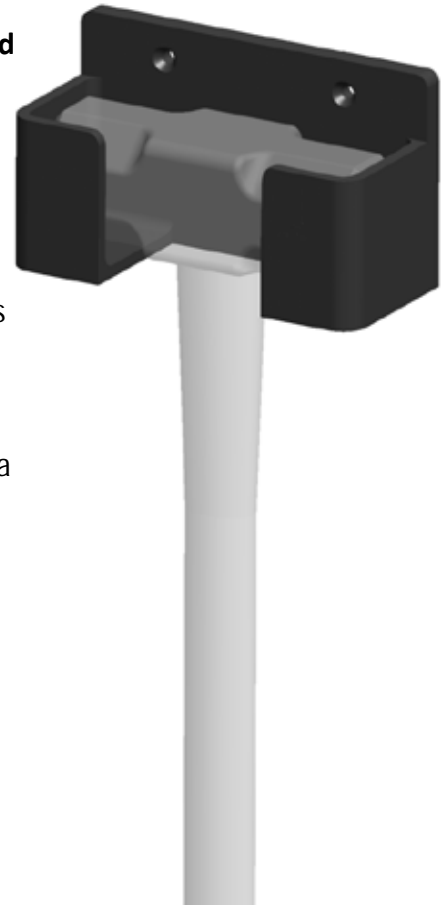

UNIVERSAL HANGER

PAC

P/N 1019

BASE COLOR	BLACK
MOUNTING HARDWARE (INCLUDED)	FLAT SURFACES PAC TRAC
MOUNTING HARDWARE (OPTIONAL)	DUAL TRAC UNISTRUT 2019 UNISTRUT 2020
PRODUCT WT. DIMENSIONS	0.4 lbs. 2.9" L x 3.5" W x 4.5" H

The Universal Hanger is designed for hanging various items such as cords, ropes, chains and tools.

- Can be used alone or in multiples
- Easy to use
- Molded from high quality materials
- Weather, UV resistant
- Non-conductive

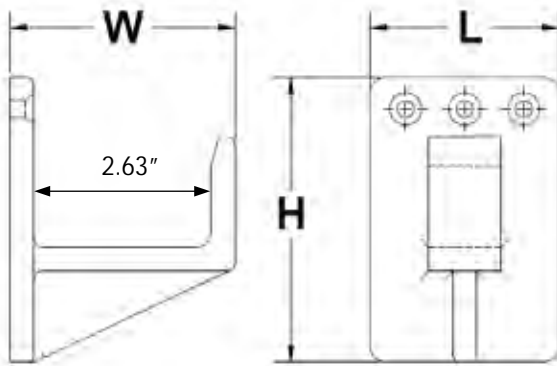

GM HOOK

PAC

The GM Hook is a quick and secure way to mount or hang lightweight equipment which have a latch, hook or loop for mounting. Ideal for keys, helmets, masks and much more.

- Integrated latch to retain item
- Molded from high strength material
- Multiple uses
- Attaches with permanent double sided tape
- No drilling required
- No mounting hardware needed

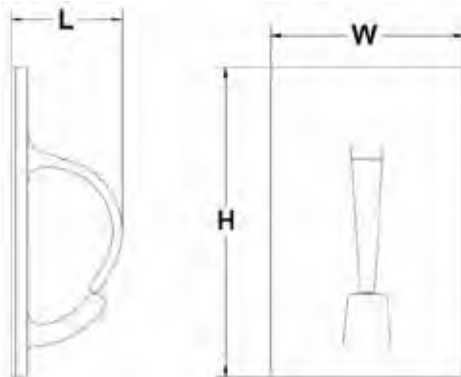

P/N 1028

BASE COLOR (please specify)	BLACK GREEN
MOUNTING HARDWARE (INCLUDED)	DOUBLE SIDED TAPE
MOUNTING HARDWARE (OPTIONAL)	N/A
PRODUCT WT. DIMENSIONS	0.1 lbs. 1.5" L x 2.5" W x 4.0" H



P/N 1029

BASE COLOR	BLACK
MOUNTING HARDWARE (INCLUDED)	FLAT SURFACES PAC TRAC
MOUNTING HARDWARE (OPTIONAL)	DUAL TRAC
PRODUCT WT. DIMENSIONS	0.3 lbs. 2.8" L x 2.0" W x 3.5" H

Originally designed for power tools with tubular handles, the Hook Mount provides a strong and secure hanging mount for a variety of other tools and equipment.

- Molded from high quality materials
- Easy to use
- Weather, UV resistant.
- Impact resistant
- Non-conductive

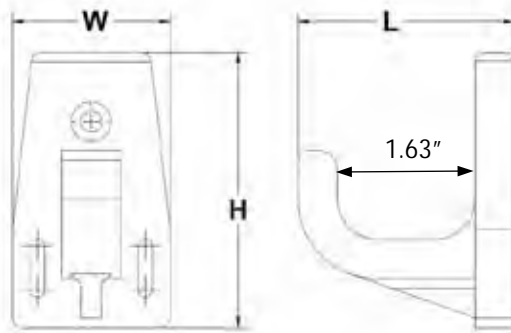

P/N 1027

BASE COLOR (please specify)	BLACK GREEN
MOUNTING HARDWARE (INCLUDED)	FLAT SURFACES PAC TRAC
MOUNTING HARDWARE (OPTIONAL)	N/A
PRODUCT WT. DIMENSIONS	0.3 lbs. 4.3" L x 3.8" W x 3.0" H

The Loop Hook is a unique and efficient way to mount or hang equipment that utilize locking straps.

- Strong and versatile
- Molded from high strength material
- Impact resistant
- Multiple uses

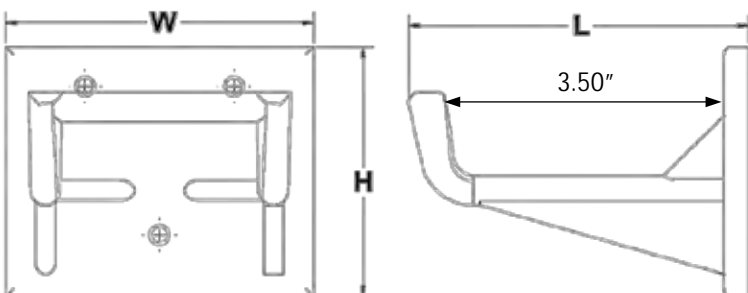



Universal Mounts can be used as guides, bumpers or arranged in three for locating round equipment such as extinguishers and rams. Universal Mounts are a great companion with Super Adjustamount Kits, P/N K5050.

- Molded from high quality material
- Simple and flexible mounting
- Weather, UV resistant
- Non-conductive
- Sold individually

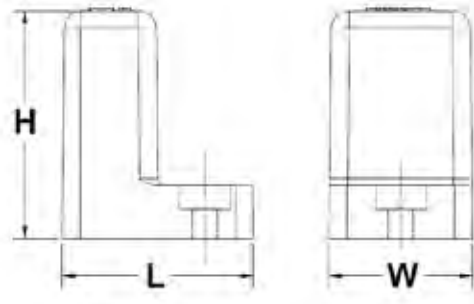

P/N 1007

BASE COLOR	BLACK
MOUNTING HARDWARE (INCLUDED)	FLAT SURFACES PAC TRAC
MOUNTING HARDWARE (OPTIONAL)	DUAL TRAC
PRODUCT WT. DIMENSIONS	0.2 lbs. 2.0" L x 1.5" W x 2.3" H

CUP MOUNT

SUPPORT LOCATE PROTECT

PAC **Cup Mount** P/N 1033 is a protective base which also provides positioning and locating under many different types of equipment including SCBA cylinders, Rams, Jacks, Saws and Hydraulic Pumps.

Installs easily without tools. Cup Mounts are a logical companion to **Fastlok Adjustamount, Jumbo Lok** and other PAC brackets.

- Components molded from high quality materials
- Non-metallic. Wont rust or corrode.
- Attaches with double sided VHB tape.
- Use as a base to protect standing equipment.
- Use as a locator guide under equipment feet.
- Use a support under heavy loads.
- Sold Individually



P/N 1033

BASE COLOR	BLACK
MOUNTING HARDWARE (INCLUDED)	FLAT SURFACES
MOUNTING HARDWARE (OPTIONAL)	DUAL TRAC UNISTRUT 2019 UNISTRUT 2020
PRODUCT WT. DIMENSIONS	.05 lbs. 4" W X 15/32"



SECTION C



TOOL SPECIFIC BRACKETS

888-514-0083 TOLL FREE

WWW.PACTOOLMOUNTS.COM

PAC

IRONSLOK

P/N K5003

STRAP COLORS (please specify)	BLACK YELLOW ORANGE
MOUNTING HARDWARE (INCLUDED)	FLAT SURFACES PAC TRAC
MOUNTING HARDWARE (OPTIONAL)	N/A
PRODUCT WT. DIMENSIONS	8.0 lbs. 33.0"L x 8.0"W x 11.5"H

The Ironslok bracket is designed for a set of irons which is a 30" Halligan tool and a 36" flathead axe. Positive locking with high strength lock strap.



- Ironslok components are molded from high quality materials
- Durable and secure
- Can be mounted horizontal or vertical

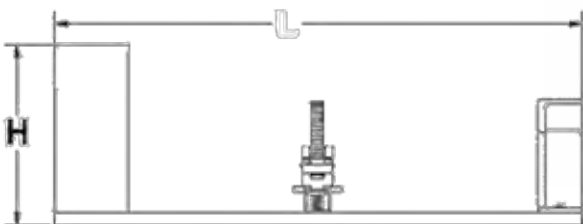

P/N K5032

STRAP COLORS (please specify)	BLACK YELLOW ORANGE
MOUNTING HARDWARE (INCLUDED)	FLAT SURFACES PAC TRAC
MOUNTING HARDWARE (OPTIONAL)	N/A
PRODUCT WT. DIMENSIONS	2.6 lbs. Var. L x 9.5" W x 7.0" H

The Halligan Tool Mounting Kit is a safe, secure and dependable storage solution in any position or orientation. The Claw End and Point End Holders are combined with a Toolok bracket P/N 1003 to provide a complete tool mounting solution for a wide variety of Halligan type tools.

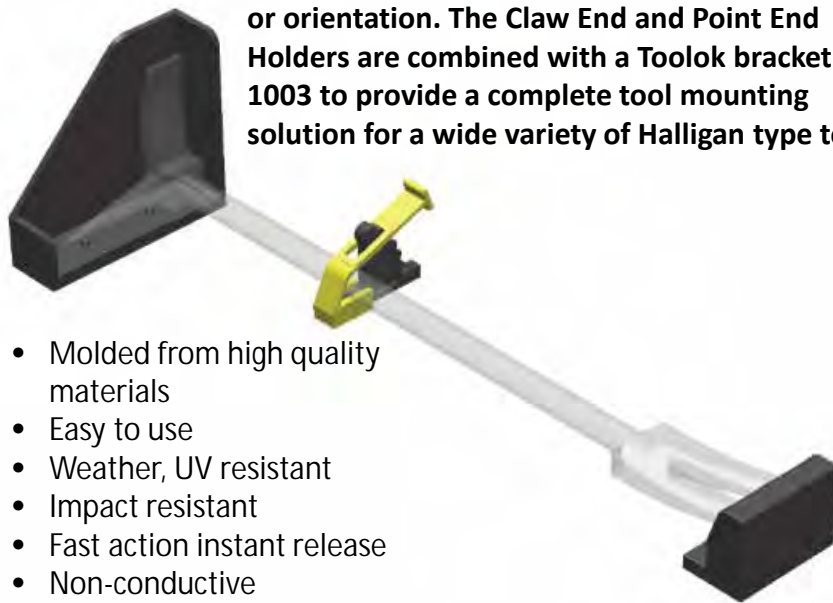

- Molded from high quality materials
- Easy to use
- Weather, UV resistant
- Impact resistant
- Fast action instant release
- Non-conductive



PAC WARRANTY

IF ANY PART FAILS UNDER NORMAL SERVICE IT WILL BE REPLACED – NO CHARGE – PERIOD.

EXCEPT FOR THE PAC WARRANTY, WE DISCLAIM LIABILITY FOR INCIDENTAL AND CONSEQUENTIAL DAMAGES FOR BREACH OF ANY EXPRESS OR IMPLIED WARRANTY. WE DISCLAIM ANY WARRANTIES OF MERCHANTABILITY OR FITNESS FOR A PARTICULAR PURPOSE.

Storz Loks provide a safe secure way to store Storz hose couplings.

Easy twist-on storage. New 6" size for larger Municipal Fire Departments as well the Oil and Gas industry!

- Mounts in any position
- Weather, UV resistant
- Impact resistant
- Non-conductive

Scan with your
phone for
Instructions!!



	P/N 1040-4	P/N 1040-5	P/N 1040-6
SIZE	4"	5"	6"
BASE COLOR	BLACK		
MOUNTING HARDWARE (INCLUDED)	FLAT SURFACES PAC TRAC		
MOUNTING HARDWARE (OPTIONAL)	DUAL TRAC UNISTRUT 2019 UNISTRUT 2020		
PRODUCT WT.	0.4 lbs.	0.6 lbs.	0.8 lbs.
DIMENSIONS	5.6" L x 1.4" W x 4.5" H	7.0" L x 1.5" W x 5.8" H	6.9" L x 1.5" W x 7.0" H

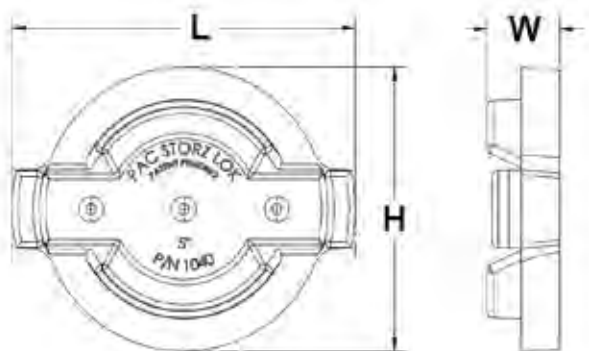

1040-4 & 1040-5

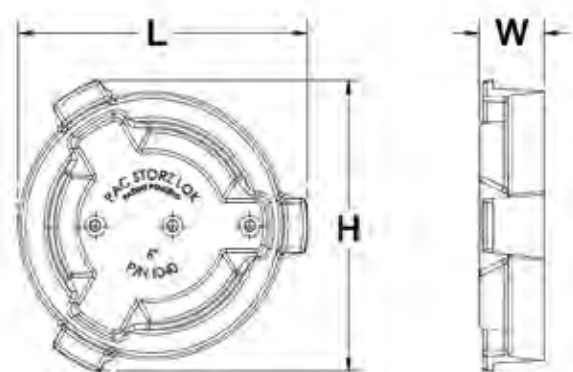

1040-6

ADAPTER LOK 1-1/2"

PAC

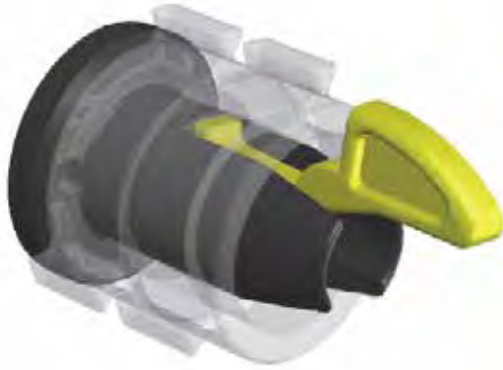

P/N 1042-1

BASE COLOR	BLACK
MOUNTING HARDWARE (INCLUDED)	FLAT SURFACES PAC TRAC
MOUNTING HARDWARE (OPTIONAL)	DUAL TRAC
PRODUCT WT.	0.3 lbs.
DIMENSIONS	4.5" L x 2.5" W x 2.8" H

1-1/2" Adapter Loks keep your adapters organized and ready to use. Adapters easily slide on and are retained by the locking feature. Simply depress the highly visible lock to remove the adapters.

- Molded from high quality materials
- Accepts both double male and female adapters
- Includes Spacer Ring to allow for variations in adapter lengths
- Weather, UV resistant
- Impact resistant
- Non-conductive

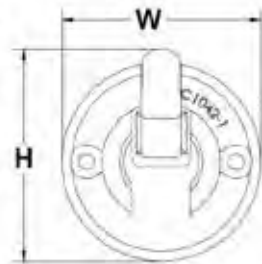
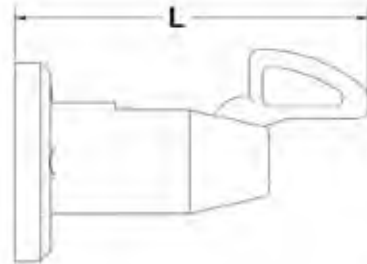

ADAPTER LOK 2-1/2"

PAC

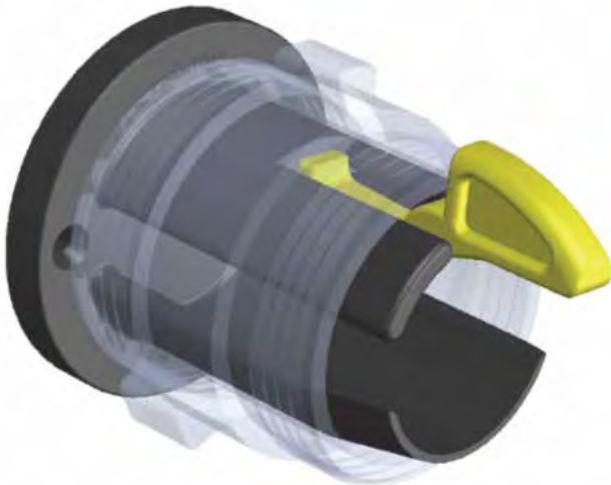

P/N 1042-2

BASE COLOR	BLACK
MOUNTING HARDWARE (INCLUDED)	FLAT SURFACES PAC TRAC
MOUNTING HARDWARE (OPTIONAL)	DUAL TRAC
PRODUCT WT.	0.5 lbs.
DIMENSIONS	5.3" L x 3.6" W x 3.6" H

2-1/2" Adapter Loks keep your adapters organized and ready to use. Adapters easily slide on and are retained by the locking feature. Simply depress the highly visible lock to remove the adapters.

- Molded from high quality materials
- Accepts both double male and female adapters
- Includes Spacer Ring to allow for variations in adapter lengths
- Weather, UV resistant
- Impact resistant
- Non-conductive

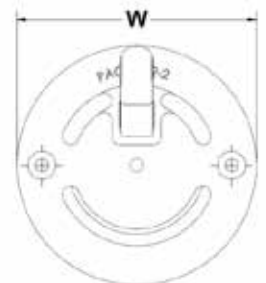
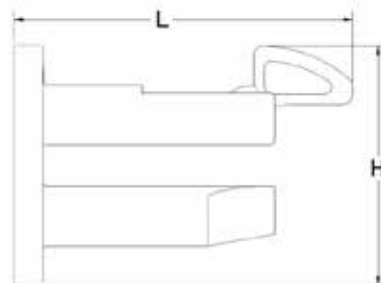

P/N 1042-D

BASE COLOR	BLACK
MOUNTING HARDWARE (INCLUDED)	FLAT SURFACES PAC TRAC
MOUNTING HARDWARE (OPTIONAL)	DUAL TRAC
PRODUCT WT.	0.6 lbs.
DIMENSIONS	8.4" L x 3.6" W x 3.6" H

The Dual Adapter Lok is designed to secure two 2-1/2" adapters. This space saving bracket allows adapters quickly slide on and are retained by the locking feature. Simply depress the highly visible lock to remove the adapters.

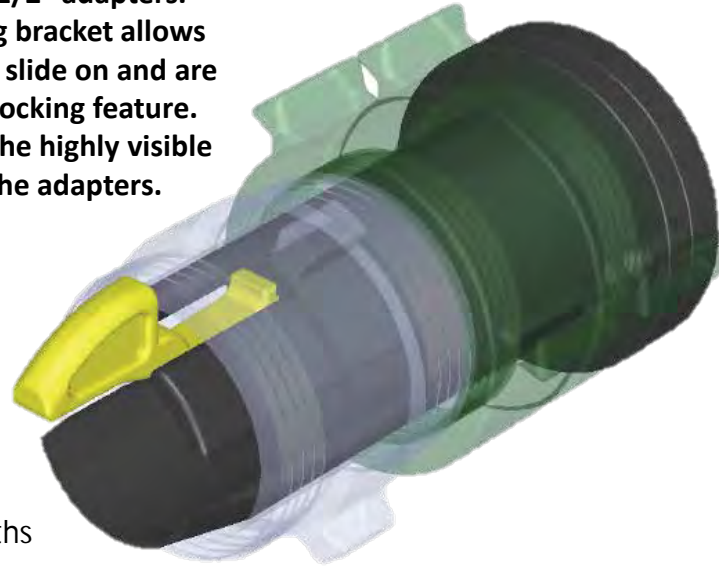

- Accepts 2 adapters
- Molded from high quality materials
- Accepts both double male and double female adapters
- Includes Spacer Ring to allow for variations in adapter lengths
- Weather, UV resistant
- Impact resistant
- Non-conductive

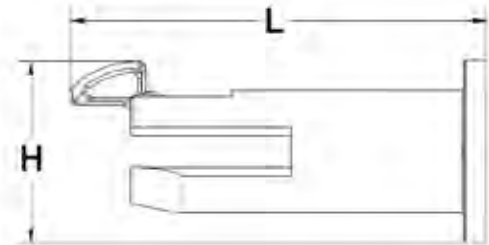

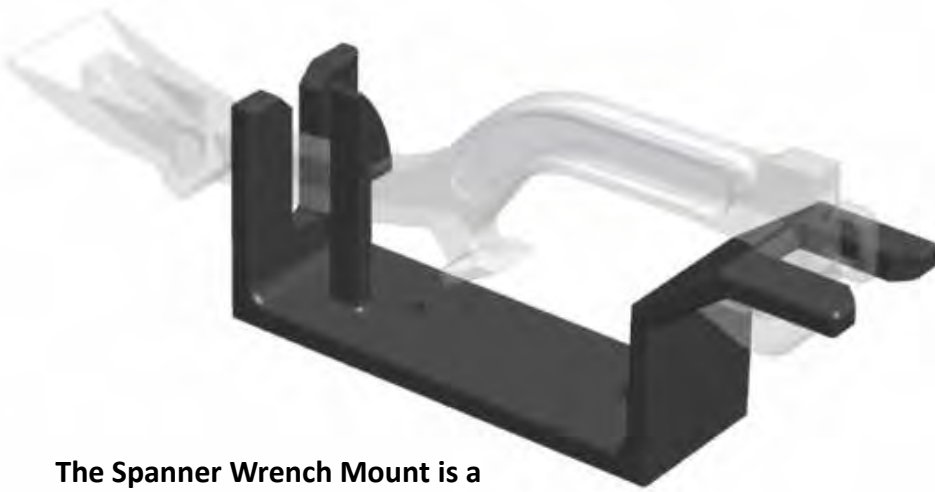

The Spanner Wrench Mount is a molded one piece bracket designed to mount a standard #10 spanner wrench.

- Molded from high quality materials
- Easy to use
- Weather, UV resistant
- Impact resistant
- Fast action instant release
- Non-conductive

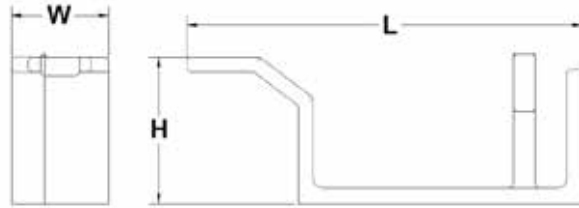

P/N 1016

BASE COLOR	BLACK
MOUNTING HARDWARE (INCLUDED)	FLAT SURFACES PAC TRAC
MOUNTING HARDWARE (OPTIONAL)	DUAL TRAC
PRODUCT WT. DIMENSIONS	0.4 lbs. 8.3" L x 2.0" W x 3.0" H

The Hydrant Wrench Mount is a molded one piece bracket designed to mount a standard Elkhart S-454 combination hydrant wrench.

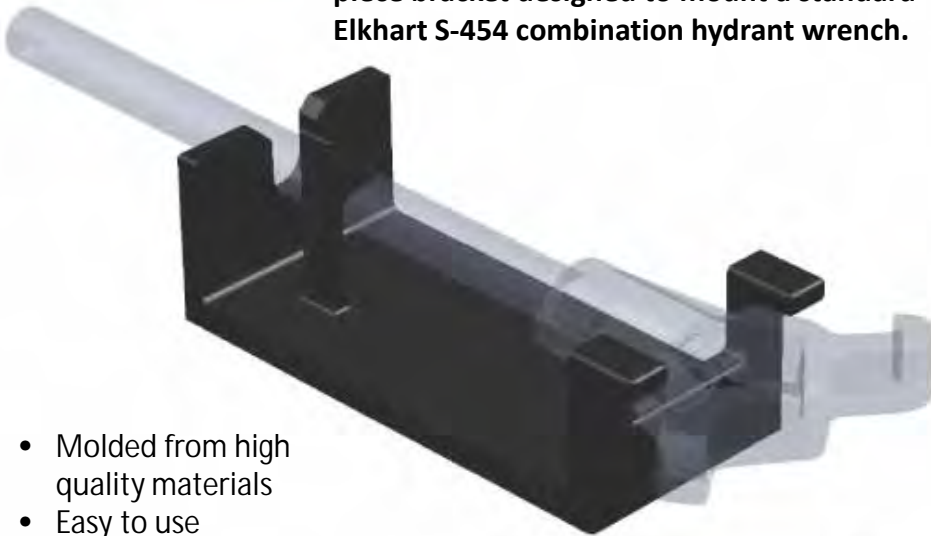

- Molded from high quality materials
- Easy to use
- Weather, UV resistant
- Impact resistant
- Fast action instant release
- Non-conductive

Scan with your phone for Instructions!!

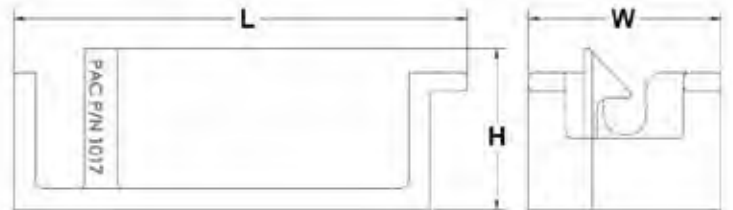

P/N 1017

BASE COLOR	BLACK
MOUNTING HARDWARE (INCLUDED)	FLAT SURFACES PAC TRAC
MOUNTING HARDWARE (OPTIONAL)	DUAL TRAC
PRODUCT WT. DIMENSIONS	1.0 lbs. 9.3" L x 4.0" W x 3.3" H

TESTING AND CERTIFICATION

A variety of PAC products are tested and certified to meet and exceed the NFPA 1901 9G impact standard.

PAC's NFPA Compliant products have been tested and certified at the Akron Rubber Development Laboratory, Akron, Ohio.



For a list of our 9G Certified Products or a copy of PAC's Certificate of Compliance, please contact us at 888-514-0083.

MILITARY GRADE B SHOCK TESTING



To service the equipment mounting needs of the United States Military, it was necessary for PAC to submit the products under consideration to a very demanding testing scenario. As you might expect, the environments that the U.S. Military operates within presents operational demands like no other industry. PAC subjected many of their products (as specified) to a rigorous and high intensity set of Shock Test requirements. The performance of these products would have to be proven under shock impacts ranging from a low end standard of 100 G-Forces, to in excess of 150 G's. These testing requirements establish the benchmark for specified usage of our products in applications ranging from Damage Control Stations onboard Aircraft Carriers and Destroyers, to tool mounting applications on Armored Personnel Carriers and Humvees. In every sequence, PAC products met or exceeded these performance standards. As a result, PAC has now become the "go to" company regarding tool and equipment mounting for the U.S. Military.



PERFORMANCE ADVANTAGE CO.

FIRE APPARATUS INSTALLATIONS

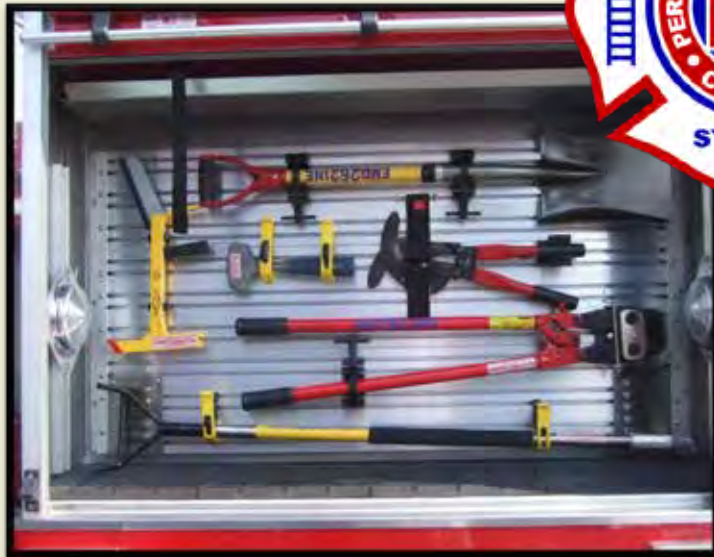
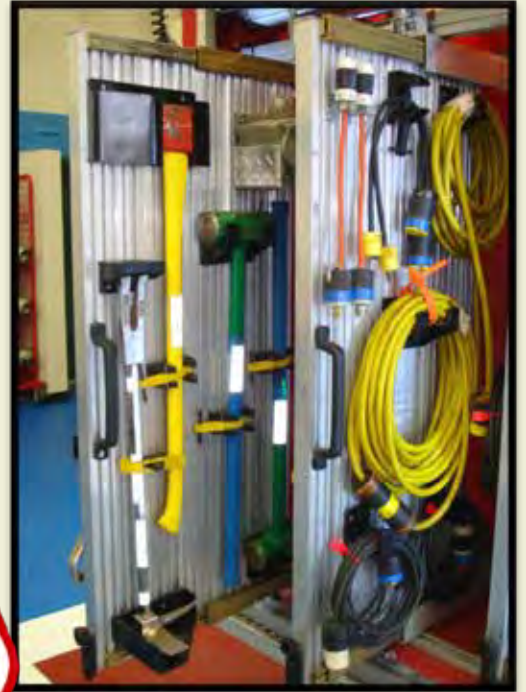

SECTION D



BRACKET KITS

888-514-0083 TOLL FREE

WWW.PACTOOLMOUNTS.COM

PAC

STOW-N-LOK KITS

P/N K5005 & K5005S

STRAP COLORS (please specify)	BLACK YELLOW ORANGE
MOUNTING HARDWARE (INCLUDED)	FLAT SURFACES PAC TRAC
MOUNTING HARDWARE (OPTIONAL)	DUAL TRAC UNISTRUT 2019 UNISTRUT 2020
PRODUCT WT.	0.8 lbs. & 0.6 lbs (S)

Combining a friction lock action with the security of a positive locking strap, the flexible Y-shaped brackets are designed to provide a secure grip-like mount for poles, nozzles and a wide variety of other tools and equipment. These brackets can be used with or without the strap. The strap is easily adjusted for various work-holding conditions and sizes. Each kit includes 1 PAIR of our useful Stow-N-Lok brackets.

- Molded from high quality materials
- Two sizes: Standard and Short (S)
- Weather, UV resistant
- Non-conductive
- Can be mounted horizontally or vertically



Scan with your phone for Instructions!!



ADJUSTAMOUNT KIT



P/N K5006

STRAP COLORS (please specify)	BLACK YELLOW ORANGE
MOUNTING HARDWARE (INCLUDED)	FLAT SURFACES PAC TRAC
MOUNTING HARDWARE (OPTIONAL)	DUAL TRAC UNISTRUT 2019 UNISTRUT 2020
PRODUCT WT.	1.6 lbs.



The **ADJUSTAMOUNT KIT** satisfies a wide range of tool mounting requirements and provide the most versatile and flexible solution for most every equipment mounting application. Commonly combined with other PAC brackets to provide complete tool mounting solutions. Includes 1006 & 12" long section of 2019 (13/16" x 1-5/8") Unistrut channel.

- Components are molded from high quality materials
- Adjustable lock strap capable to 5400 PSI tensile strength
- 12.5" usable strap length
- Can be mounted horizontally or vertically

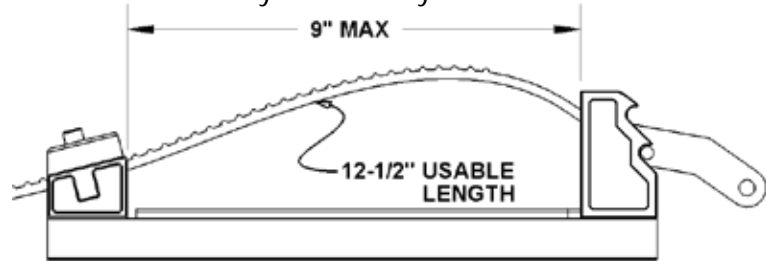

Note: Also available on P/N 2020 (1-5/8" x 1-5/8") Unistrut. Please specify K5006-1 when ordering.



EXTENDED ADJUSTAMOUNT KIT



P/N K5008

STRAP COLORS (please specify)	BLACK YELLOW ORANGE
MOUNTING HARDWARE (INCLUDED)	FLAT SURFACES PAC TRAC
MOUNTING HARDWARE (OPTIONAL)	DUAL TRAC UNISTRUT 2019 UNISTRUT 2020
PRODUCT WT.	2.3 lbs.



The **EXTENDED ADJUSTAMOUNT KIT** offers more tool mounting capacity than our standard Adjustamount Kit. All **ADJUSTAMOUNTS KITS** are commonly combined with other PAC brackets to provide complete tool mounting solutions. Includes 1008 & 24" long section of 2019 (13/16" x 1-5/8") Unistrut channel.

- Components are molded from high quality materials
- Adjustable lock strap capable to 5400 PSI tensile strength
- 28" usable strap length
- Can be mounted horizontally or vertically

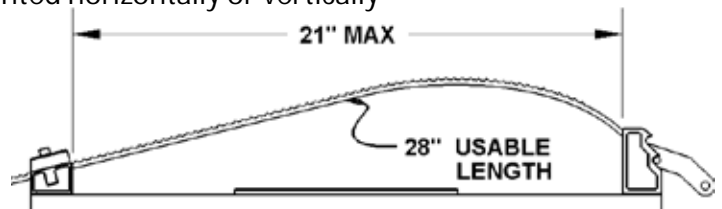

Note: Also available on P/N 2020 (1-5/8" x 1-5/8") Unistrut. Please specify K5008-1 when ordering.



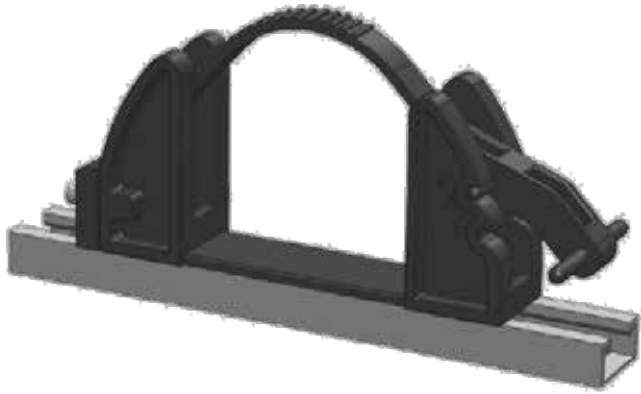

P/N K5050	
STRAP COLORS (please specify)	BLACK YELLOW ORANGE
MOUNTING HARDWARE (INCLUDED)	FLAT SURFACES PAC TRAC
MOUNTING HARDWARE (OPTIONAL)	DUAL TRAC UNISTRUT 2019 UNISTRUT 2020
PRODUCT WT.	1.8 lbs.

The SUPER ADJUSTAMOUNT KIT offers more tool mounting capacity than our standard Adjustamount Kit.

SUPER ADJUSTAMOUNTS KITS are commonly combined with other PAC brackets to provide complete tool mounting solutions. SUPER ADJUSTAMOUNT modules are TALLER than standard ADJUSTAMOUNT modules.

Includes 1050 & 12" long section of 2019 (13/16" x 1-5/8") Unistrut channel.

- Components are molded from high quality materials
- Adjustable lock strap capable to 5400 PSI tensile strength
- 9.5" usable strap length
- Can be mounted horizontally or vertically

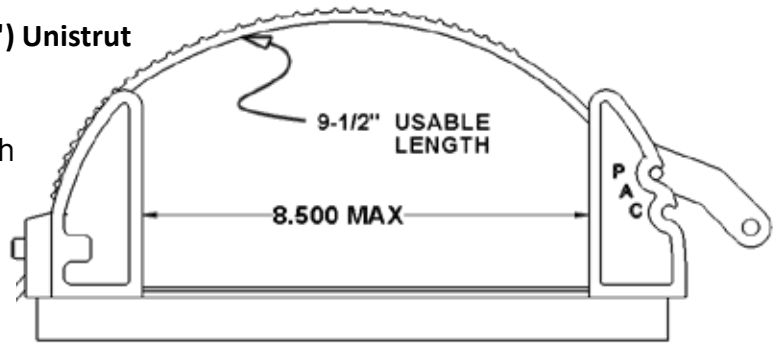

Note: Also available on Unistrut 1-5/8" x 1-5/8" (P/N 2020). Please specify K5050-1 when ordering

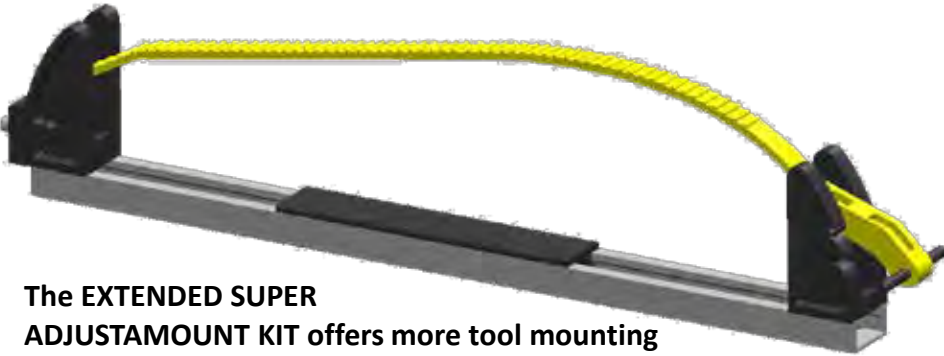

P/N K5060	
STRAP COLORS (please specify)	BLACK YELLOW ORANGE
MOUNTING HARDWARE (INCLUDED)	FLAT SURFACES PAC TRAC
MOUNTING HARDWARE (OPTIONAL)	DUAL TRAC UNISTRUT 2019 UNISTRUT 2020
PRODUCT WT.	2.4 lbs.

The EXTENDED SUPER ADJUSTAMOUNT KIT offers more tool mounting capacity than our standard Adjustamount Kit.

Includes 1060 & 24" long section of 2019 (13/16" x 1-5/8") Unistrut channel.

- Components are molded from high quality materials
- Adjustable lock strap capable to 5400 PSI tensile strength
- 25" usable strap length
- Can be mounted horizontally or vertically

Note: Also available on Unistrut 1-5/8" x 1-5/8" (P/N 2020). Please specify K5060-1 when ordering

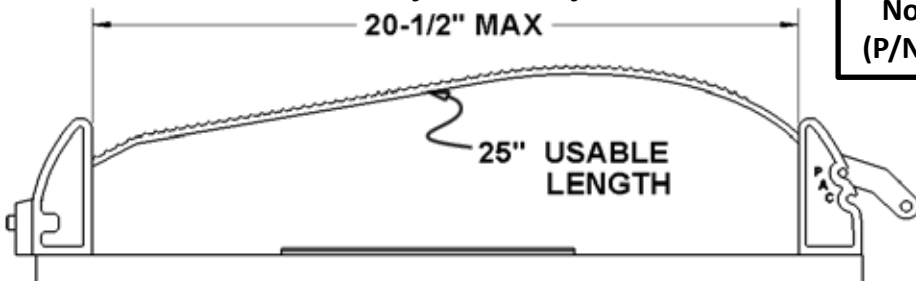

P/N K5009

STRAP COLORS (please specify)	BLACK YELLOW ORANGE
MOUNTING HARDWARE (INCLUDED)	FLAT SURFACES PAC TRAC
MOUNTING HARDWARE (OPTIONAL)	DUAL TRAC UNISTRUT 2019 UNISTRUT 2020
PRODUCT WT.	1.1 lbs.

The Tool Hanger Kit is designed to be a simple hanger solution for shovels, brooms and many other T-shaped equipment. The Tool Hanger Kit includes Tool Hanger Bracket P/N 1009 and the Handlelok Bracket P/N 1004

- Molded from high quality materials
- Easy to use
- Weather, UV resistant
- Non-conductive

Scan with your phone for Instructions!!



NFPA 1901
COMPLIANT

UNIVERSAL HANGER KIT

P/N K5019



The Universal Hanger Kit is designed for hanging various items such as cords, ropes, chains and tools.

The Universal Hanger Kit contains two Universal Hanger Brackets P/N 1019 and one Handlelok P/N 1004.

- Molded from high quality materials
- Easy to use

STRAP COLORS (please specify)	BLACK YELLOW ORANGE
MOUNTING HARDWARE (INCLUDED)	FLAT SURFACES PAC TRAC
MOUNTING HARDWARE (OPTIONAL)	DUAL TRAC UNISTRUT 2019 UNISTRUT 2020
PRODUCT WT.	1.2 lbs.

- Weather, UV resistant
- Impact resistant
- Non-conductive



**PAC offers the FASTLOK, one of the newest items in our line!
Securing larger and heavier items is now even easier!**

- § Easily and quickly secure equipment - even with gloves on.
- § Track base provides fast setup and adjustment to mount a wide variety of equipment such as:
 - Fire extinguishers
 - Air cylinders
 - Hydraulic pumps
 - Rescue tools
 - Chain saws
 - Oxygen cylinders
 - And many more!
- § Easily Re-adjustable
- § No metal to metal contact
- § UV resistant
- § Also available in longer version with more grip range - PN K5020L

P/N K5020	
STRAP COLORS (please specify)	BLACK YELLOW ORANGE
MOUNTING HARDWARE (INCLUDED)	FLAT SURFACES
PRODUCT WT.	3.0

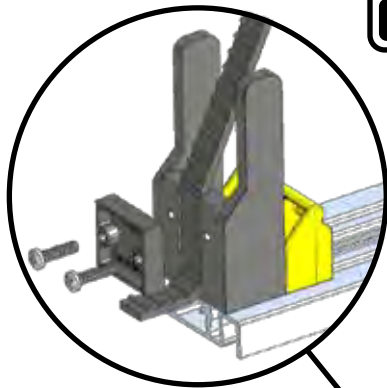
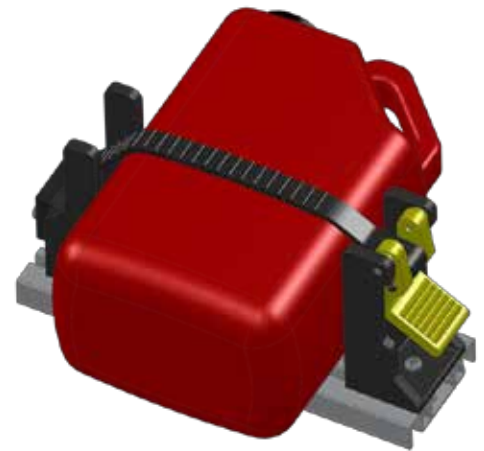
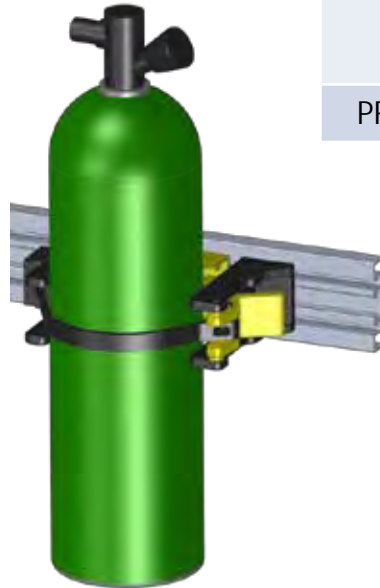

ADJUSTABLE STRAP LENGTH

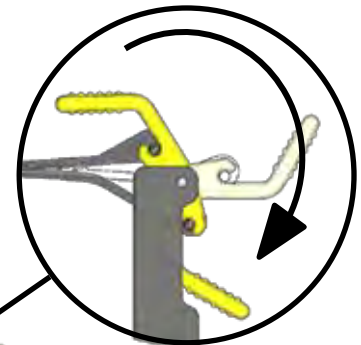
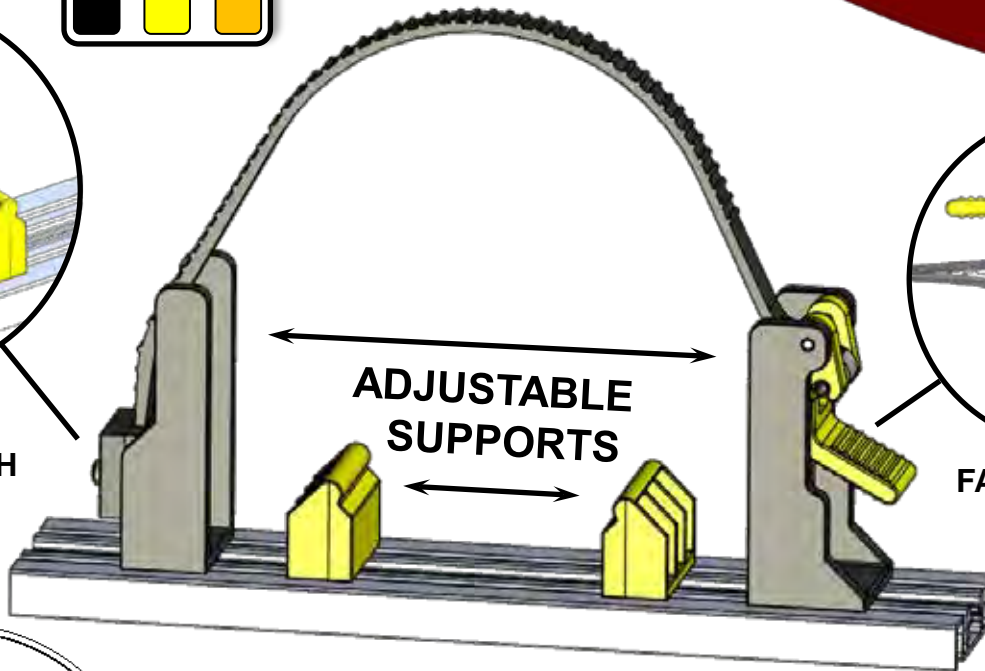

FAST LOCKING LEVER

**K5020L
25" USABLE LENGTH**

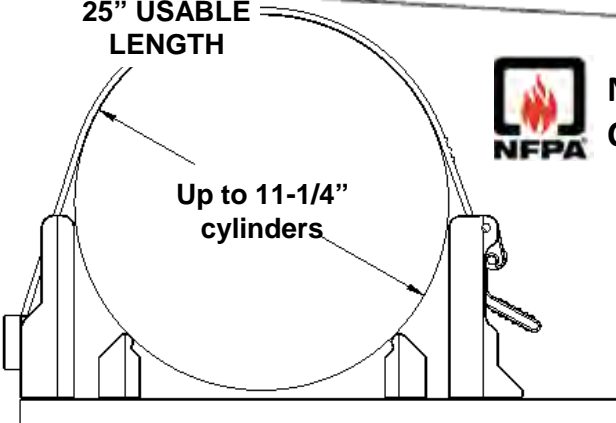

Up to 11-1/4" cylinders



**NFPA 1901
COMPLIANT**



**K5020
9.5" USABLE LENGTH**

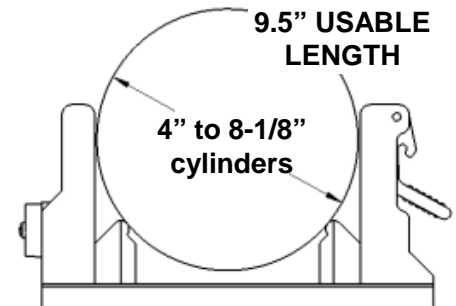

4" to 8-1/8" cylinders

8-10# SLEDGE HANGER/POCKET KIT

PAC

P/N K5010

STRAP COLORS (please specify)	BLACK YELLOW ORANGE
MOUNTING HARDWARE (INCLUDED)	FLAT SURFACES PAC TRAC
MOUNTING HARDWARE (OPTIONAL)	DUAL TRAC UNISTRUT 2019 UNISTRUT 2020
PRODUCT WT.	1.3 lbs.

The Sledge Hanger/Pocket Kit is designed to hold a 8-10lb. sledge hammer hanging OR supported as a pocket. Sledge Hanger Kit includes both the Sledge Hanger Pocket bracket P/N's 1010 and the Handlelok bracket P/N 1004.

- Molded from high quality materials
- Easy to use
- Weather, UV resistant
- Non-conductive
- Mounts several ways



**NFPA 1901
COMPLIANT**



10-12# SLEDGE HANGER/POCKET KIT

PAC

P/N K5010-12

STRAP COLORS (please specify)	BLACK YELLOW ORANGE
MOUNTING HARDWARE (INCLUDED)	FLAT SURFACES PAC TRAC
MOUNTING HARDWARE (OPTIONAL)	DUAL TRAC UNISTRUT 2019 UNISTRUT 2020
PRODUCT WT.	1.5 lbs.

The Sledge Hanger/Pocket Kit is designed to hold a 10-12lb. sledge hammer hanging OR supported as a pocket. Sledge Hanger Kit includes both the Sledge Hanger Pocket bracket P/N's 1010-12 and the Handlelok bracket P/N 1004.

- Molded from high quality materials
- Easy to use
- Weather, UV resistant
- Non-conductive
- Mounts several ways



**NFPA 1901
COMPLIANT**



Scan with your phone for Instructions!!



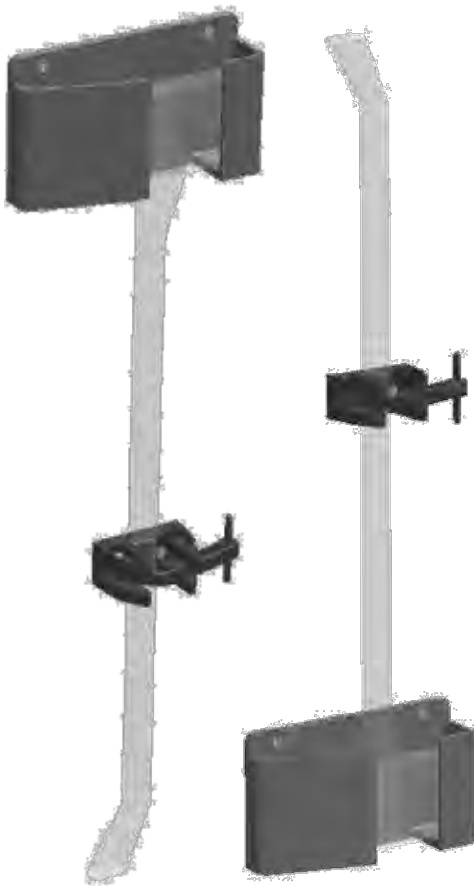

The Flathead Axe Hanger/Pocket Kit is designed to hold a Flathead Axe hanging OR supported as a pocket. The Flathead Axe Hanger/Pocket Kit includes the Flathead Axe Hanger/Pocket bracket P/N 1011 and the Handlelok bracket P/N 1004.

- Molded from high quality materials
- Easy to use
- Weather, UV resistant
- Non-conductive
- Mounts several ways



NFPA 1901
COMPLIANT

P/N K5011

STRAP COLORS (please specify)	BLACK YELLOW ORANGE
MOUNTING HARDWARE (INCLUDED)	FLAT SURFACES PAC TRAC
MOUNTING HARDWARE (OPTIONAL)	DUAL TRAC UNISTRUT 2019 UNISTRUT 2020
PRODUCT WT.	1.8 lbs.



The Pickhead Axe Hanger/Pocket Kit is designed to hold a Pickhead Axe hanging OR supported as a pocket. The Pickhead Axe Hanger/Pocket Kit includes the Pickhead Axe Hanger/Pocket bracket P/N 1012 and the Handlelok bracket P/N 1004.

- Molded from high quality materials
- Easy to use
- Weather, UV resistant
- Non-conductive
- Mounts several ways



NFPA 1901
COMPLIANT

P/N K5012

STRAP COLORS (please specify)	BLACK YELLOW ORANGE
MOUNTING HARDWARE (INCLUDED)	FLAT SURFACES PAC TRAC
MOUNTING HARDWARE (OPTIONAL)	DUAL TRAC UNISTRUT 2019 UNISTRUT 2020
PRODUCT WT.	2.2 lbs.



CUTTERS EDGE SAW KIT (NEW STYLE)

PAC

P/N K5025-N

STRAP COLORS (please specify)	BLACK YELLOW ORANGE
MOUNTING HARDWARE (INCLUDED)	FLAT SURFACES PAC TRAC
MOUNTING HARDWARE (OPTIONAL)	DUAL TRAC UNISTRUT 2019 UNISTRUT 2020
PRODUCT WT.	2.6 lbs.

For Cutters Edge Saws manufactured after 1999 - The saw is secured with a shoe for the trigger handle, Universal Mounts and an Adjustamount over the bar. This Kit can also be used for many other saw mounting applications.

- Molded from high quality materials
- High strength locking strap retains the saw bar and provides quick release
- Weather, UV resistant and Non-conductive

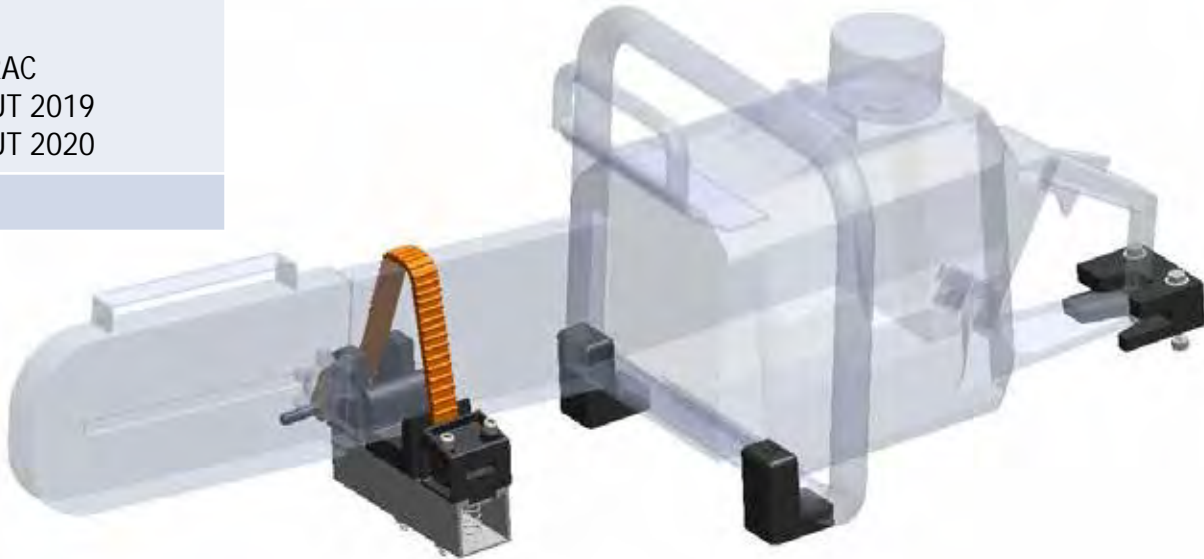

CUTTERS EDGE SAW KIT (OLD STYLE)

PAC

P/N K5025-O

STRAP COLORS (please specify)	BLACK YELLOW ORANGE
MOUNTING HARDWARE (INCLUDED)	FLAT SURFACES PAC TRAC
MOUNTING HARDWARE (OPTIONAL)	DUAL TRAC UNISTRUT 2019 UNISTRUT 2020
PRODUCT WT.	2.7 lbs.

The Cutters Edge Mounting Kit is designed to mount Cutters Edge saws. The saw is secured with a shoe for the trigger handle, Universal Mounts and an Adjustamount over the bar. This Kit can also be used for many other saw mounting applications.

- Molded from high quality materials
- High strength locking strap retains the saw bar and provides quick release
- Weather, UV resistant and Non-conductive
- P/N K5025-O for saws manufactured prior to 1999

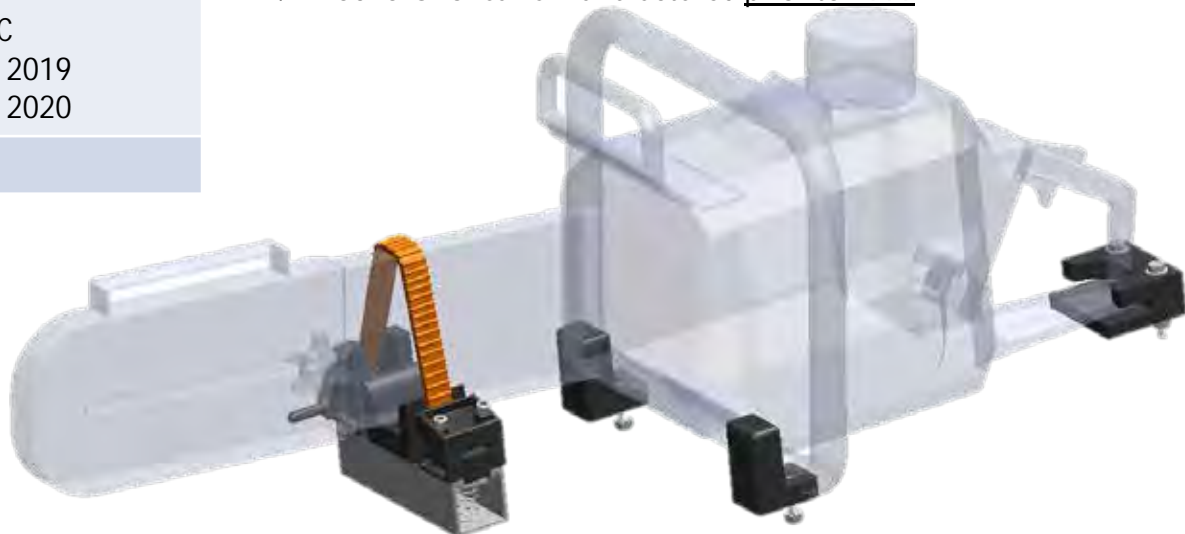

SECTION E



HEAVY RESCUE TOOL MOUNTING PRODUCTS

888-514-0083 TOLL FREE

WWW.PACTOOLMOUNTS.COM

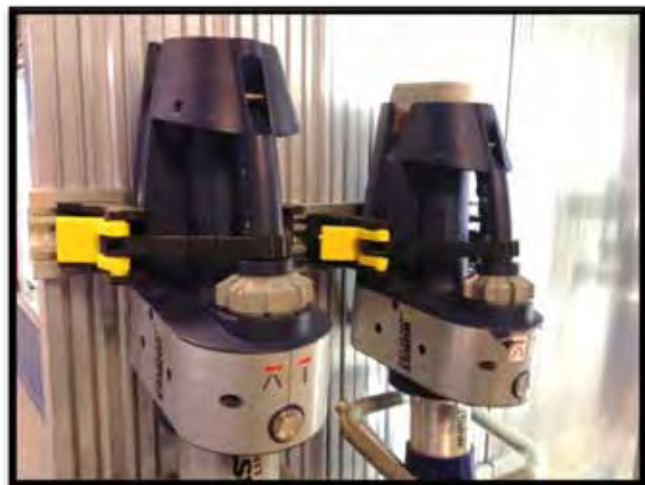



The Hookmount Kit provides the most secure hanging mount for spreaders and a variety of other tools and equipment. The Hook Mount Kit includes two Hook Mount brackets P/N 1029 and the Adjustamount Kit P/N K5006.

- Molded from high quality materials
- Easy to use
- Weather, UV resistant
- Impact resistant
- Non-conductive

P/N K5029	
STRAP COLORS (please specify)	BLACK YELLOW ORANGE
MOUNTING HARDWARE (INCLUDED)	FLAT SURFACES PAC TRAC
MOUNTING HARDWARE (OPTIONAL)	DUAL TRAC UNISTRUT 2019 UNISTRUT 2020
PRODUCT WT.	2.1 lbs.



Scan with your phone for Instructions!!

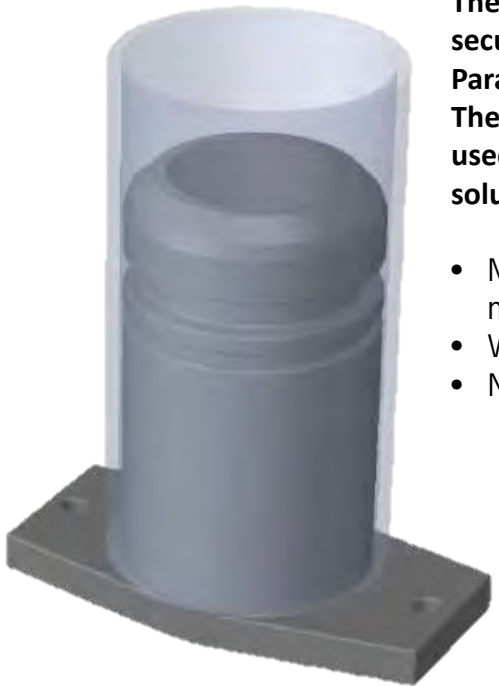

The Strut Base Mount provides a secured mounting base to hold Paratech struts and base mounts. The Strut Base Mount can also be used for many other mounting solutions.

- Molded from high quality materials
- Weather, UV resistant
- Non-conductive

P/N 2076	
BASE COLOR	BLACK
MOUNTING HARDWARE (INCLUDED)	FLAT SURFACES PAC TRAC
MOUNTING HARDWARE (OPTIONAL)	DUAL TRAC UNISTRUT 2019 UNISTRUT 2020
PRODUCT WT.	0.5 lbs.
DIMENSIONS	4.5" L x 2.4" W x 4.4" H

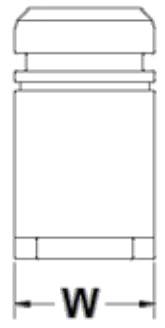
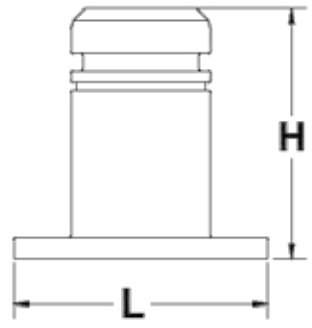



The Phoenix Tool Mounting Kit is specifically designed to provide a rugged, heavy-duty, secure mounting solution for the Phoenix Tools. This kit may also be used to mount similar tools and equipment. Kit includes Spreader Base pocket P/N 1026 and a Super Adjustamount Kit P/N K5050-1.

- Molded from high quality materials
- Flexible mounting positions
- Weather, UV resistant
- Non-conductive

P/N K5050-1PH

STRAP COLORS (please specify)	BLACK YELLOW ORANGE
MOUNTING HARDWARE (INCLUDED)	FLAT SURFACES PAC TRAC
MOUNTING HARDWARE (OPTIONAL)	DUAL TRAC UNISTRUT 2019 UNISTRUT 2020
PRODUCT WT.	3.5 lbs.



The Phoenix Ram Mounting Kit is specifically designed to provide a rugged, heavy-duty & secure mounting solution for the Phoenix Ram. This kit may also be used to mount similar tools and equipment. Kit includes three Universal Mounts P/N 1007 and a Super Adjustamount Kit P/N K5050.

- Molded from high quality materials
- Flexible mounting positions
- Weather, UV resistant
- Non-conductive

P/N K5050-2PH

STRAP COLORS (please specify)	BLACK YELLOW ORANGE
MOUNTING HARDWARE (INCLUDED)	FLAT SURFACES PAC TRAC
MOUNTING HARDWARE (OPTIONAL)	DUAL TRAC UNISTRUT 2019 UNISTRUT 2020
PRODUCT WT.	2.7 lbs.



DEALERS AND DISTRIBUTORS

PERFORMANCE ADVANTAGE COMPANY HAS A WORLD WIDE NETWORK OF DISTRIBUTORS AND DEALERS AVAILABLE TO MEET YOUR NEEDS.

PAC PRODUCTS ARE USED IN ALL 50 US STATES, CANADA AND THROUGHOUT THE WORLD. FOR A DEALER NEAR YOU, CONTACT US TOLL FREE AT 888-514-0083 OR VISIT US ON THE WEB AT WWW.PACTOOLMOUNTS.COM.

TECHNICAL QUESTIONS AND PRODUCT INFORMATION IS AVAILABLE VIA OUR WEBSITE 24-7 OR E-MAIL US AT INFO@PACTOOLMOUNTS.COM.



HEAVY RESCUE POCKET



P/N 1035

BASE COLOR	BLACK
MOUNTING HARDWARE (INCLUDED)	FLAT SURFACES PAC TRAC
MOUNTING HARDWARE (OPTIONAL)	DUAL TRAC
PRODUCT WT.	1.5 lbs.
DIMENSIONS	4.0"L x 10.3"W x 4.5 H

The Heavy Rescue Tool Mounting Pocket supports, locates and secures most all rescue tools including Cutters, Spreaders and Combi tools. See our new kits that pair our new 1035 Pocket with either of our K5020 Fast Lok or 1070 Jumbo Lok brackets. Your tools can be mounted vertically, horizontally or angled.

- Heavy duty construction
- Multiple mounting positions
- Mounts most spreaders, cutters and combi tools
- Weather, UV resistant
- Non-conductive

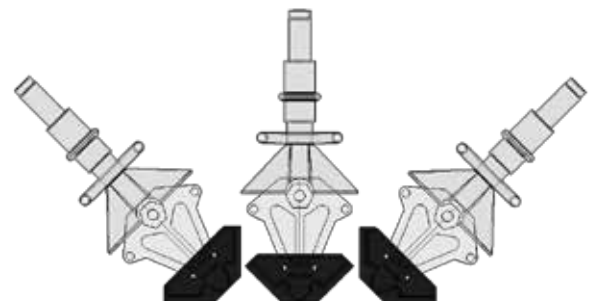
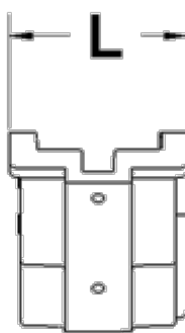
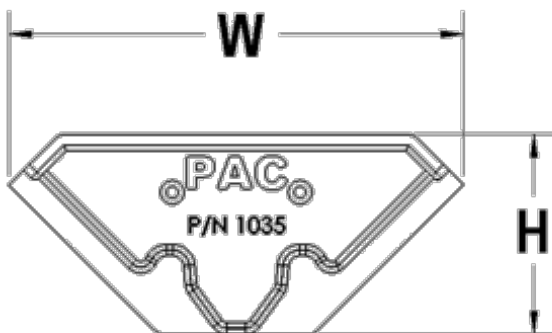



The Heavy Rescue Tool Mounting Kit with 1020 Fastlok supports, locates and secures most all rescue tools including Cutters, Spreaders and Combi tools. Works great with the eDraulic tools. Your tools can be mounted vertically, horizontally or angled.

- Heavy duty construction
- Multiple mounting positions
- Mounts most Heavy Rescue tools, even electric tools
- Weather, UV resistant
- Non-conductive

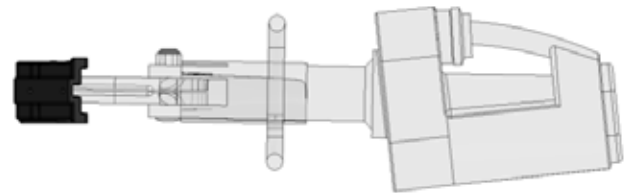

P/N K5035FL

STRAP COLORS (please specify)	BLACK YELLOW ORANGE
MOUNTING HARDWARE (INCLUDED)	FLAT SURFACES PAC TRAC
MOUNTING HARDWARE (OPTIONAL)	DUAL TRAC UNISTRUT 2019 UNISTRUT 2020
PRODUCT WT.	4.5 lbs.



The Heavy Rescue Tool Mounting Kit with 1070 Jumbo Lok supports, locates and secures most all rescue tools including Cutters, Spreaders and Combi tools. Your tools can be mounted vertically, horizontally or angled.

- Heavy duty construction
- Multiple mounting positions
- Mounts most Heavy Rescue tools
- Weather, UV resistant
- Non-conductive



P/N K5035JL

STRAP COLORS (please specify)	BLACK YELLOW ORANGE
MOUNTING HARDWARE (INCLUDED)	FLAT SURFACES PAC TRAC
MOUNTING HARDWARE (OPTIONAL)	DUAL TRAC UNISTRUT 2019 UNISTRUT 2020
PRODUCT WT.	2.5 lbs.

P/N 1026

BASE COLOR	BLACK
MOUNTING HARDWARE (INCLUDED)	FLAT SURFACES PAC TRAC
MOUNTING HARDWARE (OPTIONAL)	DUAL TRAC
PRODUCT WT.	1.1 lbs.
DIMENSIONS	3.1" L x 4.5" W x 3.0" H

The Spreader Base Pocket is designed to locate and support heavy duty rescue tools such as spreaders and combination tools. Use with Adjustamount Kit P/N 5006 or Super Adjustamount KIT P/N K5050 or Jumbo Lok P/N 1070.

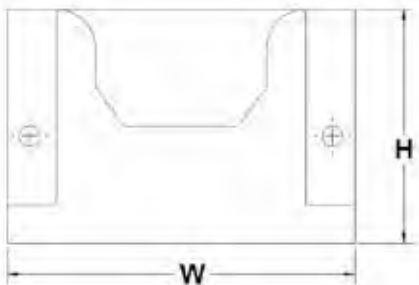

- Can be used to mount tool laying down or standing up
- Molded from high quality materials
- Weather, UV resistant
- Impact resistant
- Non-conductive

SOFT MOUNT

P/N 1080

BASE COLOR	BLACK
MOUNTING HARDWARE (INCLUDED)	FLAT SURFACES PAC TRAC
MOUNTING HARDWARE (OPTIONAL)	DUAL TRAC
PRODUCT WT.	2.2 lbs.
DIMENSIONS	5.0" L x 6.6" W x 5.0" H

The Soft Mount provides a cushioned load bearing base for many power tools and equipment. The Soft Mount works best when used with: Adjustamount Kit P/N 5006, Super Adjustamount KIT P/N K5050 & Jumbo Lok P/N 1070.

- Molded from high quality materials
- Elastomer pad is flexible and resistant to hydraulic fluids, water, fuel, and oils
- Weather, UV resistant
- Non-conductive
- Can be mounted to floor or wall

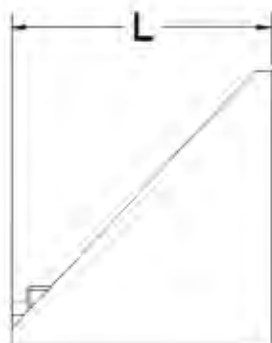
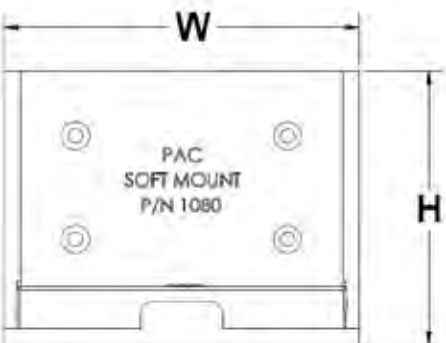



PERFORMANCE ADVANTAGE CO.

LAW ENFORCEMENT INSTALLATIONS

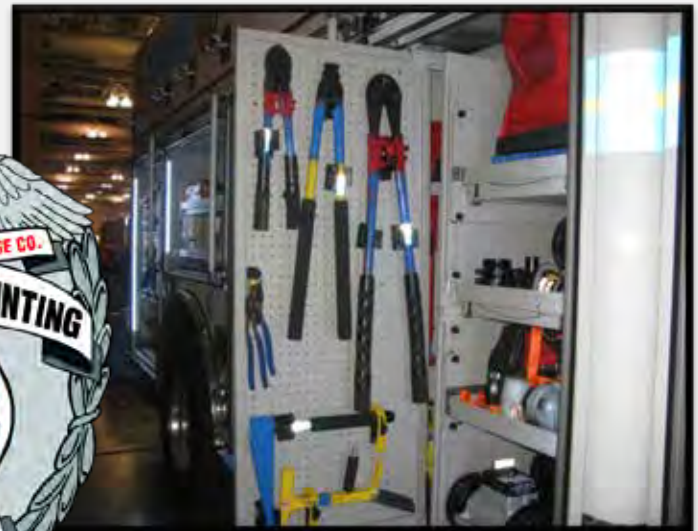
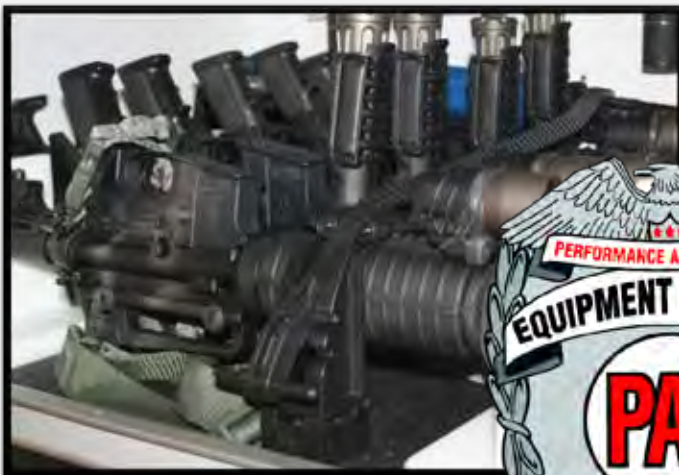



PERFORMANCE ADVANTAGE CO.

MILITARY INSTALLATIONS

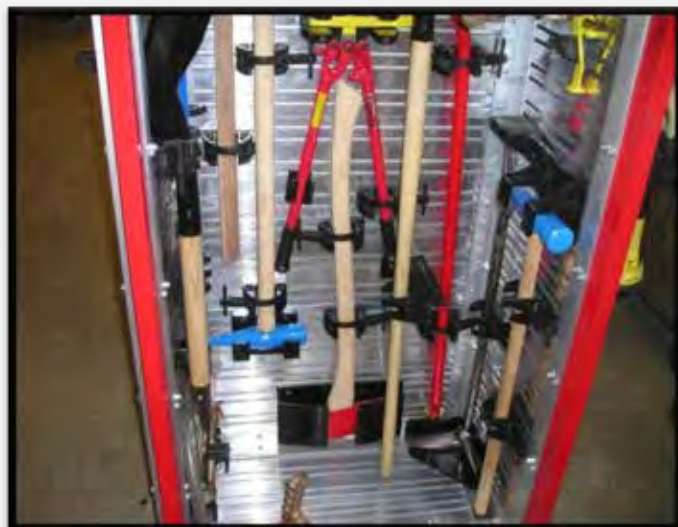

P/N K5026

STRAP COLORS (please specify)	BLACK YELLOW ORANGE
MOUNTING HARDWARE (INCLUDED)	FLAT SURFACES PAC TRAC
MOUNTING HARDWARE (OPTIONAL)	DUAL TRAC UNISTRUT 2019 UNISTRUT 2020
PRODUCT WT.	3.1 lbs.

The Spreader Base Pocket Kit is designed to locate and support heavy duty rescue tools such as spreaders and combination tools. Includes both the Spreader Pocket P/N 1026 and Adjustamount Kit P/N K5006.

- Can be used to mount your tool standing up or laying down
- Molded from high quality materials
- Weather, UV resistant
- Impact resistant
- Non-conductive



For some tool brands, you may want 1026 with either the 1070 or K5050. Contact PAC Sales for assistance with your application. Call 888-514-0083

P/N K5080

STRAP COLORS (please specify)	BLACK YELLOW ORANGE
MOUNTING HARDWARE (INCLUDED)	FLAT SURFACES PAC TRAC
MOUNTING HARDWARE (OPTIONAL)	DUAL TRAC UNISTRUT 2019 UNISTRUT 2020
PRODUCT WT.	3.2 lbs.

The Soft Mount Kit provides a cushioned load bearing base and supporting bracket for many power tools and equipment. Elastomer pad is flexible and resistant to hydraulic fluids, water, fuel, and oils. The Soft Mount Kit combines the Soft Mount P/N 1080 with the security of the Jumbo Lok's P/N 1070 9G rating and functionality.

- Molded from high quality materials
- Weather, UV resistant
- Non-conductive
- Can be mounted to floor or wall



With certain ram designs and styles, you may need 1080 with the K5050 in place of the Jumbo Lok. Contact PAC Sales for assistance with your application. Call 888-514-0083



The Amkus Mount Kit is designed specifically for the latest Amkus spreaders and cutters. Tools are secured in a vertical position for easy loading and removal. The Amkus Mount Kit includes a Amkus Manifold Mount P/N 4098 and Adjustamount Kit P/N K5006.

- Made for the AMK-24, AMK-22, AMK-21 & 21A models
- Molded from high quality materials
- Easy to use
- Weather, UV resistant
- Impact resistant
- Fast action instant release
- Non-conductive



P/N K5021	
STRAP COLORS (please specify)	BLACK YELLOW ORANGE
MOUNTING HARDWARE (INCLUDED)	FLAT SURFACES PAC TRAC
MOUNTING HARDWARE (OPTIONAL)	DUAL TRAC UNISTRUT 2019 UNISTRUT 2020
PRODUCT WT.	2.2 lbs.



The Amkus Cutter Mount Kit is designed for Amkus cutters. Tools are secured in a vertical position for easy loading and removal. The Amkus Cutter Mount Kit includes a Amkus Manifold Mount P/N 4097 and Adjustamount Kit P/N K5006.

- Molded from high quality materials
- Easy to use
- Weather, UV resistant
- Impact resistant
- Fast action instant release
- Non-conductive



P/N K5022	
STRAP COLORS (please specify)	BLACK YELLOW ORANGE
MOUNTING HARDWARE (INCLUDED)	FLAT SURFACES PAC TRAC
MOUNTING HARDWARE (OPTIONAL)	DUAL TRAC UNISTRUT 2019 UNISTRUT 2020
PRODUCT WT.	2.7 lbs.

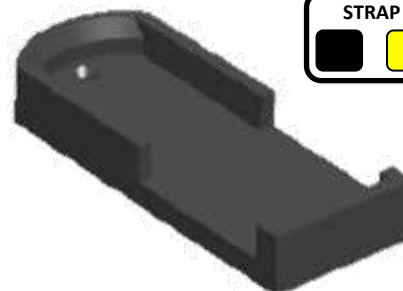

P/N K5023

STRAP COLORS (please specify)	BLACK YELLOW ORANGE
MOUNTING HARDWARE (INCLUDED)	FLAT SURFACES PAC TRAC
MOUNTING HARDWARE (OPTIONAL)	DUAL TRAC UNISTRUT 2019 UNISTRUT 2020
PRODUCT WT.	2.9 lbs.

The Amkus Ram Mount Kit is designed for Amkus Rams. Tools are secured in a vertical position for easy loading and removal. The Amkus Ram Mount Kit includes a Amkus Ram Base Mount P/N 4050 and Adjustamount Kit P/N K5006.

- Molded from high quality materials
- Easy to use
- Weather, UV resistant
- Impact resistant
- Fast action instant release
- Non-conductive

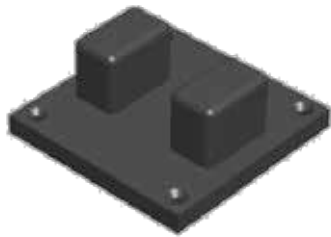

P/N K5024

STRAP COLORS (please specify)	BLACK YELLOW ORANGE
MOUNTING HARDWARE (INCLUDED)	FLAT SURFACES PAC TRAC
MOUNTING HARDWARE (OPTIONAL)	DUAL TRAC UNISTRUT 2019 UNISTRUT 2020
PRODUCT WT.	3.0 lbs.

The Amkus Spreader Mount Kit is designed for the latest Amkus spreaders. Tools are secured in a vertical position for easy loading and removal. The Amkus Mount Kit includes a Amkus Manifold Mount P/N 4097 and Adjustamount P/N K5006-1.

- Molded from high quality materials
- Easy to use
- Weather, UV resistant
- Impact resistant
- Fast action instant release
- Non-conductive



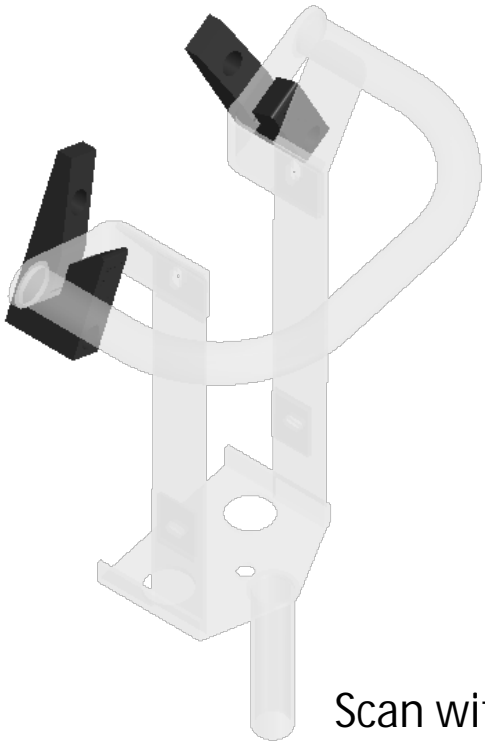

SOLD IN PAIRS - Frame Saddles are designed to hang power tool frames such as the Hurst JL24 TM and other equipment which utilize flat frame base handles.

Frame Saddles work best when used with the Adjustamount Kit P/N K5006 - included in Frame Saddle Kits P/N K5013.

- Molded from high quality materials
- Weather, UV resistant
- Impact resistant
- Non-conductive

Scan with your phone for Instructions!!



P/N 1013

BASE COLOR	BLACK
MOUNTING HARDWARE (INCLUDED)	FLAT SURFACES PAC TRAC
MOUNTING HARDWARE (OPTIONAL)	N/A
PRODUCT WT. DIMENSIONS	0.5 lbs. 2.0" L x 1.0" W x 4.5" H

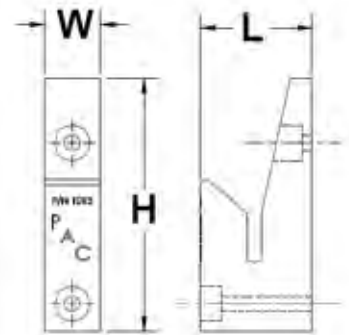

EXTENDED FRAME SADDLES



SOLD IN PAIRS – Extended Frame Saddles are elevated more than normal Frame Saddles.

Frame Saddles work best when used with the Adjustamount Kit P/N K5006 - included in Frame Saddle Kits P/N K5013-X.

- Molded from high quality materials
- Weather, UV resistant
- Impact resistant
- Non-conductive



P/N 1013-X

BASE COLOR	BLACK
MOUNTING HARDWARE (INCLUDED)	FLAT SURFACES PAC TRAC
MOUNTING HARDWARE (OPTIONAL)	N/A
PRODUCT WT. DIMENSIONS	0.9 lbs. 2.8" L x 1.0" W x 4.5" H

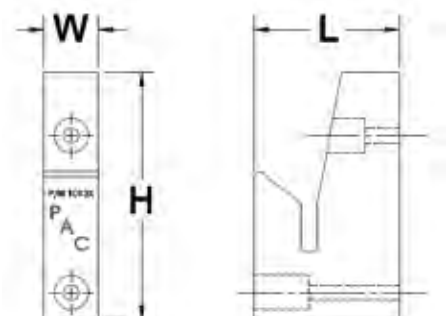

SECTION F

CYLINDER MATES & CYLINDER MATE CARTS



888-514-0083 TOLL FREE

WWW.PACTOOLMOUNTS.COM



30-45 MINUTE CYLINDER MATE



P/N CM6000

STRAP COLOR	YELLOW
MOUNTING HARDWARE (INCLUDED)	FLAT SURFACES
PRODUCT WT. DIMENSIONS	9.5 lbs. 24.5"L x 8.0"W x 8.0"H

The Cylinder Mate securely stores and protects 30 and 45 minute SCBA cylinders. The Cylinder Mate self-centers the air cylinder producing safe and secure storage from impact in any direction.

- Holds 30 min. bottles up to 24" in length
- Molded from high quality materials
- High strength locking strap retains the air cylinder with a simple to use latching and removal process
- Weather, UV resistant
- Non-conductive
- Matching mounting holes allow individual Cylinder Mates to form storage units
- Pressure can be read while contained
- Empty cylinders can be safely stored and removed when installed backwards

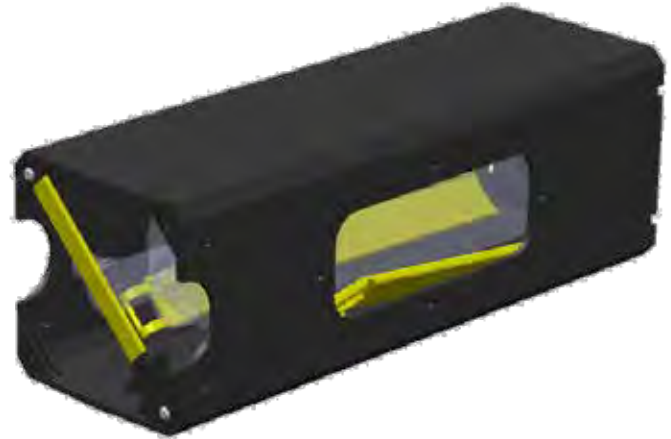
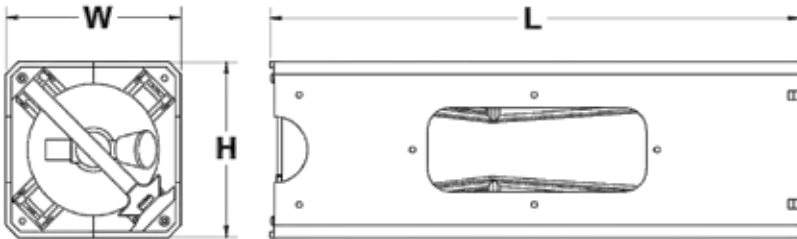

For 45 min. from 24" to 25" purchase optional strap CM-20

60 MINUTE CYLINDER MATE



P/N CM6060

STRAP COLOR	RED
MOUNTING HARDWARE (INCLUDED)	FLAT SURFACES
PRODUCT WT. DIMENSIONS	10.0 lbs. 24.5"L x 8.0"W x 8.0"H

The Cylinder Mate 60 securely stores and protects 60 minute SCBA cylinders. The Cylinder Mate self-centers the air cylinder producing safe and secure storage from impact in any direction.

- Holds 60 min. bottles from 25" to 26" in length
- Molded from high quality materials
- High strength locking strap retains the air cylinder with a simple to use latching and removal process
- Weather, UV resistant
- Non-conductive
- Matching mounting holes allow individual Cylinder Mates to form storage units
- Pressure can be read while contained
- Empty cylinders can be safely stored and removed when installed backwards

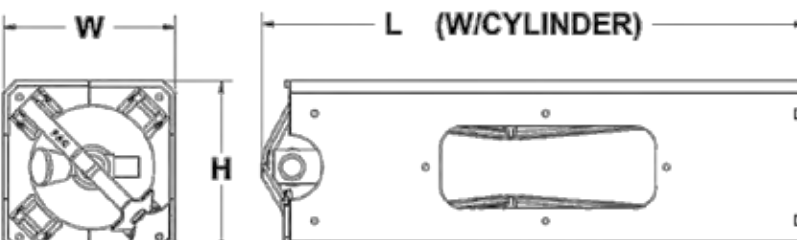



**NFPA 1901
COMPLIANT**

**P/N CM6000-12 &
CM6060-12**

STRAP COLOR	YELLOW (CM6000-12) RED (CM6060-12)
WHEEL DIAMETER	8"
PRODUCT WT. DIMENSIONS	155 lbs. (CM6000-12) 161 lbs (CM6060-12) 24.5"Lx24.0"Wx45.0"H

The Cylinder Mate Mobile Storage Units are assembled from individual Cylinder Mates. Standard units of 12 & 16 are available. Mobile units allow air cylinders to moved or relocated easily for transfer or filling.

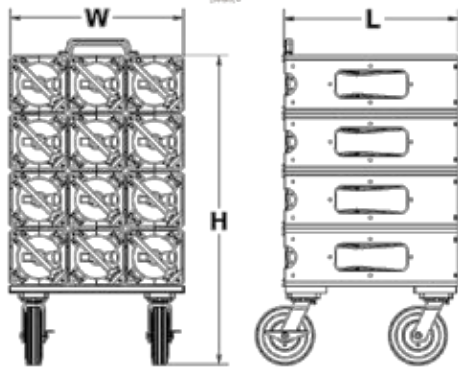

- Heavy duty pneumatic wheels with locks on front wheels
- Up to 300lb capacity
- Pull handle for easy control
- P/N CM6000-12 (30-45min cylinders)
- P/N CM6060-12 (60min cylinders)
- Empty cylinders can be safely stored and removed when installed backwards with new design



**NFPA 1901
COMPLIANT**

**P/N CM6000-16 &
CM6060-16**

STRAP COLOR	YELLOW (CM6000-16) RED (CM6060-16)
WHEEL DIAMETER	8"
PRODUCT WT. DIMENSIONS	201 lbs. (CM6000-16) 209 lbs (CM6060-16) 24.5"Lx32.0"Wx45.0"H

The Cylinder Mate Mobile Storage Units are assembled from individual Cylinder Mates. Standard units of 12 & 16 are available. Mobile units allow air cylinders to moved or relocated easily for transfer or filling.

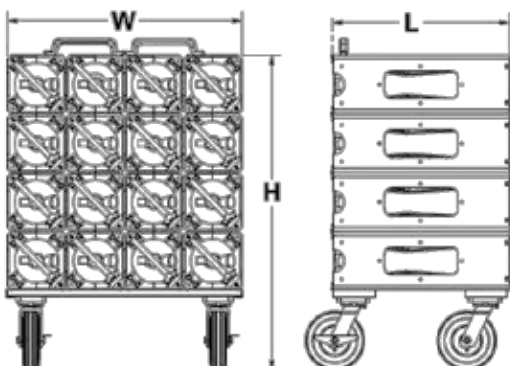

- Heavy duty pneumatic wheels with locks on front wheels
- Up to 300lb capacity
- 2 Pull handles for easy control
- P/N CM6000-16 (30-45min cylinders)
- P/N CM6060-16 (60min cylinders)
- Empty cylinders can be safely stored and removed when installed backwards with new design



PERFORMANCE ADVANTAGE CO.

UTILITY INSTALLATIONS

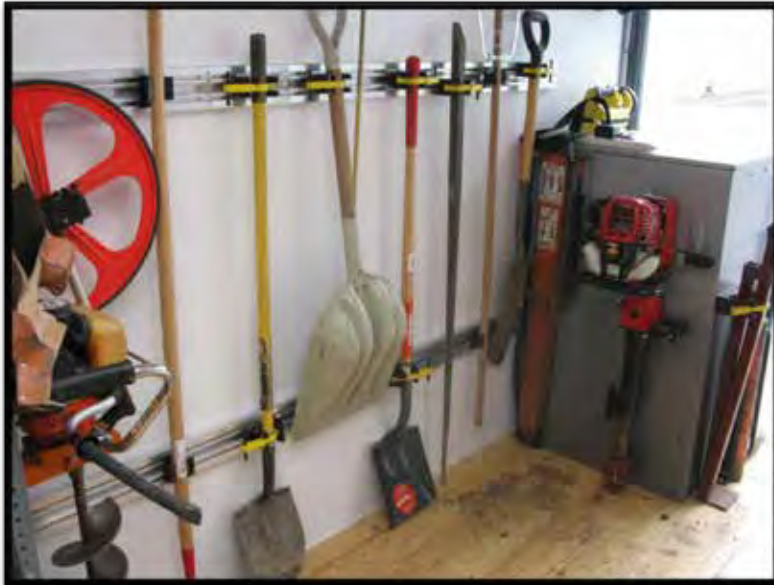

SECTION G

ADDITIONAL MOUNTING PRODUCTS & ACCESSORIES



888-514-0083 TOLL FREE

WWW.PACTOOLMOUNTS.COM



ADJUSTAMOUNT PAC TRAC ADAPTER

PAC

P/N 6008

BASE COLOR	BLACK
MOUNTING HARDWARE (INCLUDED)	PAC TRAC
DIMENSIONS	0.8"Lx1.5"Wx1.5"H

The **ADJUSTAMOUNT PT ADAPTER P/N 6008** allows Adjustamount to be fastened directly to PAC TRAC without using unistrut.

- Molded from high quality materials
- Weather, UV resistant
- Non-conductive
- Sold in Pairs

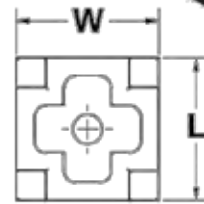
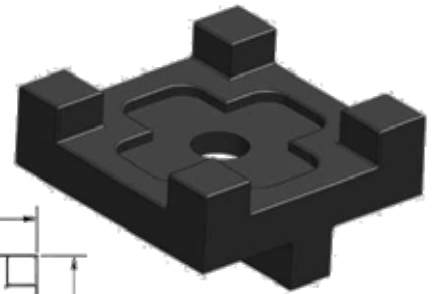

Note: P/N 6008 is included in bracket P/Ns 1006-PT & 1008-PT.

SUPER ADJUSTAMOUNT SPACER BLOCK

PAC

P/N 1006-4

BASE COLOR	BLACK
MOUNTING HARDWARE (INCLUDED)	LONGER BOLT INCLUDED
DIMENSIONS	2.0"Lx1.9"Wx1.5"H

The **SUPER ADJUSTAMOUNT SPACER BLOCK P/N 1006-4** adds additional height to the Super Adjustamount bracket.

- Allows more grip height for taller tools
- Allows more clearance for hand-release against mounting surface
- Molded from high quality materials
- Weather, UV resistant
- Non-conductive
- Sold INDIVIDUALLY

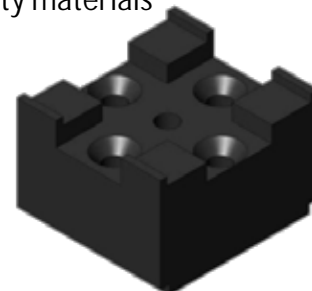
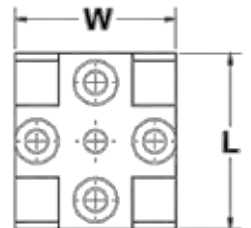

CYLINDER MATE STRAP

PAC

P/N CM-20

STRAP COLOR	YELLOW
MOUNTING HARDWARE (INCLUDED)	N/A
DIMENSIONS	9.1" L x 0.3" W x 2.4" H

The **CYLINDER MATE STRAP, P/N CM-20** is a longer strap for the CM6000 CYLINDER MATE. Using the optional strap CM-20 may be necessary on certain 45 minute bottles with longer overall length than normal.

- Holds 30 or 45 min. bottles between 24" and 25"
- Molded from high quality materials
- Weather, UV resistant
- Non-conductive



Commonly used to mount various tools and other systems, Unistrut is a support system which can be supplied in various lengths. PAC supplies this product in Aluminum for easy installation and corrosion resistance.

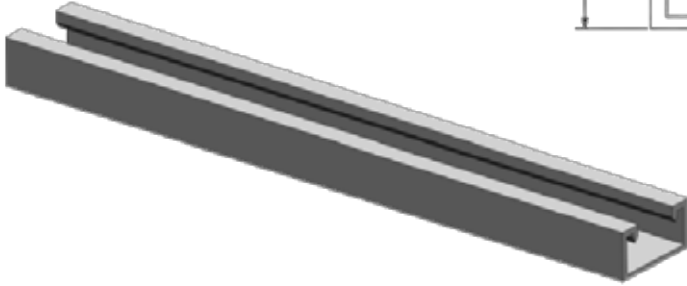
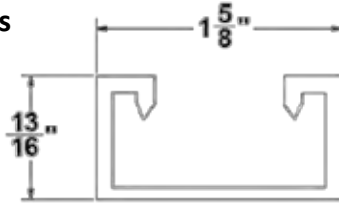

P/N 2019

MATERIAL	ALUMINUM
THICKNESS	.078"
PRODUCT WT. DIMENSIONS	.45 lbs/ft 1-5/8" W X 13/16" H

- Shallow channel
- Corrosion resistant
- Plain back
- Use with steel channel nuts **2010**
- Available by the inch up to 120" max

P1000 is also a commonly used Unistrut framing channel. PAC supplies this product in Aluminum for easy installation and corrosion resistance.

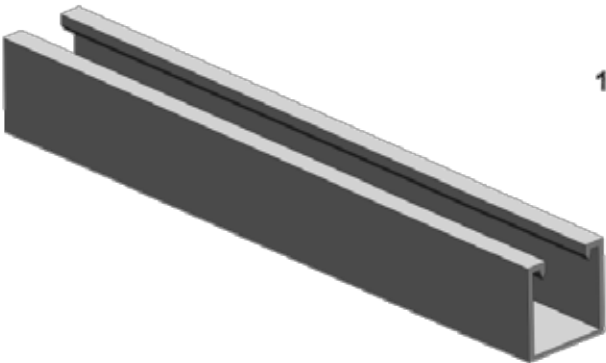
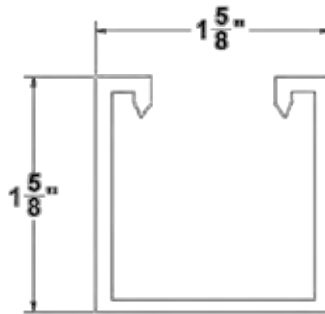

P/N 2020

MATERIAL	ALUMINUM
THICKNESS	.109"
PRODUCT WT. DIMENSIONS	.76 lbs/ft 1-5/8" W X 1-5/8" H

- Deep channel
- Corrosion resistant
- Plain back
- Use with steel channel nuts **2018**
- Available by the inch up to 120" max

The UNISTRUT CHANNEL CUSHION provides insulation and a firm bottom grip between the mounted object and Unistrut.

NOTE: CUSTOM LENGTHS ARE AVAILABLE.

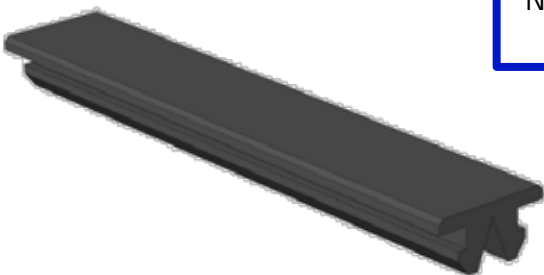

P/N 1006-3

BASE COLOR	BLACK
LENGTH	8.25" +/- .125
DIMENSIONS	1-5/8" W X 3/4" H

- Works with PAC Unistrut 2019 & 2020
- Tough 3/16" thick flange
- Molded for extreme long life
- Easily snaps in place
- Sold individually

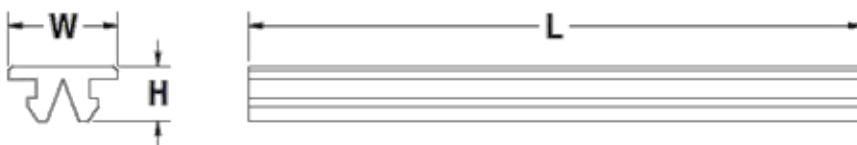

PAC TRAC RIGHT ANGLE CORNER CONNECTOR

PAC

P/N 3018

MATERIAL	ALUMINUM
MOUNTING HARDWARE (INCLUDED)	PAC TRAC
MOUNTING HARDWARE (OPTIONAL)	DUAL TRAC
DIMENSIONS	2.8" L x 1.5" W x 1.5" H

The PAC TRAC RIGHT ANGLE CORNER CONNECTOR quickly connects corners, sides and bottom sections of the entire PAC TRAC extrusion family. and a firm bottom grip between the mounted object and Unistrut.

- Works with entire PAC TRAC family
- 1/8" thick anodized aluminum for corrosion resistance
- Sold INDIVIDUALLY

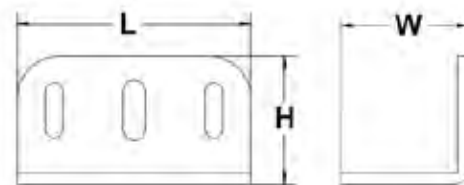

DUAL TRAC SHELF MOUNT

PAC

P/N 3021

BASE COLOR	BLACK
MOUNTING HARDWARE (INCLUDED)	DUAL TRAC
DIMENSIONS	3.0" L x 1.0" W x 1.1" H

The DUAL TRAC SHELF MOUNT provides a right angle connection and shelf support. P/N 3021 also provides a fast and easy way to mount sheet metal shelving. Note: P/N 3021 only compatible with DUAL TRAC, MINI DUAL and DOUBLE DUAL TRAC.

- Works only with PAC DUAL, MINI DUAL AND DOUBLE DUAL TRAC
- Durable, non-corrosive
- Installs easily
- Sold INDIVIDUALLY

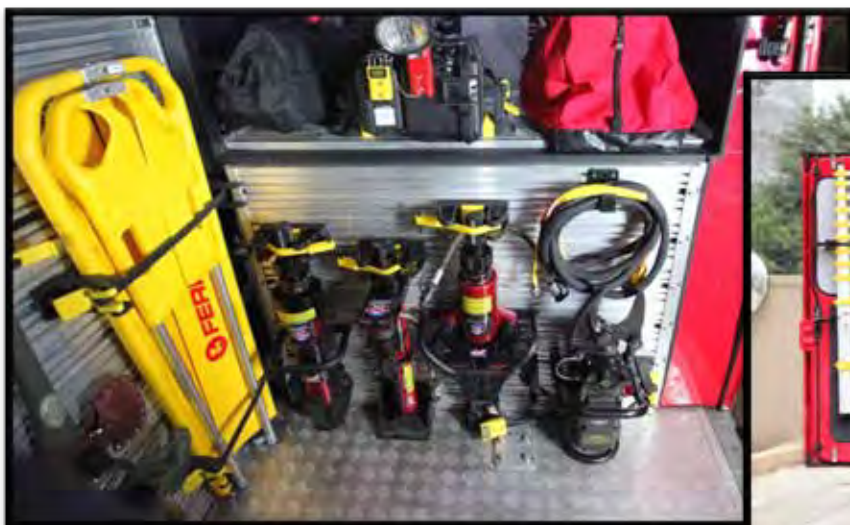
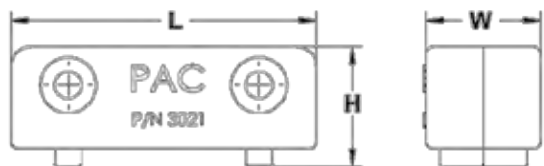

PAC's TRACKLOK INSERTS hold brackets to our entire PAC TRAC family of extrusions. These Patented inserts expand and lock in the tracks when the included screws are tightened. TRACLOK INSERTS are tough and durable. Loosen the screws and the TRACLOK INSERTS can be moved or removed.

- Works with entire PAC TRAC family
- Durable, non-corrosive
- Installs easily
- Remove, reuse and reposition easily
- Includes 40 Tracklok Inserts and 40 assorted screws

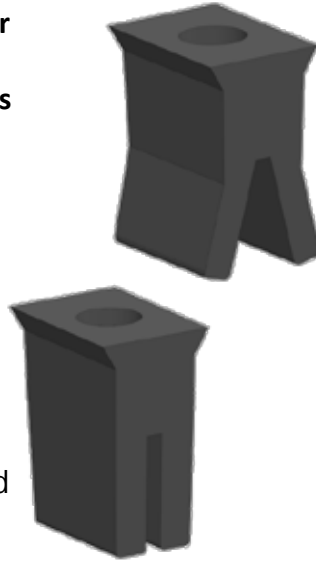

P/N 7002	
SCREW SIZE	10-24
MATERIAL	PAC NYLON
MOUNTING HARDWARE (INCLUDED)	PAC TRAC

These CHANNEL NUTS hold brackets to our DUAL TRAC extrusions. These inserts lock in the tracks when the screw is tightened. Loosen the screws and the CHANNEL NUTS can be moved or removed.

- Durable, non-corrosive
- Installs easily
- Remove, reuse and reposition easily

1) Also available in Stainless Steel – order PAC P/N 3014

	P/N 3023	P/N 3024	P/N 2023
SCREW SIZE	10-24	1/4-20	1/4-20
MATERIAL	PAC NYLON	PAC NYLON	GALVANIZED STEEL ¹
MOUNTS TO	DUAL TRAC UNISTRUT 3020	DUAL TRAC UNISTRUT 3020	DUAL TRAC UNISTRUT 3020
			

PAC's STEEL CHANNEL NUTS hold PAC brackets to UNISTRUT. These inserts lock in the tracks when the screw is tightened. Loosen the screws and the CHANNEL NUTS can be moved or removed.

- Corrosion resistant galvanized steel
- Installs easily
- Remove, reuse and reposition easily

P/N 2010	
SCREW SIZE	1/4-20
MATERIAL	GALVANIZED STL.
MOUNTS TO	UNISTRUT 2019



P/N 2018	
SCREW SIZE	1/4-20
MATERIAL	GALVANIZED STL.
MOUNTS TO	UNISTRUT 2020





PERFORMANCE ADVANTAGE CO.

HARDWARE GUIDE

PAC P/N	HARDWARE	PAC P/N	HARDWARE	PAC P/N	HARDWARE
1001	7030	1026	7048 / 7034	K5010	2034 / 7021 / 7023
1002	7028	1027	7025	K5010-12	2032 / 2034 / (2)7021 / 7023
1002-2	7028	1029	7022	K5011	2034 / 7021 / 7023
1003	7031	1040-4	7031	K5012	2034 / 7021 / 7023
1004	2032 / 7023	1040-5	7031	K5019	2032 / 2034 / (2)7021 / 7023
1005	7028	1040-6	7031	K5021	2032 / 2035 / 7029
1005-S	7028	1042-1	7046	K5022	2033 / 2035 / 7026 / 7029
1006-1	2035 / 7029	1042-2	7046	K5023	2034 / 7027 / 7029
1006-2	2035 / 7029	1042-D	7046	K5024	2033 / 2035 / 7026 / 7029
1006-1A	2035 / 7029	1070	7042	K5025-O	2035 / 7029 / (2)7051 + additional hardware
1006-1B	2035 / 7029	1080	2034 / (2)7021	K5025-N	2035 / 7029 / (2)7051 + additional hardware
1007	7051	2076	7048 / 7033	K5026	2035 / 7048 / 7029 / 7034
1009	2032 / 7021	3018	7003 & optional hardware	K5029	2035 / (2)7022 / 7029
1010	2032 / 7021	3021	7047	K5030	2035 / 7029 / (2)7051
1010-12	2034 / (2) 7021	K5003	2035 / 7029 + additional hardware	K5032	2034 / 7027
1011	2032 / 7021	K5005	(2) 7028	K5050	2035 / 7029
1012	2032 / 7021	K5005S	(2) 7028	K5050-1	2035 / 7029
1013	7032	K5006	2035 / 7029	K5050-1PH	(2)2035 / (2)7029
1013-X	Loose hardware	K5006-1	2035 / 7029	K5050-2PH	2035 / 7029 / (3)7051
1016	7028	K5008	2035 / 7029	K5060	2035 / 7029
1017	7028	K5008-1	2035 / 7029	K5060-1	2035 / 7029
1019	2032 / 7021	K5009	2034 / 7021 / 7023	K5080	2034 / (2)7021 / 7042

Note: 7001-1 to -8 use (1 to 8) 7003
 7001 uses (1) 7008
 7001D-1 to -10 use (1 to 10) 7006
 7001-MD-1 uses (1) 7006
 7001D uses (1) 7011

7009-1 to -10 uses (1 to 10) 7014

PAC TOOL MOUNTING BRACKETS

1001	HOOKLOKS (SOLD IN PAIRS)	29.95
1002	FLEXMOUNT - STANDARD	30.95
1002-2	FLEXMOUNT - SHORT STEM	30.95
1003	TOOLOK	21.95
1004	HANDLELOK	36.95
1005	STOW 'N LOK	39.95
1005S	STOW 'N LOK SHORT	39.95
1006	ADJUSTAMOUNT	43.95
1006-1	12" UNISTRUT - P4000	7.95
1006-2	24" UNISTRUT - P4000	13.95
1006-3	9" CHANNEL CUSHION	6.95
1006-4	ADJUSTAMOUNT / SAM SPACER	7.95
1007	UNIVERSAL MOUNT	11.95
1008	EXTENDED ADJUSTAMOUNT	54.95
1009	TOOL HANGER	33.95
1010	8# SLEDGE HANGER / POCKET	41.95
1010-12	10# & 12# SLEDGE HANGER / POCKET	49.95
1011	FLATHEAD AXE HANGER / POCKET	74.95
1012	PICKHEAD AXE HANGER / POCKET	101.95
1013	FRAME SADDLES (SOLD IN PAIRS)	36.95
1013-X	ELEVATED FRAME SADDLES (SOLD IN PAIRS)	44.95
1016	SPANNER WRENCH MOUNT	40.95
1017	HYDRANT WRENCH MOUNT	52.95
1019	UNIVERSAL HANGER	17.95
1026	SPREADER BASE POCKET	45.95
1027	LOOP HOOK	14.95
1028	GM - HOOK	11.95
1029	HOOK MOUNT	17.95
1035	HEAVY RESCUE BASE MOUNT POCKET	104.95
1040-4	STORZ LOK 4" MOUNT	42.95
1040-5	STORZ LOK 5" MOUNT	49.95
1040-6	STORZ LOK 6" MOUNT	74.95
1042-1	1.5" ADAPTER LOK	42.95
1042-2	2.5" ADAPTER LOK	45.95
1042-D	2.5" DUAL ADAPTER LOK	63.95
1050	SUPER ADJUSTAMOUNT	56.95
1060	EXT. SUPER ADJUSTAMOUNT	67.95
1070	JUMBO LOK	62.95
1080	SOFT MOUNT	103.95
2076	STRUT BASE MOUNT	30.95

ADDITIONAL PAC PRODUCTS

CM6000	CYLINDER MATE - STANDARD LENGTH STRAP	182.95
CM6001	CYLINDER MATE - EXTENDED LENGTH STRAP	193.95
CM6000-12	CYLINDER MATE - MOBILE UNIT (12 PACK)	1,797.95
CM6000-16	CYLINDER MATE - MOBILE UNIT (16 PACK)	2,279.95
CM6060	CYLINDER MATE - 60 MINUTE	249.95
CM 6060-12	CYLINDER MATE - 60 MINUTE (12 PACK)	1,997.95
CM 6060-16	CYLINDER MATE - 60 MINUTE (16 PACK)	2,644.95
SMP-15F	1.5" DOUBLE FEMALE MOUNT	29.95
SMP-15M	1.5" DOUBLE MALE MOUNT	29.95
SMP-25F	2.5" DOUBLE FEMALE MOUNT	31.95
SMP-25M	2.5" DOUBLE MALE MOUNT	31.95
SMP-40	4" X 4" HORIZONTAL MOUNT	70.95
SMP-40-6	4" X 6" HORIZONTAL MOUNT	94.95
SEN-PL15	1.5" VERTICAL POST MOUNT	23.95
SEN-PL25	2.5" VERTICAL POST MOUNT	27.95
RMP4904AC	1.5" SCREW PLATE	37.95
RMP4906AC	2.5" SCREW PLATE	42.95
RMP4908AC	3" SCREW PLATE	192.95
RMP4909AC	3.5" SCREW PLATE	123.95
RMP4912AC	4.5" SCREW PLATE	122.95

PAC TOOL MOUNTING KITS

K5003	IRONSLOK KIT	229.95
K5005	STOW-N-LOK KIT STANDARD STEM (SOLD IN PAIRS)	77.95
K5005S	STOW-N-LOK KIT SHORT STEM (SOLD IN PAIRS)	77.95
K5006	ADJUSTAMOUNT KIT	54.95
K5008	EXTENDED ADJUSTAMOUNT KIT	65.95
K5009	TOOL HANGER KIT	70.95
K5010	8# SLEDGE HANGER / POCKET KIT	76.95
K5010-12	10# & 12# SLEDGE HANGER / POCKET KIT	80.95
K5011	FLATHEAD AXE HANGER / POCKET KIT	109.95
K5012	PICKHEAD AXE HANGER / POCKET KIT	135.95
K5013	FRAME SADDLE KIT	86.95
K5013-X	ELEVATED FRAME SADDLE KIT	94.95
K5018	MULTI-MOUNT KIT	171.95
K5019	UNIVERSAL HANGER KIT	74.95
K5020	FASTLOK ADJUSTAMOUNT KIT	119.95
K5020L	FASTLOK ADJUSTAMOUNT KIT EXTENDED	134.95
K5021	AMKUS KIT / UNIVERSAL BASE - NEW MODELS	149.95
K5022	AMKUS CUTTER MOUNTING KIT	155.95
K5023	AMKUS RAM MOUNTING KIT	160.95
K5024	AMKUS SPREADER MOUNTING KIT	158.95
K5025-N	CUTTERS EDGE MOUNTING KIT (1999 and newer)	168.95
K5025-O	CUTTERS EDGE MOUNTING KIT (Pre 1999 models)	164.95
K5026	SPREADER BASE MOUNT KIT	94.95
K5029	HOOK MOUNT KIT (HOLMATRO)	85.95
K5030	RESCUE SAW KIT	124.95
K5032	HALLIGAN TOOL MOUNTING KIT	103.95
K5035FL	HEAVY RESCUE TOOL MOUNTING KIT (FASTLOK)	224.95
K5035JL	HEAVY RESCUE TOOL MOUNTING KIT (JUMBO LOK)	169.95
K5050	SUPER ADJUSTAMOUNT KIT	67.95
K5050-1	HD SUPERADJUSTAMOUNT KIT / P1000 UNISTRUT	70.95
K5050-1PH	PHOENIX TOOL MOUNTING KIT	113.95
K5050-2PH	PHOENIX RAM MOUNTING KIT	103.95
K5060	EXTENDED SUPER ADJUSTAMOUNT KIT	81.95
K5060-1	HD EXT. SUPER ADJUSTAMOUNT KIT / P1000 UNISTRUT	83.95
K5080	SOFT MOUNT KIT	149.95

PAC TRAC AND FRAME MOUNTS

7000	PAC TRAC - 120" LENGTH	209.95
7000-70	PAC TRAC - 70" LENGTH	128.95
7000-50	PAC TRAC - 50" LENGTH	91.95
7001	Z-MOUNT - 120 3/4" LENGTH	69.95
7001-1	Z-MOUNT FOR PAC TRAC 1 SECTION	9.95
7001-2	Z-MOUNT FOR PAC TRAC 2 SECTION	19.95
7001-3	Z-MOUNT FOR PAC TRAC 3 SECTION	29.95
7001-4	Z-MOUNT FOR PAC TRAC 4 SECTION	39.95
7001-5	Z-MOUNT FOR PAC TRAC 5 SECTION	48.95
7001-6	Z-MOUNT FOR PAC TRAC 6 SECTION	58.95
7001-7	Z-MOUNT FOR PAC TRAC 7 SECTION	68.95
7001-8	Z-MOUNT FOR PAC TRAC 8 SECTION	77.95
7020	PAC DUAL TRAC - 120" LENGTH	150.95
7020-70	PAC DUAL TRAC - 70" LENGTH	92.95
7020-50	PAC DUAL TRAC - 50" LENGTH	66.95
7001-D	Z MOUNT - 120 3/4" LENGTH	69.95
7001D-1	Z-MOUNT FOR DUAL TRAC 1 SECTION	9.95
7001D-2	Z-MOUNT FOR DUAL TRAC 2 SECTION	20.95
7001D-3	Z-MOUNT FOR DUAL TRAC 3 SECTION	29.95
7001D-4	Z-MOUNT FOR DUAL TRAC 4 SECTION	39.95
7001D-5	Z-MOUNT FOR DUAL TRAC 5 SECTION	50.95
7001D-6	Z-MOUNT FOR DUAL TRAC 6 SECTION	63.95
7001D-7	Z-MOUNT FOR DUAL TRAC 7 SECTION	71.95
7001D-8	Z-MOUNT FOR DUAL TRAC 8 SECTION	79.95
7001D-9	Z-MOUNT FOR DUAL TRAC 9 SECTION	90.95
7001D-10	Z-MOUNT FOR DUAL TRAC 10 SECTION	100.95
7040	DOUBLE FACED DUAL TRAC - 120" LENGTH	304.95
7040-70	DOUBLE FACED DUAL TRAC - 70" LENGTH	181.95
7040-50	DOUBLE FACED DUAL TRAC - 50" LENGTH	129.95
7009-1	U-CHANNEL FOR DOUBLE DUAL TRAC 1 SECTION	20.95
7009-2	U-CHANNEL FOR DOUBLE DUAL TRAC 2 SECTION	44.95
7009-3	U-CHANNEL FOR DOUBLE DUAL TRAC 3 SECTION	63.95
7009-4	U-CHANNEL FOR DOUBLE DUAL TRAC 4 SECTION	83.95
7009-5	U-CHANNEL FOR DOUBLE DUAL TRAC 5 SECTION	104.95
7009-6	U-CHANNEL FOR DOUBLE DUAL TRAC 6 SECTION	123.95

** CUSTOM MADE SWING OUT AND PULL OUT BOARDS AVAILABLE - ALMOST ANY SIZE -CALL FOR QUOTE

7050	PAC MINI-DUAL TRAC - 120" LENGTH	102.95
7050-70	PAC MINI-DUAL TRAC - 70" LENGTH	63.95
7050-50	PAC MINI-DUAL TRAC - 50" LENGTH	41.95
7001-MD-1	Z MOUNT - FOR 1 RAIL OF MINI-DUAL TRAC	9.95
7012-MD-1	J MOUNT - FOR 1 RAIL OF MINI-DUAL TRAC	17.95
CUTFEE	CUSTOM CUT FEE (PER SECTION OF ALUMINUM)	2.50
VSO-18	18" DEEP VERT. SLIDE HARDWARE KIT (R or L Hand)	365.95
VSO-24	24" DEEP VERT. SLIDE HARDWARE KIT (R or L Hand)	365.95
HSO-18	18" DEEP HORIZ. SLIDE HARDWARE KIT	379.95
HSO-24	24" DEEP HORIZ. SLIDE HARDWARE KIT	379.95
VSOB-18	18" DEEP BASE MT. VERT. SLIDE HARDWARE KIT	TBD
VSOB-24	24" DEEP BASE MT. VERT. SLIDE HARDWARE KIT	TBD
PM1000	SWING OUT TOOLBOARD HARDWARE KIT	278.95
PMF-5	UPPER FRAME RAIL KIT - UP TO 50" COMPARTMENT	114.95
PMF-7	UPPER FRAME RAIL KIT - UP TO 70" COMPARTMENT	136.95

PAC TRAC ACCESSORIES

PM-1000	SWING OUT PIVOT MOUNT KIT	278.95
1006-4	SUPER ADJUSTAMOUNT SPACER BLOCK	7.95
2010	1/4-20 CHANNEL NUT/SHORT SPRING	1.69
2018	1/4-20 CHANNEL NUT/LONG SPRING	1.69
2023	1/4-20 SMALL CHANNEL NUT	2.09
3018	PT CORNER CONNECTOR	15.95
3021	DUAL TRAC SHELF MOUNT	18.95
3023	10-24 NYLON CHANNEL NUT (FOR DUAL TRAC)	0.85
3024	1/4-20 NYLON CHANNEL NUT	0.85
6008	ADJUSTAMOUNT PAC TRAC ADAPTER	1.95
7002	TRAC LOK PAK - 40 INSERTS & SCREWS	16.95
7002-ALF	TRAC LOK PAK - 100 INSERTS (NO SCREWS)	19.95

**Contact PAC for more information
on volume and dealer pricing!
888-514-0083**

SECTION P

ALUMINUM PAC TRAC PRODUCTS



888-514-0083 TOLL FREE

WWW.PACTOOLMOUNTS.COM

CONTENTS		
PRODUCT	PART #	PAGE
PAC TRAC OVERVIEW		P-2
PAC TRAC	7000	P-4
DUAL TRAC	7020	
MINI DUAL TRAC	7050	
Z MOUNT (PAC TRAC)	7001-	P-5
Z MOUNT (DUAL TRAC)	7001D-	
Z MOUNT (MINI DUAL TRAC)	7001-MD-1	
DOUBLE FACE DUAL TRAC	7040	P-6
PAC TRAC HARDWARE	7002	

CONTENTS		
PRODUCT	PART #	PAGE
U CHANNEL	7040	P-7
PT CORNER CONNECTOR	3018	
SHELF MOUNT	3021	
SWING OUT TOOLBOARD	PM-1000 + ADD'L MATERIAL	P-8
HORIZONTAL SLIDE OUT TOOLBOARD	HSO-18 OR HSO-24 + ADD'L MATERIAL	
VERTICAL SLIDE OUT TOOLBOARD	VSO-18 OR VSO-24 + ADD'L MATERIAL	
VERTICAL SLIDE OUT (BASE MOUNT)	VSOB-18 OR VSOB-24 + ADD'L MATERIAL	P-9

The PAC TRAC Family of products are designed to provide a unique and versatile mounting surface for tools and equipment.

PAC TRAC boards have special grooves or channels which allow the assembly of tool boards and the mounting of brackets and equipment.

PAC TRAC boards are extruded from 6063-T5 aluminum and available in standard lengths of 50", 70" and 120". Boards are available in width increments of 3-3/4", 5-3/4" and 8-5/8".

The Pac Trac family of extrusion is NFPA 1901 Impact G Force & MIL Grade B certified as a mounting structure for testing tool brackets.



ASSEMBLY METHODS

Assemble tool boards with **Z-Mount** (P/N 7001 and 7001D)

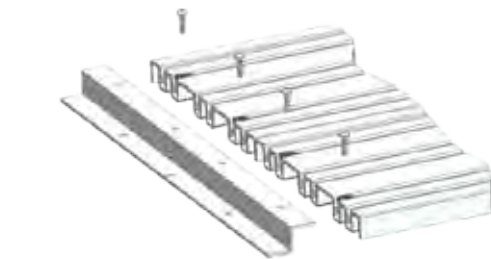

Z & U Channel kits come in pairs AND include hardware. Choose your board type and the number of sections. There is a corresponding frame kit to make your custom toolboard assembly simple!

Assemble double sided tool boards with **U-Channel** (P/N 7009)

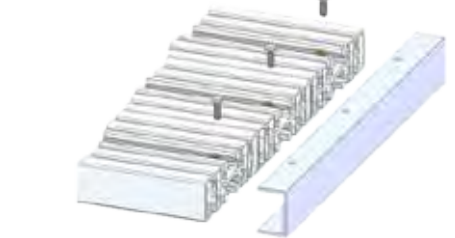

ATTACHMENT METHODS



SCREW MOUNTING WITH Z-MOUNT



TOOLBOARD ASSEMBLIES

BRACKET MOUNTING METHODS

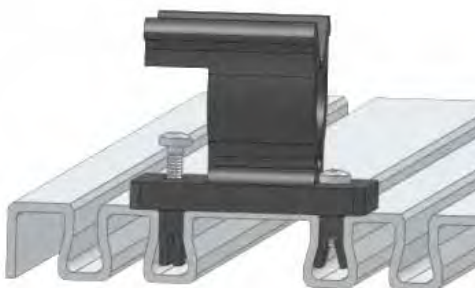

Trac Lok Inserts (P/N 7016)

PAC brackets can be installed without drilling holes. Brackets can be relocated, removed or reoriented easily. Brackets are attached to PAC TRAC products with PAC Trac Lok inserts or optional PAC channel nuts¹. For heavy duty applications use optional Steel Uni-Strut channel nuts¹.



Channel Nuts (P/N 3023 & P/N 3024)

¹ Mini(7050), Dual(7020) & Double Dual Trac (7040) only

PAC organizes your gear. We let your crew run efficiently so you can save lives.

Our professionals will work with your Truck Dealer, Fire Chief, Technician or Truck Committee to develop the layout strategy that meets your needs.

Our products can be installed at the OEM of your choice OR can be installed on your existing truck. PAC supplies to OEMs, Used truck dealers, and aftermarket installers. Get inspired by these actual BEFORE and AFTER photos!

AFTER



BEFORE



AFTER



BEFORE



PAC TRAC



The industry's **original** tool board bracket mounting system.

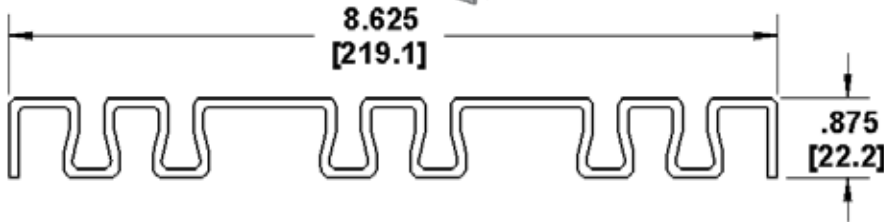
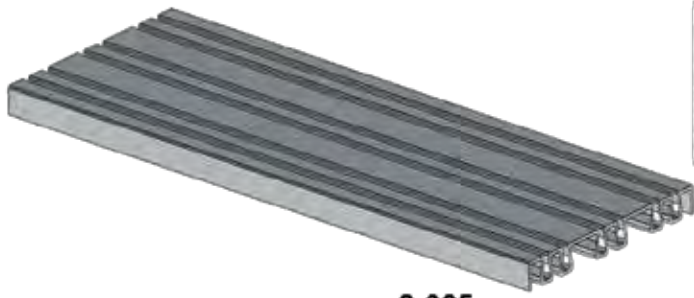

P/N 7000

STD. SIZES	50", 70", 120"
CUSTOM SIZES	up to 120"
Width	8-5/8" (219.1mm)
Height	7/8" (22.2mm)
WT./FT	2.6 lbs.
Assy. Method	Z-Mount J-Mount
Bracket Fasteners	Trac Lok

DUAL TRAC



Similar to the original **PAC TRAC** but adds a Uni-Strut® style center channel for PAC Channel Nuts.

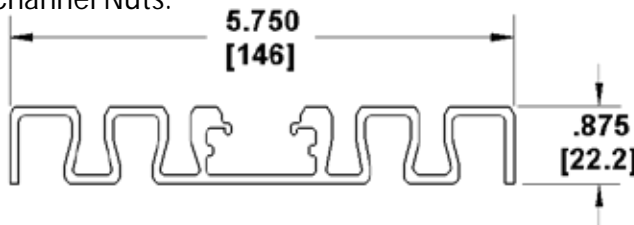

P/N 7020

STD. SIZES	50", 70", 120"
CUSTOM SIZES	up to 120"
Width	5-3/4" (146mm)
Height	7/8" (22.2mm)
WT./FT	1.8 lbs.
Assy. Method	Z-Mount J-Mount
Bracket Fasteners	Trac Lok Channel Nuts

MINI DUAL TRAC



Narrow version of **DUAL TRAC** for use as a single mounting board, an addition to other Pac Trac panels or as a construction member for assemblies.

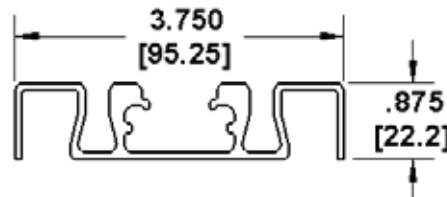

P/N 7050

STD. SIZES	50", 70", 120"
CUSTOM SIZES	up to 120"
Width	3-3/4" (95.2mm)
Height	7/8" (22.2mm)
WT./FT	1.1 lbs.
Assy. Method	P/N 7001-MD-1 P/N 7012-MD-1
Bracket Fasteners	Trac Lok Channel Nut

Z-Mount extrusion is designed for the assembly and mounting of tool board panels made with **Pac Trac** (P/N 7000). Z-Mount uses PAC **Trac Lok** inserts (P/N 7016) and screws for assembly of board sections. Mounting hardware to compartment walls not included.



- 7001 sold individually & includes hardware bag 7008
- 7001-(1-8) **Sold in pairs &** includes hardware bag 7003 (qty 1-8)

PN 7001			
P/N	No. Boards	Length	Qty
7001	N/A	120"	1
7001-1	1	8.625"	2
7001-2	2	17.250"	2
7001-3	3	25.875"	2
7001-4	4	34.500"	2
7001-5	5	43.125"	2
7001-6	6	51.750"	2
7001-7	7	60.375"	2
7001-8	8	69.00"	2
INCLUDES ALL ASSEMBLY HARDWARE			

Z-Mount for Dual Trac is designed for the assembly and mounting of tool board panels made with **Dual Trac** (P/N 7020). Z-Mount for Dual Trac uses PAC **Channel Nuts** (P/N 3024) and screws for assembly of board sections. Mounting hardware to compartment walls not included.

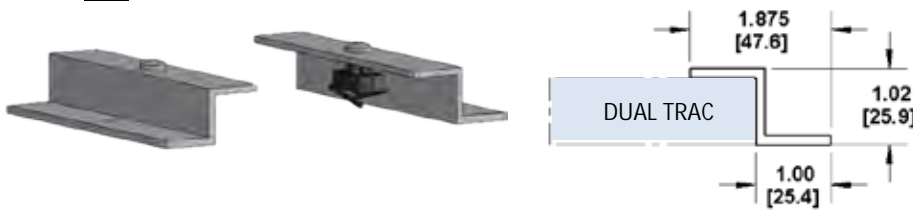

- 7001D sold individually & includes hardware bag 7011
- 7001D-(1-10) **Sold in pairs &** includes hardware bag 7006 (qty 1-10)

PN 7001D			
P/N	No. Boards	Length	Qty
7001D	N/A	120"	1
7001D-1	1	5.75"	2
7001D-2	2	11.50"	2
7001D-3	3	17.25"	2
7001D-4	4	23.00"	2
7001D-5	5	28.75"	2
7001D-6	6	34.50"	2
7001D-7	7	40.25"	2
7001D-8	8	46.00"	2
7001D-9	9	51.75"	2
7001D-10	10	57.50"	2
INCLUDES ALL ASSEMBLY HARDWARE			

Z-Mount for Mini Dual Trac is designed for the mounting of a single board of **Mini Dual Trac** (P/N 7050). Z-Mount for Mini Dual Trac uses PAC **Channel Nuts** (P/N 3024) and screws for assembly of board sections.

Sold in pairs; includes hardware bag 7006

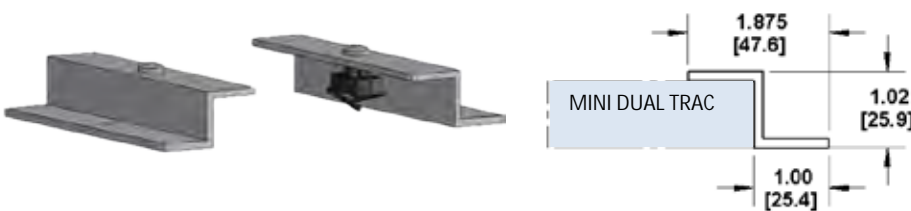

PN 7001-MD-1			
P/N	No. Boards	Length	Qty
7001-MD-1	1	3.75"	2
INCLUDES ALL ASSEMBLY HARDWARE			

P/N 7040

STD. SIZES	50", 70", 120"
CUSTOM SIZES	up to 120"
Width	5-3/4" (146mm)
Height	1-3/4" (44.5mm)
WT./FT	4.0 lbs.
Assy. Method	U-Channel 
Bracket Fasteners	Trac Lok  Channel Nuts 

A double sided mounting board which has all the features of **DUAL TRAC**. Primarily used to create swing out, vertical or partition wall tool boards.

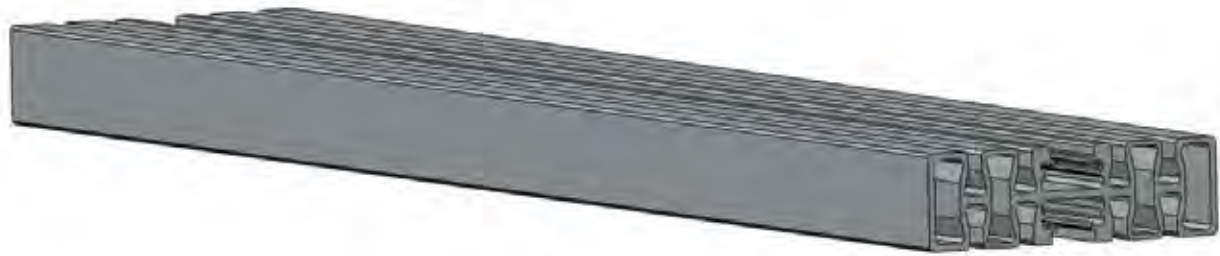
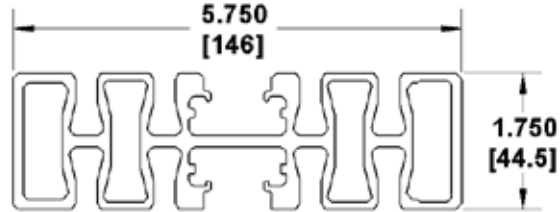

PAC TRAC HARDWARE



Fasteners for Pac Trac products provide a fast reusable method of assembly and mounting.

Patented Trac Lok Inserts expand and contour into grooves in all Pac Trac boards. **NOT FOR USE WITH Tube Trac (P/N 7060).**

Channel nuts locate into the center channel of Dual, Mini and Double Face Pac Trac boards.

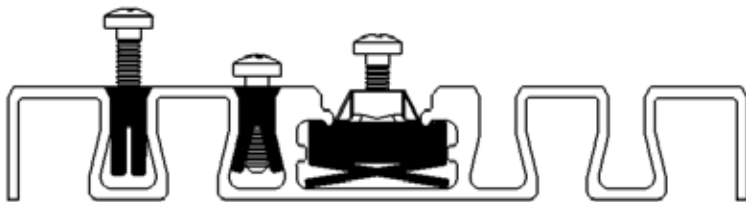
INDIVIDUAL PART NUMBERS LISTED.



P/N	7016	3023	3024
Name	Trac Lok Insert	Channel Nut	Channel Nut
Screw Size	#10-24	#10-24	¼-20
Torque (in-lbs)	15	25	50
Load Rating (lbs.)	150	435	435
			

P/N 7009

P/N	No. Boards	Length	Qty
7009	N/A	120"	1
7009-1	1	5.75"	1
7009-2	2	11.50"	2
7009-3	3	17.25"	2
7009-4	4	23.00"	2
7009-5	5	28.75"	2
7009-6	6	34.50"	2
7009-7	7	40.25"	2
7009-8	8	46.00"	2
7009-9	9	51.75"	2
7009-10	10	57.50"	2

INCLUDES ALL ASSEMBLY HARDWARE

U-Channel designed for the assembly of tool board panels made with **Double Face Dual Trac** (P/N 7040).

U-Channel uses PAC **Channel Nuts** (P/N 2023) and screws for assembly of board sections.

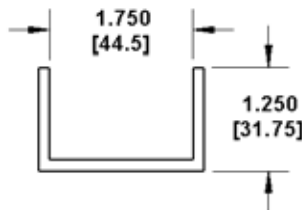

- 7009 sold individually & does not include hardware
- 7009-(1-10) **Sold in pairs &** includes hardware bag 7014 (qty 1-10)



An anodized aluminum right angle connector used to attach and assemble Pac Trac extrusions.

Quickly connects the corners, sides and bottom sections of Pac Trac using **Trac Lok Inserts** (P/N 7016) and screws or Uni-Strut steel **Channel Nuts** (P/N 2023)

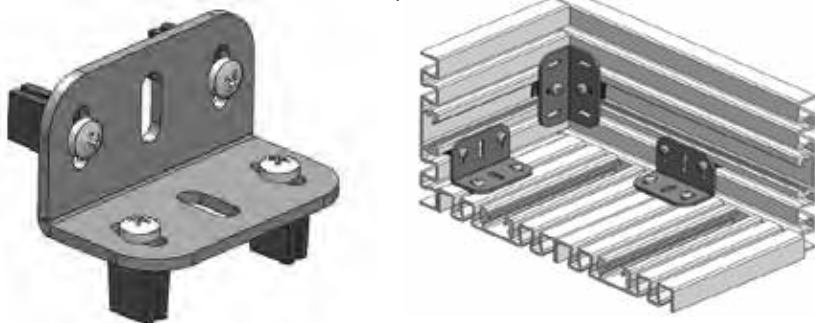

P/N 3018

Material	5052 aluminum
Size	1-1/2" x 2-3/4"
Assembly Fasteners	Trac Lok Channel Nut (optional) 

Includes Assembly Hardware

Pac **Shelf Mount** is molded from durable non-corrosive glass reinforced nylon. Designed exclusively for Pac **Mini** and **Dual Trac** providing a right angle connection for mounting shelves or joining boards together.

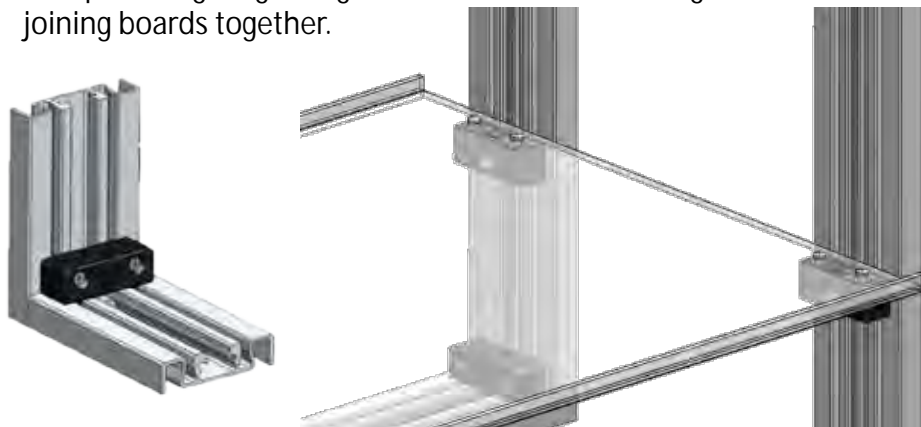

P/N 3021

Material	Nylon
Size	1"x 1-1/8"x3"
Assembly Fasteners	Trac Lok Channel Nut 

Includes Assembly Hardware



SWING OUT TOOLBOARDS



Swing out tool boards are a great way to double your mounting space. Brackets and equipment can be mounted to both sides of the tool board. Multiple configurations create the most efficient use of space and allow better accessibility. Latch closed and open for security.

1,000,000 Tested Cycles Without Failure

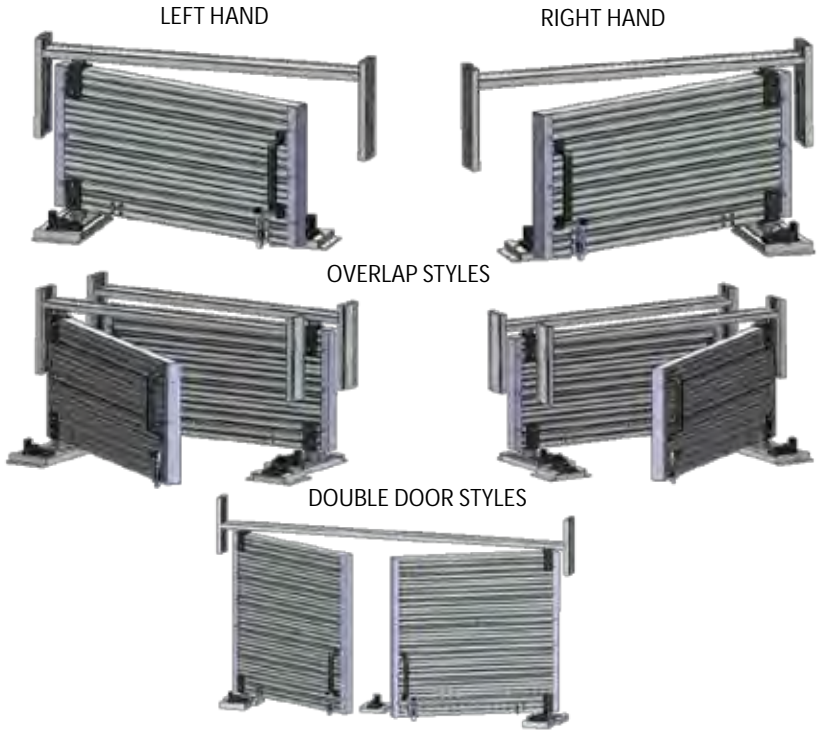

- REQUIRED ITEMS:**
- PM1000
 - PMF KIT as needed
 - 7040 as needed
 - 7009(-1to-8) as needed

Configurations	Single (LH, RH) Double Door Overlap
Consult with technical sales for assistance	
Board Material	P/N 7040 Double Face Dual Trac
Width	Up to 60"
Height	Up to 60"
Assy. Method	U-Channel Z-Mount
Bracket Fasteners	Trac Lok Channel Nut
Includes Assembly Hardware	

HORIZONTAL SLIDE OUT



A low profile full extension slide out tool board that provides easy access to tools and equipment. Locks in and out. Ready for bracket mounting.



FOR ORDERING: BOARD LENGTH CALCULATION IS: OVERALL WIDTH - 2.9"

KIT #	HSO-18	HSO-24
RECOMMENDED WIDTHS CONSULT WITH TECHNICAL SALES FOR ASSISTANCE	Up to 48" wide	Up to 48" wide
BOARD MATERIAL NOT INCLUDED	3 PCS. 7020	4 PCS. 7020
DEPTH REQUIRED	19-1/2" CLOSED	25-1/2" CLOSED
HEIGHT REQUIRED	3-1/2"	
CAPACITY	250 lbs.	
BRACKET FASTENERS	Trac Lok Channel Nut	
Includes Assembly Hardware		

KIT #	VSO-18 (RH or LH)	VSO-24 (RH or LH)
RECOMMENDED HEIGHT <small>CONSULT WITH TECHNICAL SALES FOR ASSISTANCE</small>	Up to 60" high	Up to 60" high
BOARD MATERIAL <small>NOT INCLUDED</small>	3 PCS. 7040	4 PCS. 7040
DEPTH REQUIRED	19-1/2" CLOSED	25-1/2" CLOSED
WIDTH REQUIRED	3-1/2" minimum	
CAPACITY	300 lbs.	
BRACKET FASTENERS	Trac Lok Channel Nut 	
Includes Assembly Hardware		

A full extension slide out double sided tool board that provides easy access to tools and equipment. Locks in and out. Ready for bracket mounting.



NOTE: PLEASE SPECIFY LEFT OR RIGHT HAND OF THE COMPARTMENT WHEN ORDERING!

FOR ORDERING: BOARD LENGTH CALCULATION IS: OVERALL HEIGHT - 2.00"

Depth	18"	24"
Required Kit	VSOB-18	VSOB-24
Recommended Width <small>Consult with technical sales for assistance</small>	Up to 28" WIDE	Up to 34" WIDE
Recommended Height <small>Consult with technical sales for assistance</small>	Up to 30" HIGH	Up to 40" HIGH
Board Material	3 PCS. 7020 (Horiz) 3 PCS. 7040 (Vert.)	4 PCS. 7020 (Horiz) 4 PCS. 7040 (Vert.)
Depth Required	19-1/2"	25-1/2"
Capacity	300 lbs.	
Bracket Fasteners	Trac Lok Channel Nut 	
Includes Assembly Hardware		

A full extension slide out double sided tool board that provides easy access to tools and equipment. Locks in and out. Ready for bracket mounting. Mounts to floor or base only.

FOR ORDERING:

HORIZONTAL BOARD LENGTH CALCULATION IS: OVERALL WIDTH - 2.9"

VERTICAL BOARD LENGTH CALCULATION IS: OVERALL HEIGHT - 3.25"

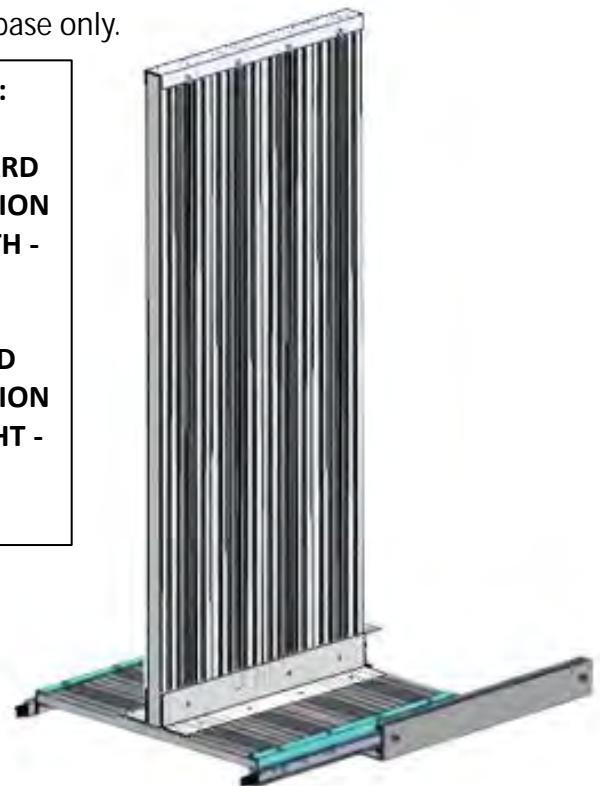



VISIT US OR MAIL US AT:

**PERFORMANCE ADVANTAGE CO.
10 CENTRAL AVE.
LANCASTER, NY 14086**

PAC is located 10 minutes from the City of Buffalo in Lancaster, NY. Call and make an appointment for a company tour. See how our huge "Classroom", displaying many real-world tool mounting examples, will inspire your department.



Our building houses the Greater Lancaster Fire Fighting Museum. We are dedicated to preserving the Fire History of Lancaster, NY. The newest exhibits feature two companies from Lancaster, NY; fire fighting innovators - Young Fire Equipment & Scott Aviation! Jerry would be glad to give a tour! Email Jerry@pactoolmounts.com.

The museum also sponsors the hugely popular Lancaster Christmas Fire Truck parade.



PAC was founded on the experience of Dick Young, former President of Young Fire Equipment. His experience and innovation in the Fire Truck market is what makes PAC Tool Mounts superior. Our knowledgeable team has lifetimes of experience in the Industry. Our passion shows in our proven designs.





PERFORMANCE ADVANTAGE CO.

TRAINING IN THE CLASSROOM



Join us for a “Live” Video Conference. Let PAC show you how our Products can serve your organization!

Follow These 3 Easy Steps To Set-up Your Web Meeting:



STEP #1

Contact PAC For A Designated Day & Time To Connect For Your “Live” Video Conference.

Contact Tom @ 888-514-0083

STEP #2

PAC Will E-mail Directly To You , A Link For Connecting To Your Presentation Via “gotomeeting”.

STEP #3

At the Designated Day & Time, All you have to “CLICK” on that active link and join your pre-arranged meeting.

PAC Can Accommodate Up To 25 Individual Participants On Any Single Presentation

Fire & Rescue - Law Enforcement - Military - EMS - Utility - Towing



Contact Performance Advantage Company For Your
Tool Mounting Solutions:



PERFORMANCE ADVANTAGE COMPANY
10 CENTRAL AVENUE
LANCASTER, NY 14086

DISTRIBUTED BY

PHONE: (716) 683-7413 FAX: (716) 683-6578
PHONE TOLL FREE: 1-888-514-0083
FAX TOLL FREE: 1-877-741-9206
WEB: WWW.PACTOOLMOUNTS.COM
EMAIL: INFO@PACTOOLMOUNTS.COM

