

REV	DESCRIPTION	DATE	APPR
B	UPDATED WITH S/ASSY'S	9/30/13	

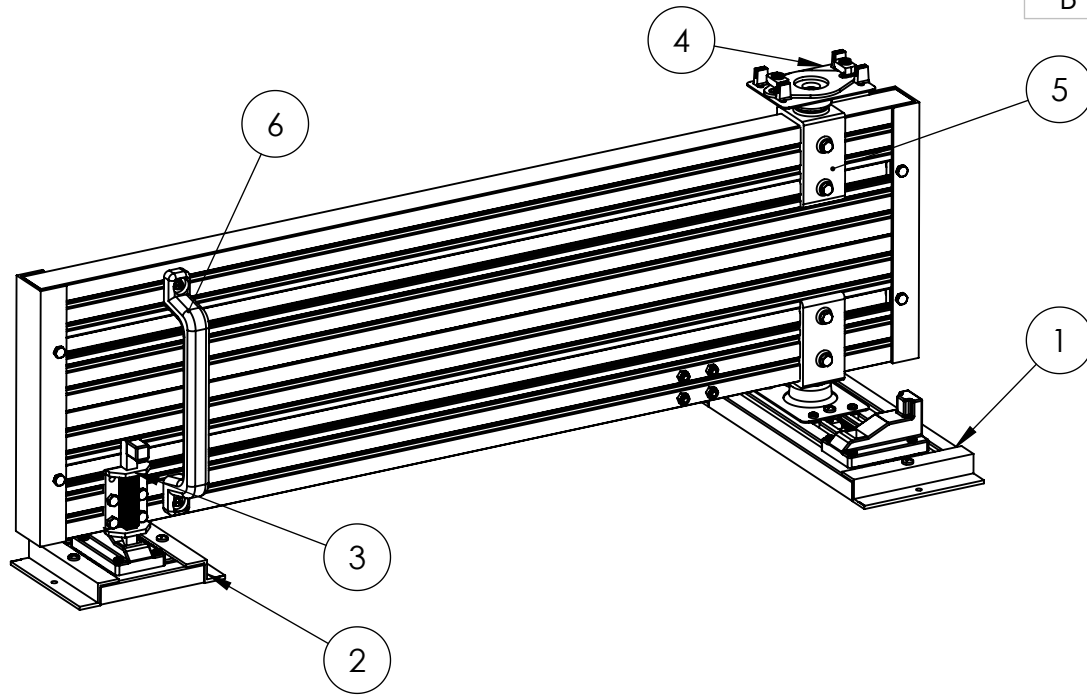

6	HANDLE-PT	HANDLE ASSEMBLY FOR PAC TRAC	1
5	PM1000-9205	PIVOT MOUNT KIT	1
4	PM 1000-9204	PIVOT BEARING PLATE KIT	1
3	PM 1000-9203	SLAM LATCHES	1
2	PM 1000-9202	PIVOT MOUNT KIT	1
1	PM 1000-9201	PIVOT MOUNT BASE ASSEMBLY	1
ITEM NO.	PAC P/N	PART NAME	QTY.

NOTES:

FOR USE WITH DUAL TRAC
SWING OUT TOOLBOARDS

SEE INS-SOT DOCUMENT
FOR ASSEMBLY & INSTALLATION
INSTRUCTIONS

**Performance
Advantage
Company**



TOLERANCES UNLESS OTHERWISE SPECIFIED

.X= ±.03
.XX= ±.010
.XXX= ±.005
.XXXX= ±0.0005
ANGLES ±0.5 °
FRACTIONAL ±1/64

THIRD ANGLE
PROJECTION



COLOR

	NAME	DATE
DRAWN BY		
APPR. BY		
MFG BY		
MFG. P/N		
ENG APPR.		
MATERIAL		
ALT. MATERIAL		
FINISH		

THE INFORMATION CONTAINED IN THIS DRAWING IS THE SOLE
PROPERTY OF **PERFORMANCE ADVANTAGE CO.** ANY
REPRODUCTION IN PART OR AS A WHOLE WITHOUT THE WRITTEN
PERMISSION OF PERFORMANCE ADVANTAGE CO. IS PROHIBITED.

TITLE:

PIVOT MOUNT ASSEMBLY

PART NUMBER

PM-1000

REV

B

SCALE: 1:8

SHEET 1 OF 2

REV	DESCRIPTION	DATE	APPR

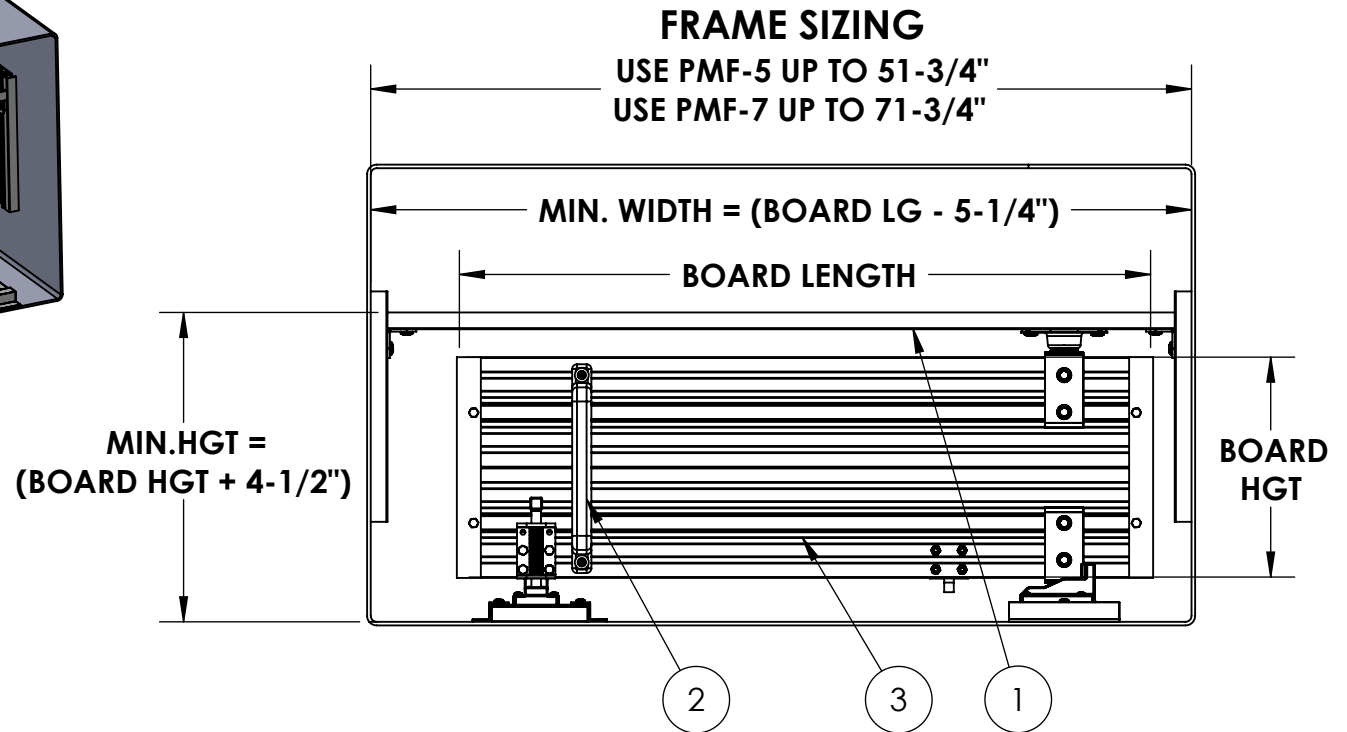
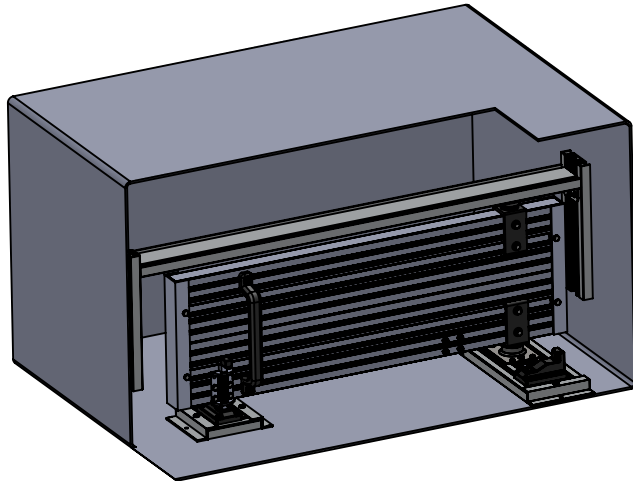

3	TO SUIT	7040 DOUBLE FACE DUAL TRAC BOARD	1
2	PM-1000	PIVOT MOUNT ASSEMBLY	1
1	PMF-5, -7	PIVOT MOUNT FRAME	1
ITEM NO.	PAC P/N	PART NAME	QTY

NOTES:

TOOLBOARD HEIGHTS IN 5-3/4" INCREMENTS.
 TOOLBOARD WIDTHS ANY SIZE UP TO 60"

Performance
 Advantage
 Company



TOLERANCES UNLESS OTHERWISE SPECIFIED

.X = ± .03
 .XX = ± .010
 .XXX = ± .005
 .XXXX = ± 0.0005
 ANGLES ± 0.5 °
 FRACTIONAL ± 1/64

THIRD ANGLE PROJECTION



COLOR

NAME	DATE
DRAWN BY	
APPR. BY	
MFG BY	
MFG. P/N	
ENG APPR.	
MATERIAL	
ALT. MATERIAL	
FINISH	

THE INFORMATION CONTAINED IN THIS DRAWING IS THE SOLE PROPERTY OF PERFORMANCE ADVANTAGE CO. ANY REPRODUCTION IN PART OR AS A WHOLE WITHOUT THE WRITTEN PERMISSION OF PERFORMANCE ADVANTAGE CO. IS PROHIBITED.

TITLE:

TYPICAL SWING OUT TOOLBOARD

PART NUMBER

SOT-2 X ___" WIDE

REV

SCALE: 1:10

SHEET 2 OF 2